

EXCLUSIVE BRAND-NEW RELEASED SUITES PRICE LIST\*  
TOWER SUITES

MODEL	BED TYPE	APPROX SIZE	VIEW	BATHROOM	EXTERIOR*	STARTING FLOORS	VIP PRICE STARTING FROM*
A-271	Studio	271	W	1	84*	19	\$440,900
A-311	Studio	315	NE	1	155*	37	\$478,900
A-367	Studio	367	S	1	60*	16	\$487,900
B-461	1B+M	461	S	1	109*	16	\$599,900
C-479	1B+D	479	N	1	116*	23	\$624,900
C-494	1B+D	494	NE	1	62*	12	\$643,900
C-493	1B+D	493	N	1	39*	47	\$658,900
C-474	1B+F	474	S	1	92*	18	\$659,900
C-538	1B+F	538	W	1	114*	12	\$673,900
C-571	1B+F	571	W	1.5	114*	39	\$716,900
D-693	2B	693	NW	2	172*	8	\$850,900
D2-684	2B	684	SE	2	277*	9	\$856,900
D-675	2B+M	675	E	2	114*	37	\$845,900
D1-718	2B+M	718	SW	2	273*	8	\$880,900
D-670	2B+M	672	SW	2	253*	16	\$882,900
E1-628	2B+D	628	S	2	114*	8	\$824,900
E2-628	2B+D	628	S	2	105*	8	\$824,900
E-741	2B+F	741	E	2	95*	41	\$883,900

\*Please speak to a Sales Representative for more details

**Ceiling heights range from approximately 9'8 - 13'3**

**\*ceiling heights premiums apply speak to sales representative for details**

ALL CHEQUES TO BE MADE PAYABLE TO: Harris Sheaffer LLP In Trust

EXTENDED DEPOSIT STRUCTURE	PARKING \$60,000	EV PARKING \$70,000	MAINTENANCE FEE TOWER: Approx. \$0.69 per sq ft
\$10,000 bank draft on Signing Balance of 5% in 30 days 5% on May 1, 2026 2.5% in 760 days 2.5% in 1125 days 5% on Occupancy	Parking currently available for 1B+D units, 494 sq ft and larger. All other units will be waitlisted		(Excluding utilities, Rogers Bulk Internet and Rogers Smart Community package)
CANADIAN NON-RESIDENT DEPOSIT STRUCTURE	with LOCKER \$7,000		PARKING MAINTENANCE \$49.95/month
\$10,000 bank draft on Signing Balance of 5% in 30 days 5% in 180 days 5% in 300 days 5% in 395 days 5% in 760 days 5% in 1125 days 5% on Occupancy	Lockers currently available for units 571 sq ft and larger. All other units will be waitlisted		
	OCCUPANCY COMMENCING Early 2029		LOCKER MAINTENANCE \$22.95/month

**SUITE FEATURES**

M6 will feature an array of stunning interior finishes including pre-finished vinyl flooring in all living areas & bedrooms, ceiling height of approximately 9 ft. The kitchens feature Cecconi Simone custom designed cabinetry as well as quartz countertops, porcelain backsplashes, under-mount stainless steel sinks with single lever chrome faucets with pull-down spray head. All suites will also feature the following appliances: 24” integrated fridge, 24” integrated dishwasher and 24” stainless steel slide in-range and stainless-steel microwave.

**BUILDING FEATURES**

A fusion of free-flowing curves and dramatic angles that converge in spectacular fashion.

M6 is a 57-storey metal and glass tower with 6-storey podium designed by Hariri Pontarini. Interiors designed by Cecconi Simone Inc. Six elevators for residents’ convenience. A luxurious lobby with 24hr. concierge. Residents and their guests can enjoy M6’s amenities such as outdoor pool and hot tub with sun deck. Outdoor dining areas with BBQs and Outdoor TV lounge. Experience shower and steam rooms and saunas. Fitness centre, virtual fitness studio, spin studio and yoga studio. Multipurpose sports court for basketball, pickleball and badminton. Putting green and bocce courts. Dining Room and Event Space. Piano lounge, theatre room, TV lounge and games room. Shared workspace. Outdoor kids’ play area with splashpad, and kids’ play area and craft room.

# CLIENT INCENTIVES

## LIMITED TIME OFFER

### Free Assignment

Plus legal fees, admin fees & HST\*  
(Value of \$10,000)

### Free Right to Lease During Interim Occupancy

Plus legal fees, admin fees & HST\*  
(Value of \$5,000)

### Capped Development Charges and Levies

1B+F and Smaller - ~~\$18,000~~ \$16,500  
2B and Larger - ~~\$20,000~~ \$18,500

### EXTENDED DEPOSIT STRUCTURE

\$10,000 Bank Draft on Signing	} 5% in 2025	
Balance of 5% in 30 days		
5% on May 1, 2026		5% in 2026
2.5% in 760 days		2.5% in 2027
2.5% in 1125 days		2.5% in 2028
5% on Occupancy		

### Parking

~~\$70,000~~ \$60,000

Parking currently available for 1B+D units, 494 sq ft and larger. All other units will be waitlisted.

### EV Parking

~~\$80,000~~ \$70,000

Available for a limited time. Restrictions apply afterwards.

### Locker

~~\$8,000~~ \$7,000

Lockers currently available for units 571 sq ft and larger. All other units will be waitlisted.



## STUDIO + 1 BATH

**INTERIOR: 271 SF**  
**EXTERIOR: 85 SF\***

\*Balcony square footage and layout correspond to this floor only. To find the actual balcony layout, please refer to the corresponding floor and unit number indicated on the Keyplan sheets.

# A-271



UNIT 08 ON FLOORS: 08-14 - FLOOR 11 KEYPLAN SHOWN

UNIT 09 ON FLOORS: 15-35 - FLOOR 15 KEYPLAN SHOWN



The Purchaser acknowledges and agrees that he/she has reviewed the key plan for the level on which the Unit is located, including, without limitation, the anticipated design, configuration and/or access point(s) of any exclusive use common area balcony or terrace appurtenant to the specific Unit being purchased, which design, configuration, and/or access point(s) may vary from unit to unit and/or level to level. The Purchaser acknowledges and agrees that the glass panels appurtenant to the Unit may be spandrel glass, vision glass, glazed glass, and/or such other glass as the Vendor may determine, in its sole and absolute discretion, based on the final architectural design of the building and the energy model report for the building. Exterior areas may contain architectural elements not shown on plans. Sizes and specifications are subject to change without notice. E. + O.E. March, 2024

## STUDIO + 1 BATH

**INTERIOR: 311 SF**  
**EXTERIOR: 156 SF\***

\*Balcony square footage and layout correspond to this floor only. To find the actual balcony layout, please refer to the corresponding floor and unit number indicated on the Keyplan sheets.

# A-311

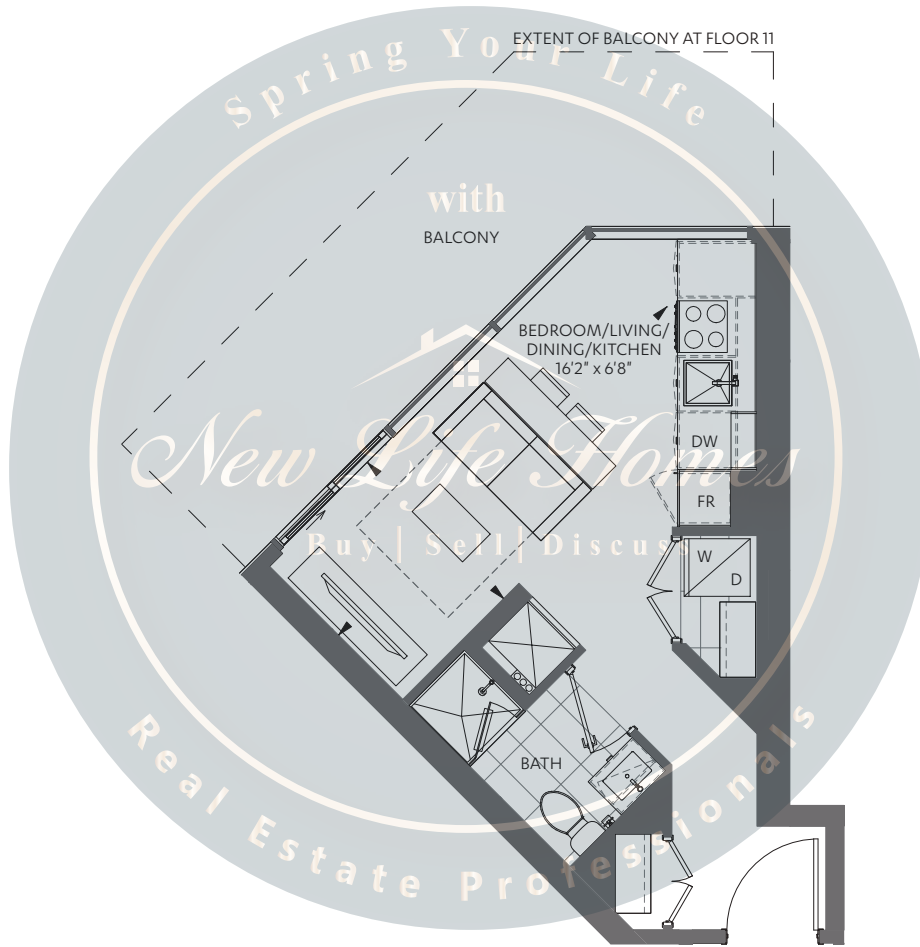

UNIT 15 ON FLOORS: 08-14 - FLOOR 11 KEYPLAN SHOWN

UNIT 16 ON FLOORS: 15-35 & 37-52 - FLOOR 15 KEYPLAN SHOWN

UNIT 14 ON FLOORS: 36 & 53-56 - FLOOR 36 KEYPLAN SHOWN

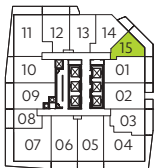

FLOOR 11



FLOOR 15



FLOOR 36



The Purchaser acknowledges and agrees that he/she has reviewed the key plan for the level on which the Unit is located, including, without limitation, the anticipated design, configuration and/or access point(s) of any exclusive use common area balcony or terrace appurtenant to the specific Unit being purchased, which design, configuration, and/or access point(s) may vary from unit to unit and/or level to level. The Purchaser acknowledges and agrees that the glass panels appurtenant to the Unit may be spandrel glass, vision glass, glazed glass, and/or such other glass as the Vendor may determine, in its sole and absolute discretion, based on the final architectural design of the building and the energy model report for the building. Exterior areas may contain architectural elements not shown on plans. Sizes and specifications are subject to change without notice. E. + O.E. March, 2024

## STUDIO + 1 BATH

**INTERIOR: 367 SF**  
**EXTERIOR: 60 SF\***

\*Balcony square footage and layout correspond to this floor only. To find the actual balcony layout, please refer to the corresponding floor and unit number indicated on the Keyplan sheets.

# A-367

EXTENT OF BALCONY AT FLOOR 15

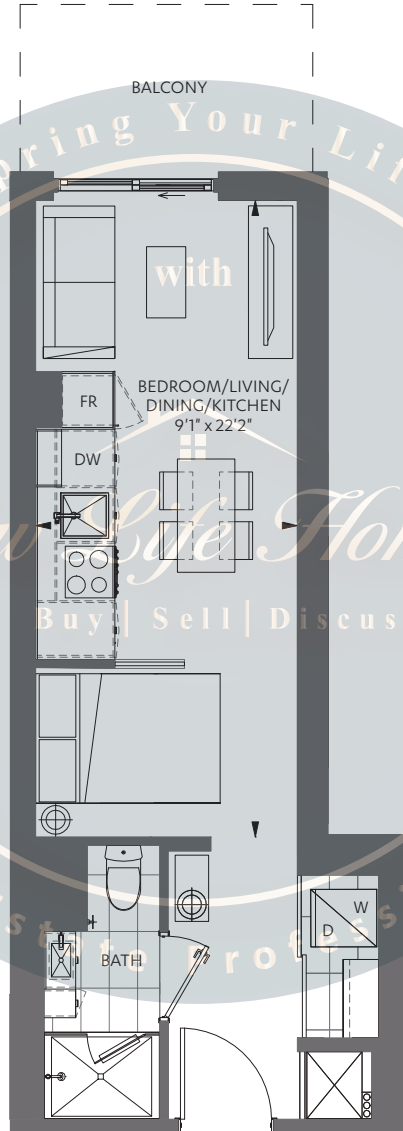

UNIT 05 ON FLOORS: 15-35 & 37-52  
FLOOR 15 KEYPLAN SHOWN

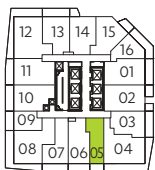

FLOOR 15



FLOOR 36



The Purchaser acknowledges and agrees that he/she has reviewed the key plan for the level on which the Unit is located, including, without limitation, the anticipated design, configuration and/or access point(s) of any exclusive use common area balcony or terrace appurtenant to the specific Unit being purchased, which design, configuration, and/or access point(s) may vary from unit to unit and/or level to level. The Purchaser acknowledges and agrees that the glass panels appurtenant to the Unit may be spandrel glass, vision glass, glazed glass, and/or such other glass as the Vendor may determine, in its sole and absolute discretion, based on the final architectural design of the building and the energy model report for the building. Exterior areas may contain architectural elements not shown on plans. Sizes and specifications are subject to change without notice. E. + O.E. March, 2024

# B-461

1 BED + MEDIA + 1 BATH

**INTERIOR: 461 SF**  
**EXTERIOR: 109 SF\***

\*Balcony square footage and layout correspond to this floor only. To find the actual balcony layout, please refer to the corresponding floor and unit number indicated on the Keyplan sheets.

EXTENT OF BALCONY AT FLOOR 15

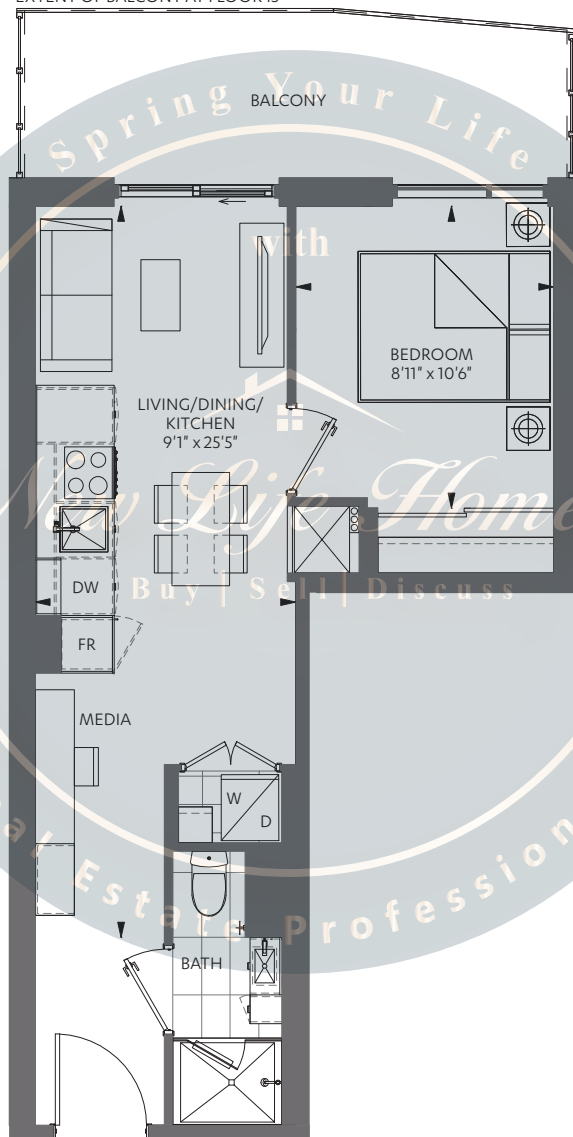

UNIT 07 ON FLOORS: 15-35 & 37-52  
 FLOOR 15 KEYPLAN SHOWN



FLOOR 15



FLOOR 36



The Purchaser acknowledges and agrees that he/she has reviewed the key plan for the level on which the Unit is located, including, without limitation, the anticipated design, configuration and/or access point(s) of any exclusive use common area balcony or terrace appurtenant to the specific Unit being purchased, which design, configuration, and/or access point(s) may vary from unit to unit and/or level to level. The Purchaser acknowledges and agrees that the glass panels appurtenant to the Unit may be spandrel glass, vision glass, glazed glass, and/or such other glass as the Vendor may determine, in its sole and absolute discretion, based on the final architectural design of the building and the energy model report for the building. Exterior areas may contain architectural elements not shown on plans. Sizes and specifications are subject to change without notice. E. + O.E. March, 2024

1 BED + DEN + 1 BATH

**INTERIOR: 479 SF**  
**EXTERIOR: 118 SF\***

\*Balcony square footage and layout correspond to this floor only. To find the actual balcony layout, please refer to the corresponding floor and unit number indicated on the Keyplan sheets.

# G-479

EXTENT OF BALCONY AT FLOOR 11

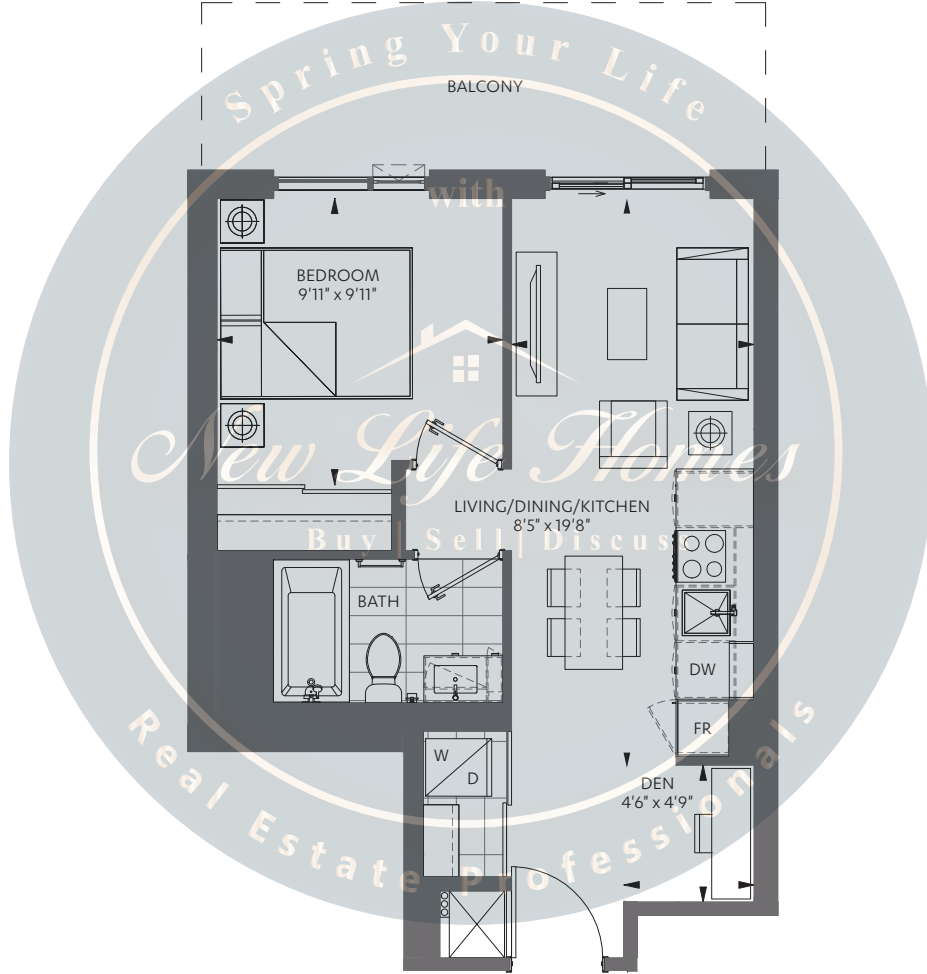

UNIT 12 ON FLOORS: 08-14 - FLOOR 11 KEYPLAN SHOWN

UNIT 13 ON FLOORS: 15-35 & 37-52 - FLOOR 15 KEYPLAN SHOWN

UNIT 11 ON FLOORS: 36 & 53-56 - FLOOR 36 KEYPLAN SHOWN

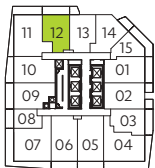

FLOOR 11



FLOOR 15



FLOOR 36



The Purchaser acknowledges and agrees that he/she has reviewed the key plan for the level on which the Unit is located, including, without limitation, the anticipated design, configuration and/or access point(s) of any exclusive use common area balcony or terrace appurtenant to the specific Unit being purchased, which design, configuration, and/or access point(s) may vary from unit to unit and/or level to level. The Purchaser acknowledges and agrees that the glass panels appurtenant to the Unit may be spandrel glass, vision glass, glazed glass, and/or such other glass as the Vendor may determine, in its sole and absolute discretion, based on the final architectural design of the building and the energy model report for the building. Exterior areas may contain architectural elements not shown on plans. Sizes and specifications are subject to change without notice. E. + O.E. March, 2024

1 BED + DEN + 1 BATH

**INTERIOR: 494 SF**  
**EXTERIOR: 63 SF\***

\*Balcony square footage and layout correspond to this floor only. To find the actual balcony layout, please refer to the corresponding floor and unit number indicated on the Keyplan sheets.

# G-494



UNIT 14 ON FLOORS: 10-14 - FLOOR 11 KEYPLAN SHOWN

UNIT 15 ON FLOORS: 15-35 & 37-52 - FLOOR 15 KEYPLAN SHOWN

UNIT 13 ON FLOORS: 36 & 53-56 - FLOOR 36 KEYPLAN SHOWN



FLOOR 11



FLOOR 15



FLOOR 36



The Purchaser acknowledges and agrees that he/she has reviewed the key plan for the level on which the Unit is located, including, without limitation, the anticipated design, configuration and/or access point(s) of any exclusive use common area balcony or terrace appurtenant to the specific Unit being purchased, which design, configuration, and/or access point(s) may vary from unit to unit and/or level to level. The Purchaser acknowledges and agrees that the glass panels appurtenant to the Unit may be spandrel glass, vision glass, glazed glass, and/or such other glass as the Vendor may determine, in its sole and absolute discretion, based on the final architectural design of the building and the energy model report for the building. Exterior areas may contain architectural elements not shown on plans. Sizes and specifications are subject to change without notice. E. + O.E. March, 2024

1 BED + DEN + 1 BATH

INTERIOR: 493 SF

EXTERIOR: 40 SF\*

\*Balcony square footage and layout correspond to this floor only. To find the actual balcony layout, please refer to the corresponding floor and unit number indicated on the Keyplan sheets.

# G-493

EXTENT OF BALCONY AT FLOOR 11  
(NO BALCONY AT UNITS 813 & 913)

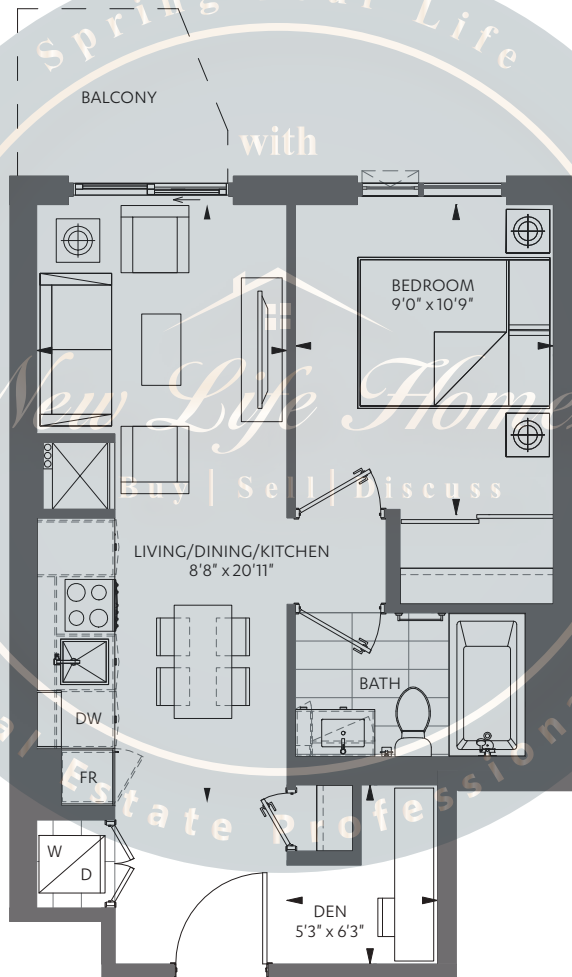

UNIT 13 ON FLOORS: 08-14 - FLOOR 11 KEYPLAN SHOWN

UNIT 14 ON FLOORS: 15-35 & 37-52 - FLOOR 15 KEYPLAN SHOWN

UNIT 12 ON FLOORS: 36 & 53-56 - FLOOR 36 KEYPLAN SHOWN

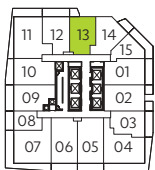

FLOOR 11



FLOOR 15

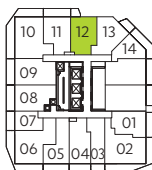

FLOOR 36



The Purchaser acknowledges and agrees that he/she has reviewed the key plan for the level on which the Unit is located, including, without limitation, the anticipated design, configuration and/or access point(s) of any exclusive use common area balcony or terrace appurtenant to the specific Unit being purchased, which design, configuration, and/or access point(s) may vary from unit to unit and/or level to level. The Purchaser acknowledges and agrees that the glass panels appurtenant to the Unit may be spandrel glass, vision glass, glazed glass, and/or such other glass as the Vendor may determine, in its sole and absolute discretion, based on the final architectural design of the building and the energy model report for the building. Exterior areas may contain architectural elements not shown on plans. Sizes and specifications are subject to change without notice. E. + O.E. March, 2024



1 BED + 1 FLEX + 1 BATH

INTERIOR: 474 SF  
EXTERIOR: 92 SF\*

\*Balcony square footage and layout correspond to this floor only. To find the actual balcony layout, please refer to the corresponding floor and unit number indicated on the Keyplan sheets.

G-474

EXTENT OF BALCONY AT FLOOR 15

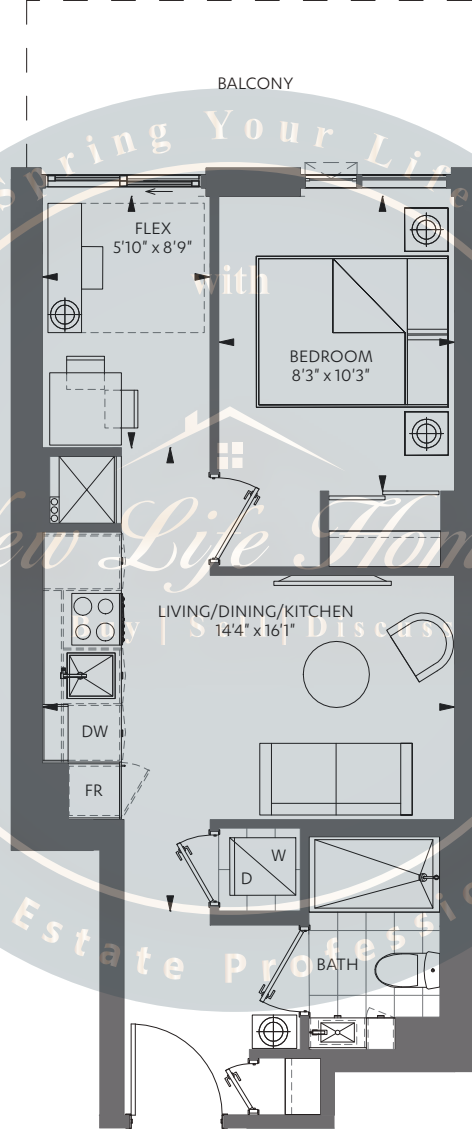

UNIT 06 ON FLOORS: 15-35 & 37-52  
FLOOR 15 KEYPLAN SHOWN

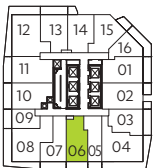

FLOOR 15



FLOOR 36



The Purchaser acknowledges and agrees that he/she has reviewed the key plan for the level on which the Unit is located, including, without limitation, the anticipated design, configuration and/or access point(s) of any exclusive use common area balcony or terrace appurtenant to the specific Unit being purchased, which design, configuration, and/or access point(s) may vary from unit to unit and/or level to level. The Purchaser acknowledges and agrees that the glass panels appurtenant to the Unit may be spandrel glass, vision glass, glazed glass, and/or such other glass as the Vendor may determine, in its sole and absolute discretion, based on the final architectural design of the building and the energy model report for the building. Exterior areas may contain architectural elements not shown on plans. Sizes and specifications are subject to change without notice. E. + O.E. March, 2024

1 BED + FLEX + 1 BATH

INTERIOR: 538 SF  
EXTERIOR: 115 SF\*

\*Balcony square footage and layout correspond to this floor only. To find the actual balcony layout, please refer to the corresponding floor and unit number indicated on the Keyplan sheets.

# G-538

EXTENT OF BALCONY AT FLOOR 11

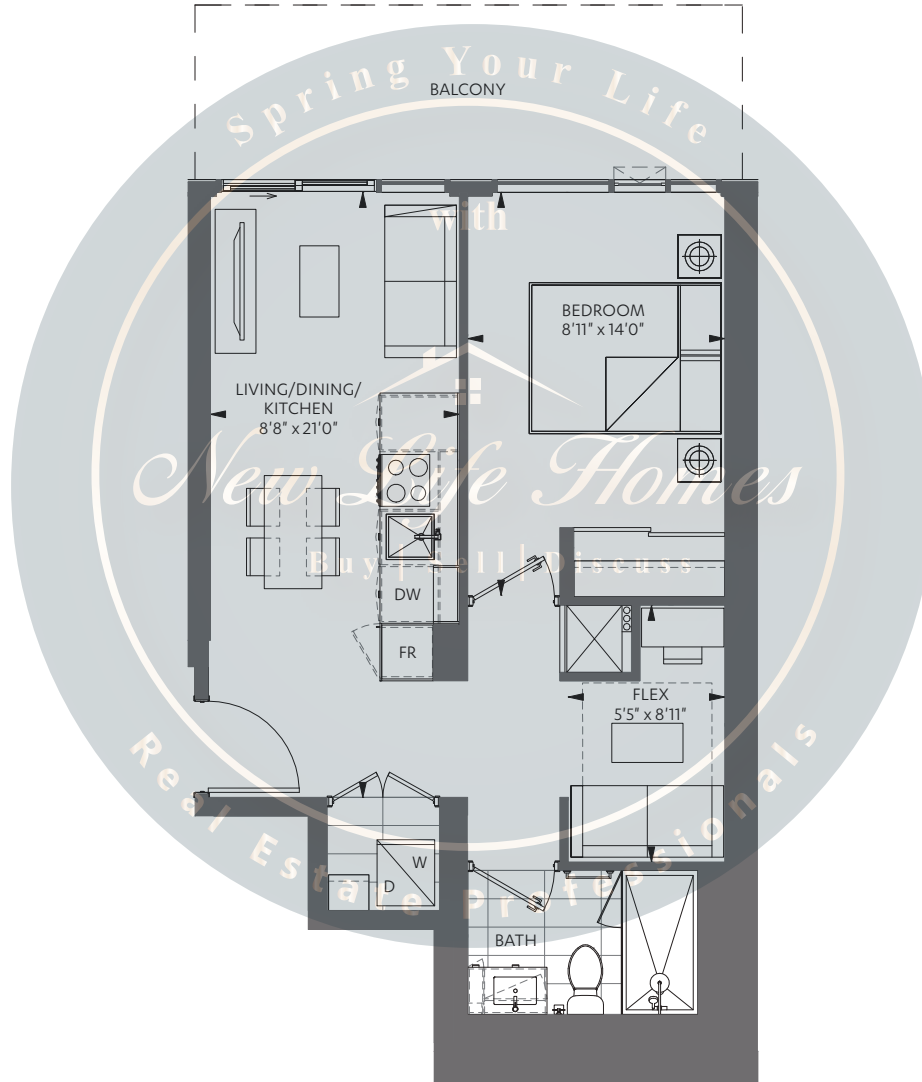

UNIT 09 ON FLOORS: 08-14 - FLOOR 11 KEYPLAN SHOWN

UNIT 10 ON FLOORS: 15-35 & 37-52 - FLOOR 15 KEYPLAN SHOWN

UNIT 08 ON FLOORS: 36 & 53-56 - FLOOR 36 KEYPLAN SHOWN



FLOOR 11



FLOOR 15



FLOOR 36



The Purchaser acknowledges and agrees that he/she has reviewed the key plan for the level on which the Unit is located, including, without limitation, the anticipated design, configuration and/or access point(s) of any exclusive use common area balcony or terrace appurtenant to the specific Unit being purchased, which design, configuration, and/or access point(s) may vary from unit to unit and/or level to level. The Purchaser acknowledges and agrees that the glass panels appurtenant to the Unit may be spandrel glass, vision glass, glazed glass, and/or such other glass as the Vendor may determine, in its sole and absolute discretion, based on the final architectural design of the building and the energy model report for the building. Exterior areas may contain architectural elements not shown on plans. Sizes and specifications are subject to change without notice. E. + O.E. March, 2024

1 BED + FLEX + 1 BATH (BF)

INTERIOR: 571 SF  
EXTERIOR: 104 SF\*

\*Balcony square footage and layout correspond to this floor only. To find the actual balcony layout, please refer to the corresponding floor and unit number indicated on the Keyplan sheets.

G-571

EXTENT OF BALCONY AT FLOOR 11

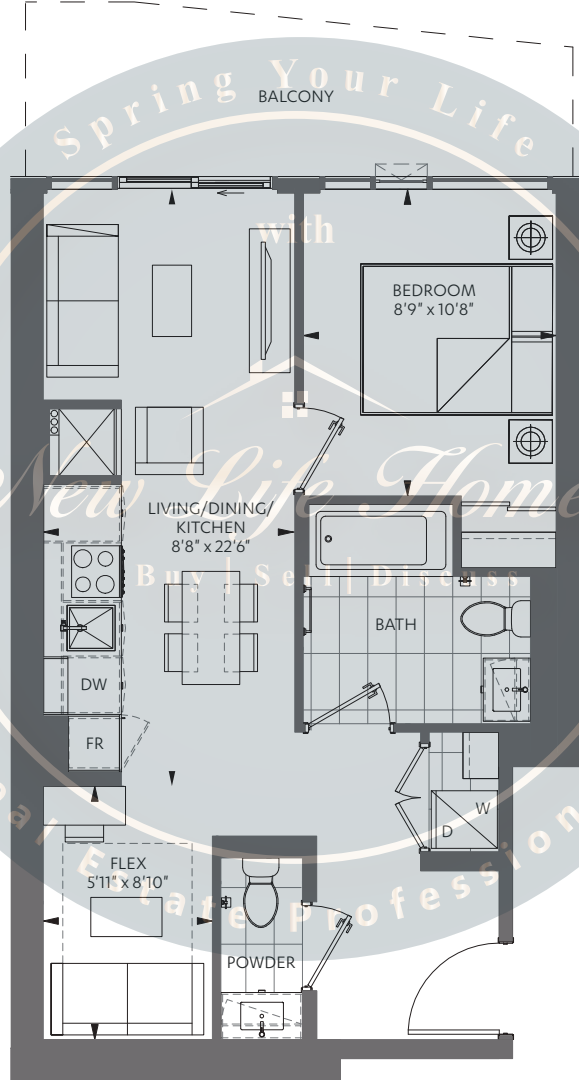

UNIT 10 ON FLOORS: 08-14 - FLOOR 11 KEYPLAN SHOWN

UNIT 11 ON FLOORS: 15-35 & 37-52 - FLOOR 15 KEYPLAN SHOWN

UNIT 09 ON FLOORS: 36 & 53-56 - FLOOR 36 KEYPLAN SHOWN



FLOOR 11



FLOOR 15



FLOOR 36



The Purchaser acknowledges and agrees that he/she has reviewed the key plan for the level on which the Unit is located, including, without limitation, the anticipated design, configuration and/or access point(s) of any exclusive use common area balcony or terrace appurtenant to the specific Unit being purchased, which design, configuration, and/or access point(s) may vary from unit to unit and/or level to level. The Purchaser acknowledges and agrees that the glass panels appurtenant to the Unit may be spandrel glass, vision glass, glazed glass, and/or such other glass as the Vendor may determine, in its sole and absolute discretion, based on the final architectural design of the building and the energy model report for the building. Exterior areas may contain architectural elements not shown on plans. Sizes and specifications are subject to change without notice. E. + O.E. March, 2024

2 BED + 2 BATH (BF)

INTERIOR: 693 SF  
EXTERIOR: 219 SF\*

\*Balcony square footage and layout correspond to this floor only. To find the actual balcony layout, please refer to the corresponding floor and unit number indicated on the Keyplan sheets.

D-693

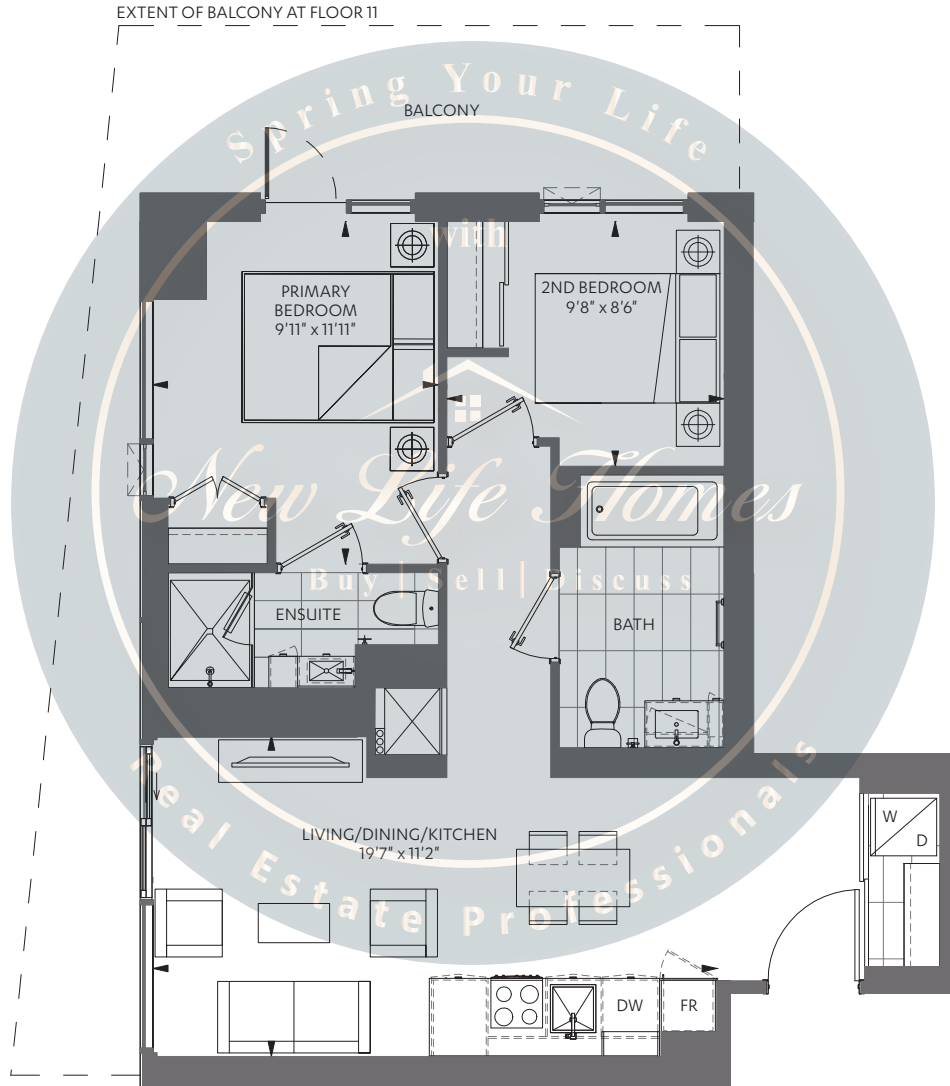

UNIT 11 ON FLOORS: 08-14 - FLOOR 11 KEYPLAN SHOWN

UNIT 12 ON FLOORS: 15-35 & 37-52 - FLOOR 15 KEYPLAN SHOWN

UNIT 10 ON FLOORS: 36 & 53-56 - FLOOR 36 KEYPLAN SHOWN



FLOOR 11



FLOOR 15



FLOOR 36



The Purchaser acknowledges and agrees that he/she has reviewed the key plan for the level on which the Unit is located, including, without limitation, the anticipated design, configuration and/or access point(s) of any exclusive use common area balcony or terrace appurtenant to the specific Unit being purchased, which design, configuration, and/or access point(s) may vary from unit to unit and/or level to level. The Purchaser acknowledges and agrees that the glass panels appurtenant to the Unit may be spandrel glass, vision glass, glazed glass, and/or such other glass as the Vendor may determine, in its sole and absolute discretion, based on the final architectural design of the building and the energy model report for the building. Exterior areas may contain architectural elements not shown on plans. Sizes and specifications are subject to change without notice. E. + O.E. March, 2024

2 BED + 2 BATH

INTERIOR: 684 SF  
EXTERIOR: 237 SF\*

\*Balcony square footage and layout correspond to this floor only. To find the actual balcony layout, please refer to the corresponding floor and unit number indicated on the Keyplan sheets.

# D2-684

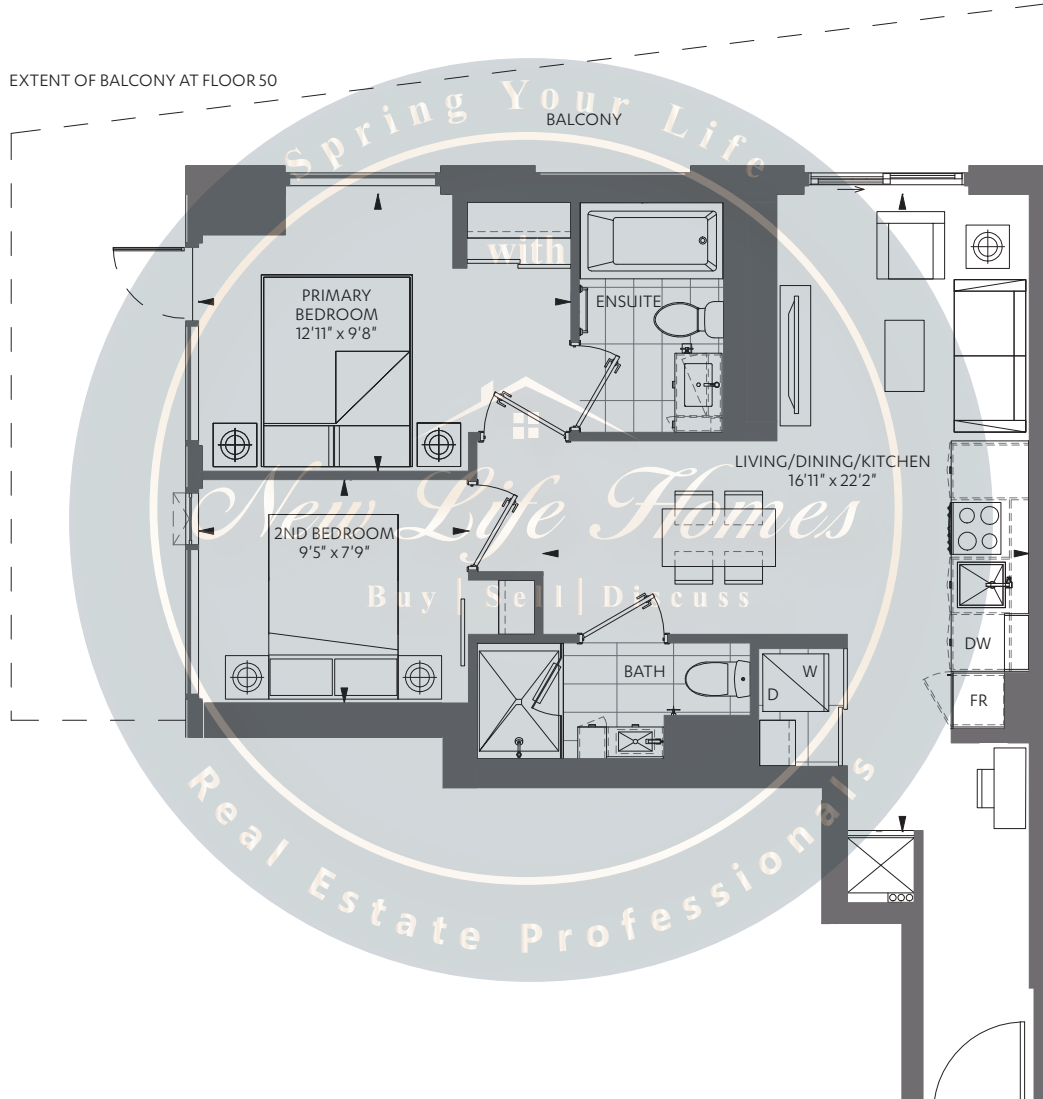

UNIT 04 ON FLOORS: 08-35 & 37-52  
FLOOR 50 KEYPLAN SHOWN



The Purchaser acknowledges and agrees that he/she has reviewed the key plan for the level on which the Unit is located, including, without limitation, the anticipated design, configuration and/or access point(s) of any exclusive use common area balcony or terrace appurtenant to the specific Unit being purchased, which design, configuration, and/or access point(s) may vary from unit to unit and/or level to level. The Purchaser acknowledges and agrees that the glass panels appurtenant to the Unit may be spandrel glass, vision glass, glazed glass, and/or such other glass as the Vendor may determine, in its sole and absolute discretion, based on the final architectural design of the building and the energy model report for the building. Exterior areas may contain architectural elements not shown on plans. Sizes and specifications are subject to change without notice. E. + O.E. March, 2024

2 BED + MEDIA + 2 BATH

INTERIOR: 675 SF

EXTERIOR: 114 SF

# D-675

EXTENT OF BALCONY AT FLOOR 40

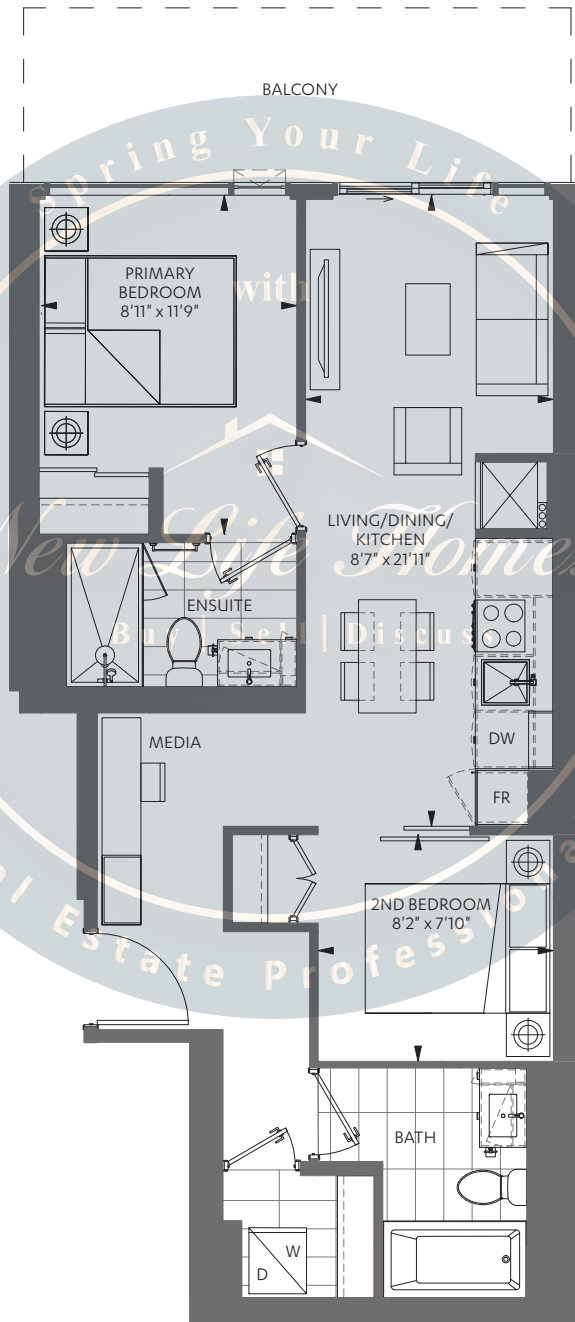

UNIT 01 ON FLOORS: 37-56  
FLOOR 40 KEYPLAN SHOWN

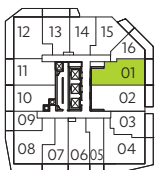

FLOOR 40



The Purchaser acknowledges and agrees that he/she has reviewed the key plan for the level on which the Unit is located, including, without limitation, the anticipated design, configuration and/or access point(s) of any exclusive use common area balcony or terrace appurtenant to the specific Unit being purchased, which design, configuration, and/or access point(s) may vary from unit to unit and/or level to level. The Purchaser acknowledges and agrees that the glass panels appurtenant to the Unit may be spandrel glass, vision glass, glazed glass, and/or such other glass as the Vendor may determine, in its sole and absolute discretion, based on the final architectural design of the building and the energy model report for the building. Exterior areas may contain architectural elements not shown on plans. Sizes and specifications are subject to change without notice. E. + O.E. March, 2024

2 BED + MEDIA + 2 BATH

INTERIOR: 718 SF  
EXTERIOR: 289 SF\*

\*Balcony square footage and layout correspond to this floor only. To find the actual balcony layout, please refer to the corresponding floor and unit number indicated on the Keyplan sheets.

# D1-718

EXTENT OF BALCONY AT FLOOR 11

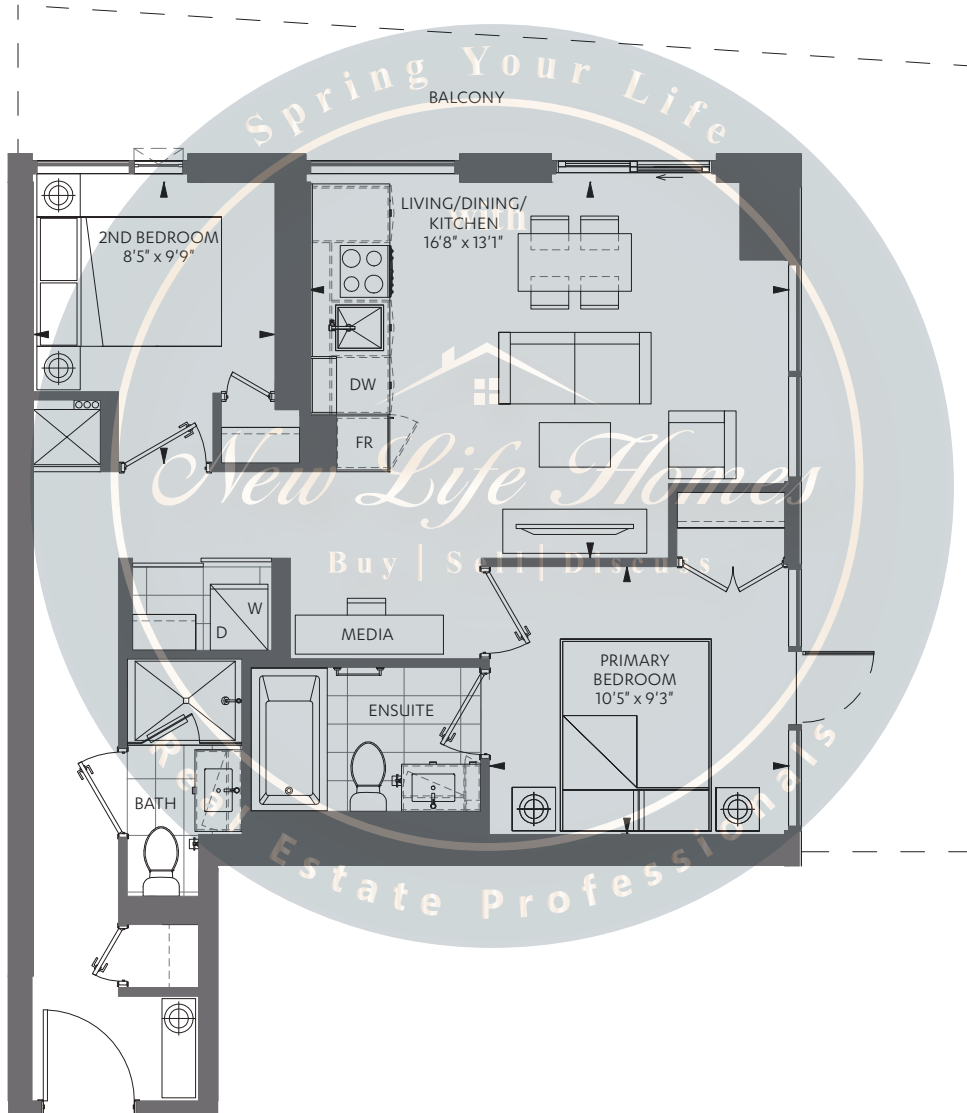

UNIT 07 ON FLOORS: 08-14  
FLOOR 11 KEYPLAN SHOWN

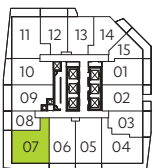

FLOOR 11

The Purchaser acknowledges and agrees that he/she has reviewed the key plan for the level on which the Unit is located, including, without limitation, the anticipated design, configuration and/or access point(s) of any exclusive use common area balcony or terrace appurtenant to the specific Unit being purchased, which design, configuration, and/or access point(s) may vary from unit to unit and/or level to level. The Purchaser acknowledges and agrees that the glass panels appurtenant to the Unit may be spandrel glass, vision glass, glazed glass, and/or such other glass as the Vendor may determine, in its sole and absolute discretion, based on the final architectural design of the building and the energy model report for the building. Exterior areas may contain architectural elements not shown on plans. Sizes and specifications are subject to change without notice. E. + O.E. March, 2024



2 BED + MEDIA + 2 BATH

INTERIOR: 672 SF  
EXTERIOR: 254 SF\*

\*Balcony square footage and layout correspond to this floor only. To find the actual balcony layout, please refer to the corresponding floor and unit number indicated on the Keyplan sheets.

D-670

EXTENT OF BALCONY AT FLOOR 15

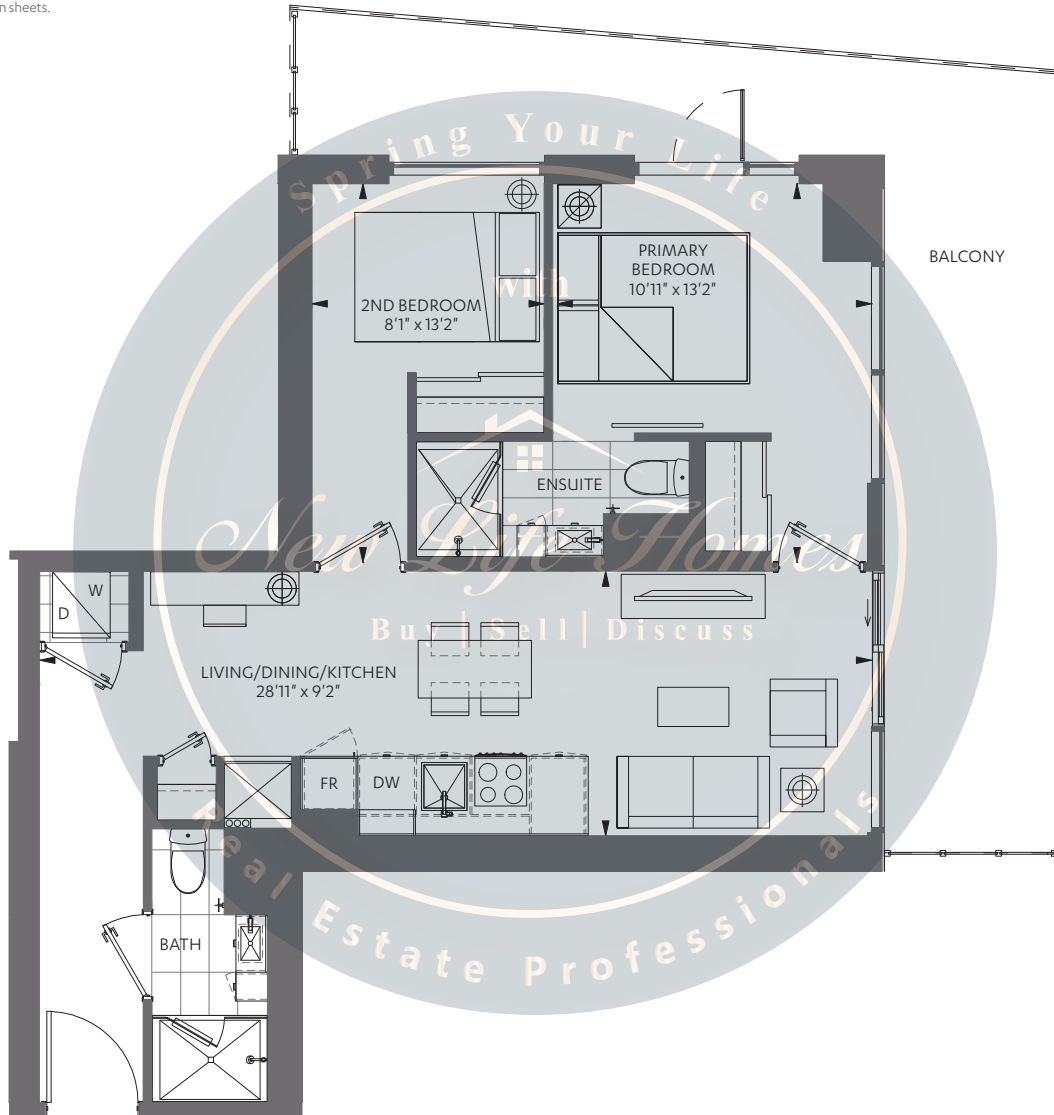

UNIT 08 ON FLOORS: 15-35 & 37-52  
FLOOR 15 KEYPLAN SHOWN



FLOOR 15



FLOOR 36



The Purchaser acknowledges and agrees that he/she has reviewed the key plan for the level on which the Unit is located, including, without limitation, the anticipated design, configuration and/or access point(s) of any exclusive use common area balcony or terrace appurtenant to the specific Unit being purchased, which design, configuration, and/or access point(s) may vary from unit to unit and/or level to level. The Purchaser acknowledges and agrees that the glass panels appurtenant to the Unit may be spandrel glass, vision glass, glazed glass, and/or such other glass as the Vendor may determine, in its sole and absolute discretion, based on the final architectural design of the building and the energy model report for the building. Exterior areas may contain architectural elements not shown on plans. Sizes and specifications are subject to change without notice. E. + O.E. March, 2024

2 BED + DEN + 2 BATH

INTERIOR: 628 SF

EXTERIOR: 114 SF

# E1-628

EXTENT OF BALCONY AT FLOOR 11

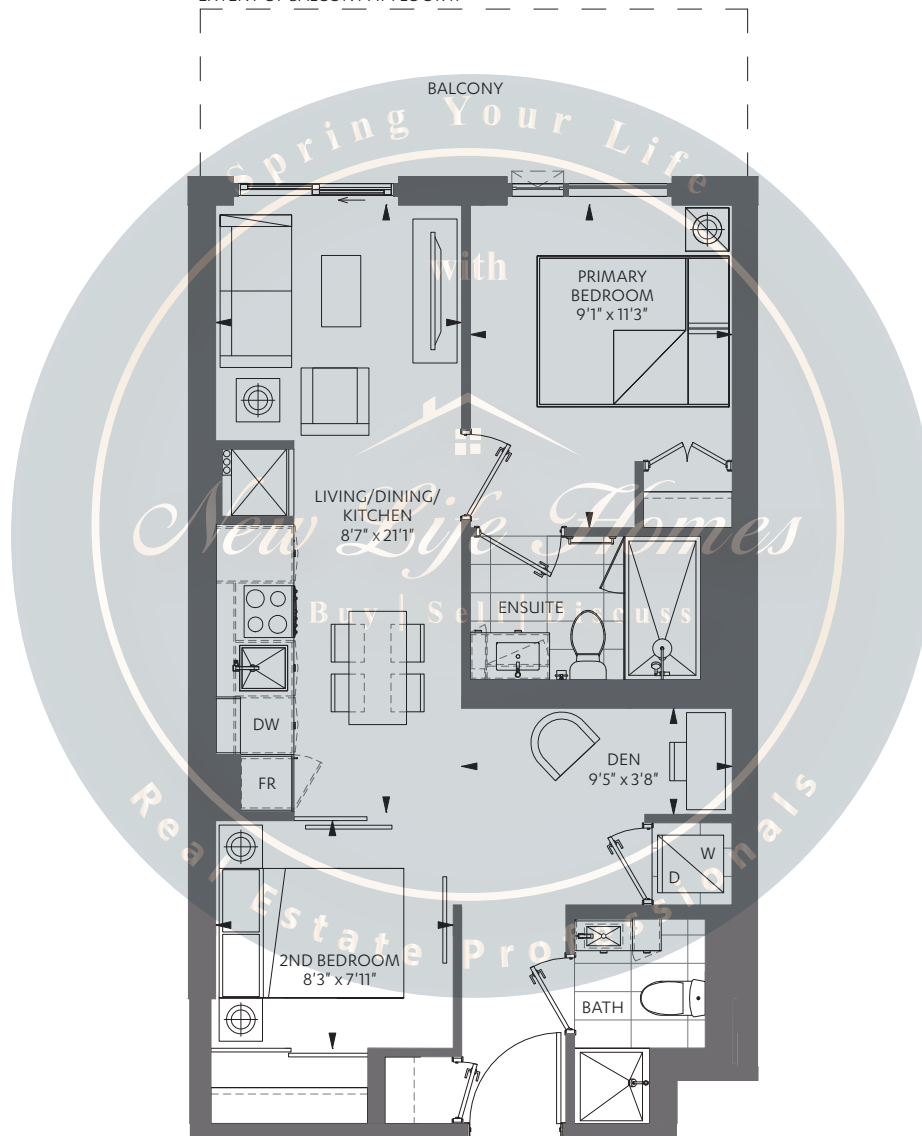

UNIT 05 ON FLOORS: 08-14  
FLOOR 11 KEYPLAN SHOWN



FLOOR 11



The Purchaser acknowledges and agrees that he/she has reviewed the key plan for the level on which the Unit is located, including, without limitation, the anticipated design, configuration and/or access point(s) of any exclusive use common area balcony or terrace appurtenant to the specific Unit being purchased, which design, configuration, and/or access point(s) may vary from unit to unit and/or level to level. The Purchaser acknowledges and agrees that the glass panels appurtenant to the Unit may be spandrel glass, vision glass, glazed glass, and/or such other glass as the Vendor may determine, in its sole and absolute discretion, based on the final architectural design of the building and the energy model report for the building. Exterior areas may contain architectural elements not shown on plans. Sizes and specifications are subject to change without notice. E. + O.E. March, 2024

2 BED + DEN + 2 BATH

INTERIOR: 628 SF  
EXTERIOR: 111 SF\*

\*Balcony square footage and layout correspond to this floor only. To find the actual balcony layout, please refer to the corresponding floor and unit number indicated on the Keyplan sheets.

# E2-628

EXTENT OF BALCONY AT FLOOR 11

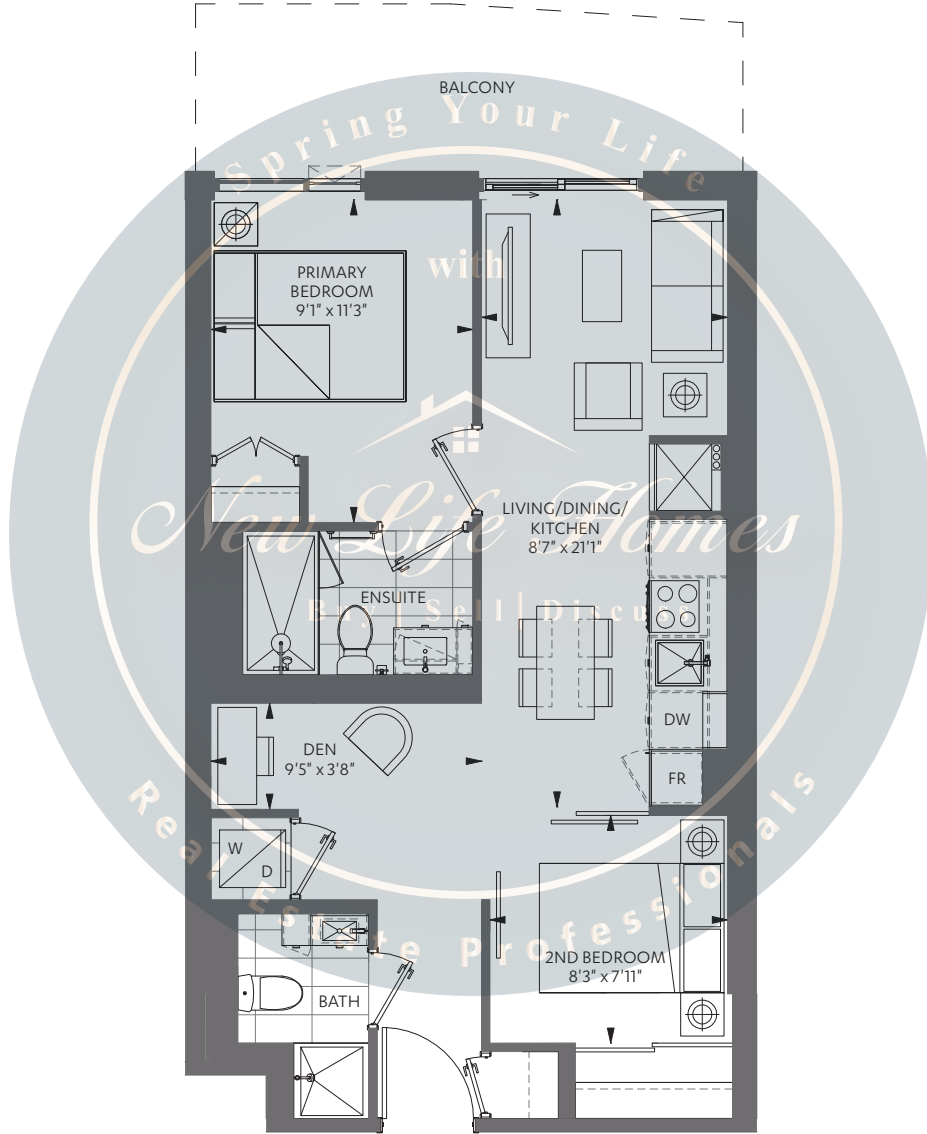

UNIT 06 ON FLOORS: 08-14  
FLOOR 11 KEYPLAN SHOWN

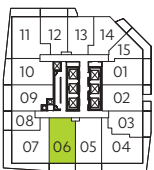

FLOOR 11



The Purchaser acknowledges and agrees that he/she has reviewed the key plan for the level on which the Unit is located, including, without limitation, the anticipated design, configuration and/or access point(s) of any exclusive use common area balcony or terrace appurtenant to the specific Unit being purchased, which design, configuration, and/or access point(s) may vary from unit to unit and/or level to level. The Purchaser acknowledges and agrees that the glass panels appurtenant to the Unit may be spandrel glass, vision glass, glazed glass, and/or such other glass as the Vendor may determine, in its sole and absolute discretion, based on the final architectural design of the building and the energy model report for the building. Exterior areas may contain architectural elements not shown on plans. Sizes and specifications are subject to change without notice. E. + O.E. March, 2024

2 BED + FLEX + 2 BATH

INTERIOR: 741 SF  
EXTERIOR: 94 SF\*

\*Balcony square footage and layout correspond to this floor only. To find the actual balcony layout, please refer to the corresponding floor and unit number indicated on the Keyplan sheets.

E-741

EXTENT OF BALCONY AT FLOOR 40

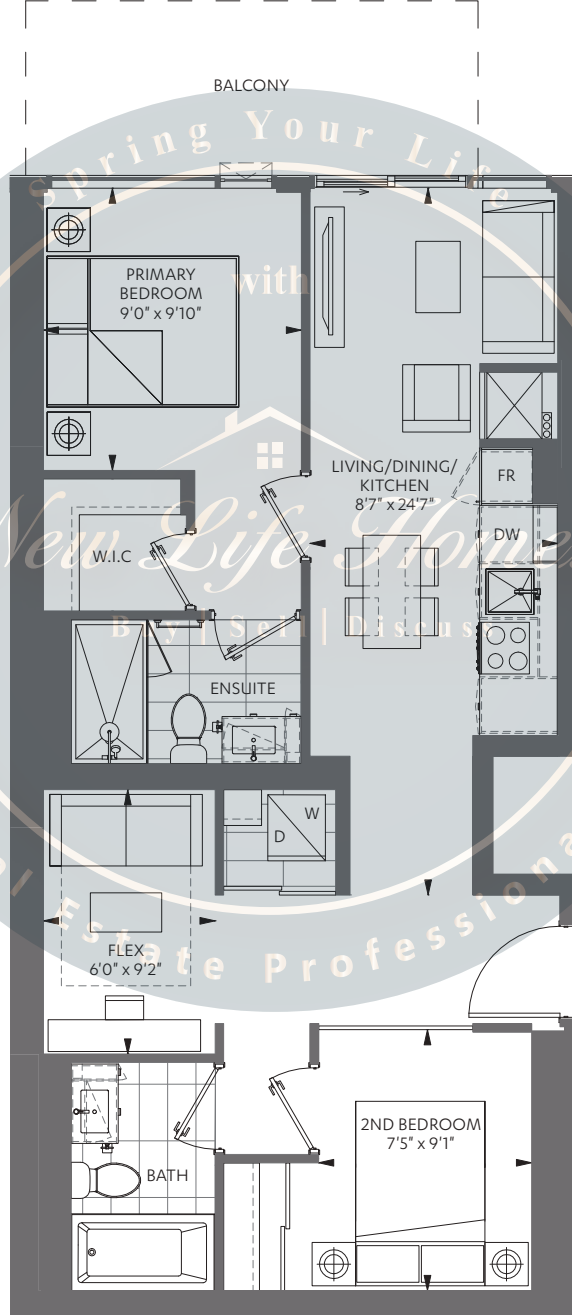

UNIT 02 ON FLOORS: 39-56  
FLOOR 40 KEYPLAN SHOWN

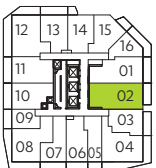

FLOOR 40



The Purchaser acknowledges and agrees that he/she has reviewed the key plan for the level on which the Unit is located, including, without limitation, the anticipated design, configuration and/or access point(s) of any exclusive use common area balcony or terrace appurtenant to the specific Unit being purchased, which design, configuration, and/or access point(s) may vary from unit to unit and/or level to level. The Purchaser acknowledges and agrees that the glass panels appurtenant to the Unit may be spandrel glass, vision glass, glazed glass, and/or such other glass as the Vendor may determine, in its sole and absolute discretion, based on the final architectural design of the building and the energy model report for the building. Exterior areas may contain architectural elements not shown on plans. Sizes and specifications are subject to change without notice. E. + O.E. March, 2024

1 BED + 1 BATH

INTERIOR: 520 SF

# PB-520

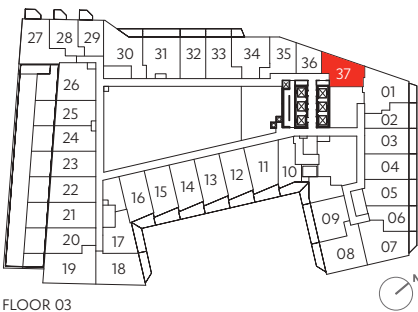
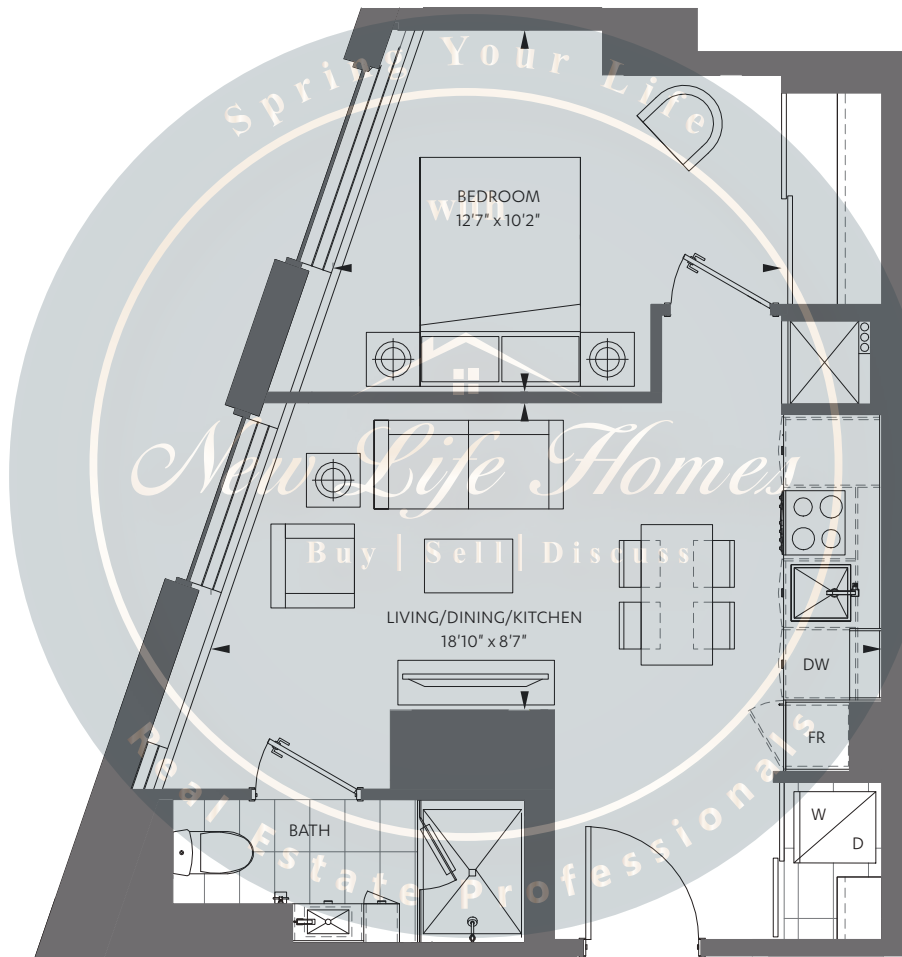

FLOOR 03

The Purchaser acknowledges and agrees that he/she has reviewed the key plan for the level on which the Unit is located, including, without limitation, the anticipated design, configuration and/or access point(s) of any exclusive use common area balcony or terrace appurtenant to the specific Unit being purchased, which design, configuration, and/or access point(s) may vary from unit to unit and/or level to level. The Purchaser acknowledges and agrees that the glass panels appurtenant to the Unit may be spandrel glass, vision glass, glazed glass, and/or such other glass as the Vendor may determine, in its sole and absolute discretion, based on the final architectural design of the building and the energy model report for the building. Exterior areas may contain architectural elements not shown on plans. Sizes and specifications are subject to change without notice. E. + O.E. March, 2024

1 BED + DEN + 1 BATH

INTERIOR: 487 SF

EXTERIOR: 112 SF

# PC-487

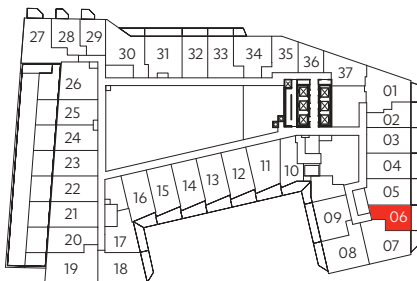
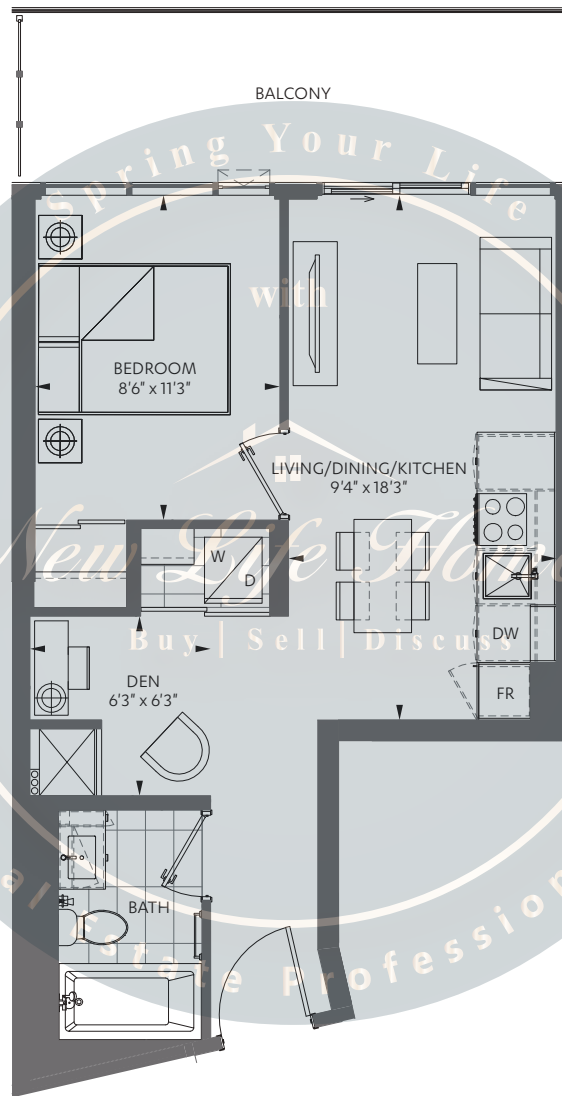

FLOOR 03

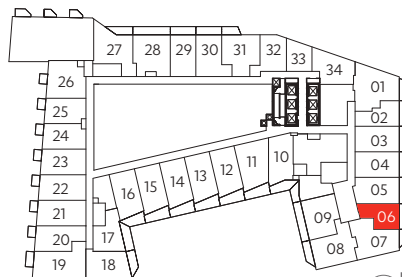

FLOOR 04

The Purchaser acknowledges and agrees that he/she has reviewed the key plan for the level on which the Unit is located, including, without limitation, the anticipated design, configuration and/or access point(s) of any exclusive use common area balcony or terrace appurtenant to the specific Unit being purchased, which design, configuration, and/or access point(s) may vary from unit to unit and/or level to level. The Purchaser acknowledges and agrees that the glass panels appurtenant to the Unit may be spandrel glass, vision glass, glazed glass, and/or such other glass as the Vendor may determine, in its sole and absolute discretion, based on the final architectural design of the building and the energy model report for the building. Exterior areas may contain architectural elements not shown on plans. Sizes and specifications are subject to change without notice. E. + O.E. March, 2024

1 BED + DEN + 1 BATH

INTERIOR: 497 SF

EXTERIOR: 84 SF

# PC-497

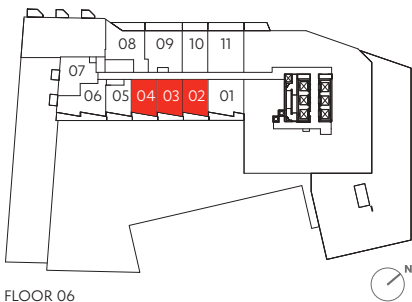
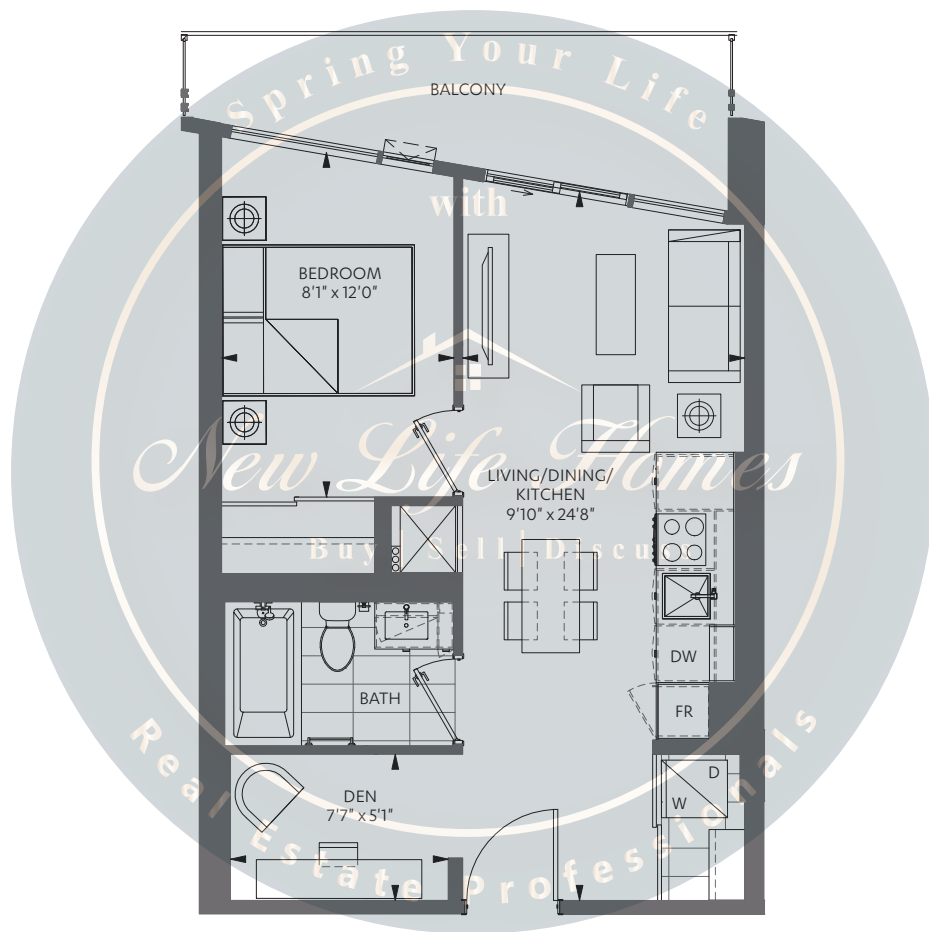

FLOOR 06

The Purchaser acknowledges and agrees that he/she has reviewed the key plan for the level on which the Unit is located, including, without limitation, the anticipated design, configuration and/or access point(s) of any exclusive use common area balcony or terrace appurtenant to the specific Unit being purchased, which design, configuration, and/or access point(s) may vary from unit to unit and/or level to level. The Purchaser acknowledges and agrees that the glass panels appurtenant to the Unit may be spandrel glass, vision glass, glazed glass, and/or such other glass as the Vendor may determine, in its sole and absolute discretion, based on the final architectural design of the building and the energy model report for the building. Exterior areas may contain architectural elements not shown on plans. Sizes and specifications are subject to change without notice. E. + O.E. March, 2024



1 BED + DEN + 1 BATH

INTERIOR: 507 SF

EXTERIOR: 58 SF

# PG-507

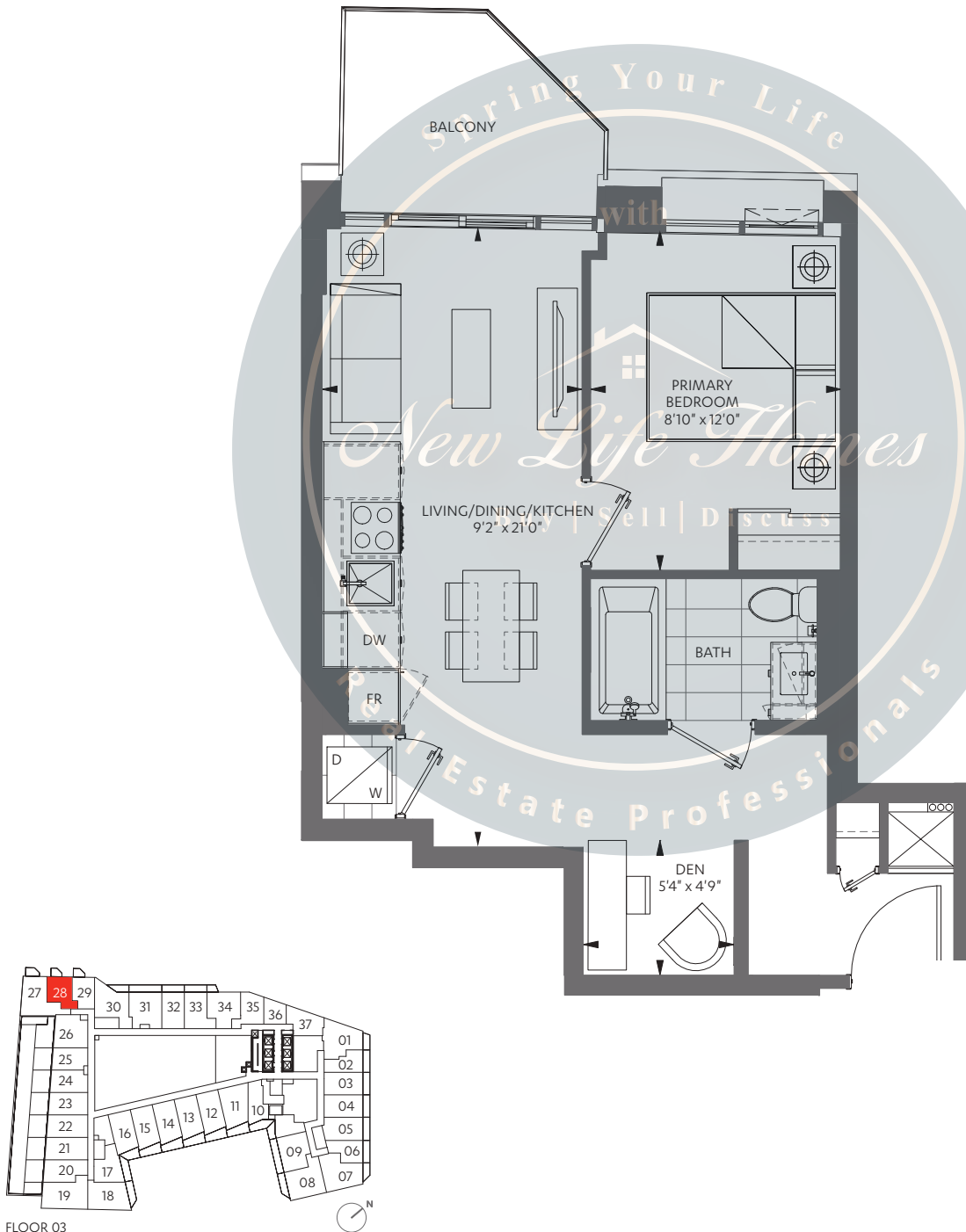

The Purchaser acknowledges and agrees that he/she has reviewed the key plan for the level on which the Unit is located, including, without limitation, the anticipated design, configuration and/or access point(s) of any exclusive use common area balcony or terrace appurtenant to the specific Unit being purchased, which design, configuration, and/or access point(s) may vary from unit to unit and/or level to level. The Purchaser acknowledges and agrees that the glass panels appurtenant to the Unit may be spandrel glass, vision glass, glazed glass, and/or such other glass as the Vendor may determine, in its sole and absolute discretion, based on the final architectural design of the building and the energy model report for the building. Exterior areas may contain architectural elements not shown on plans. Sizes and specifications are subject to change without notice. E. + O.E. March, 2024

1 BED + FLEX + 1 BATH

INTERIOR: 462 SF

EXTERIOR: 114 SF

# PC-462

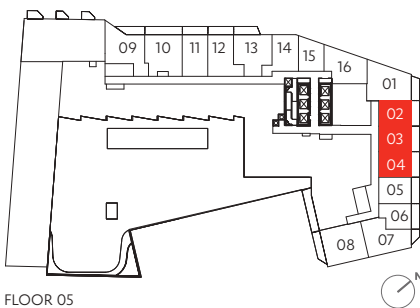
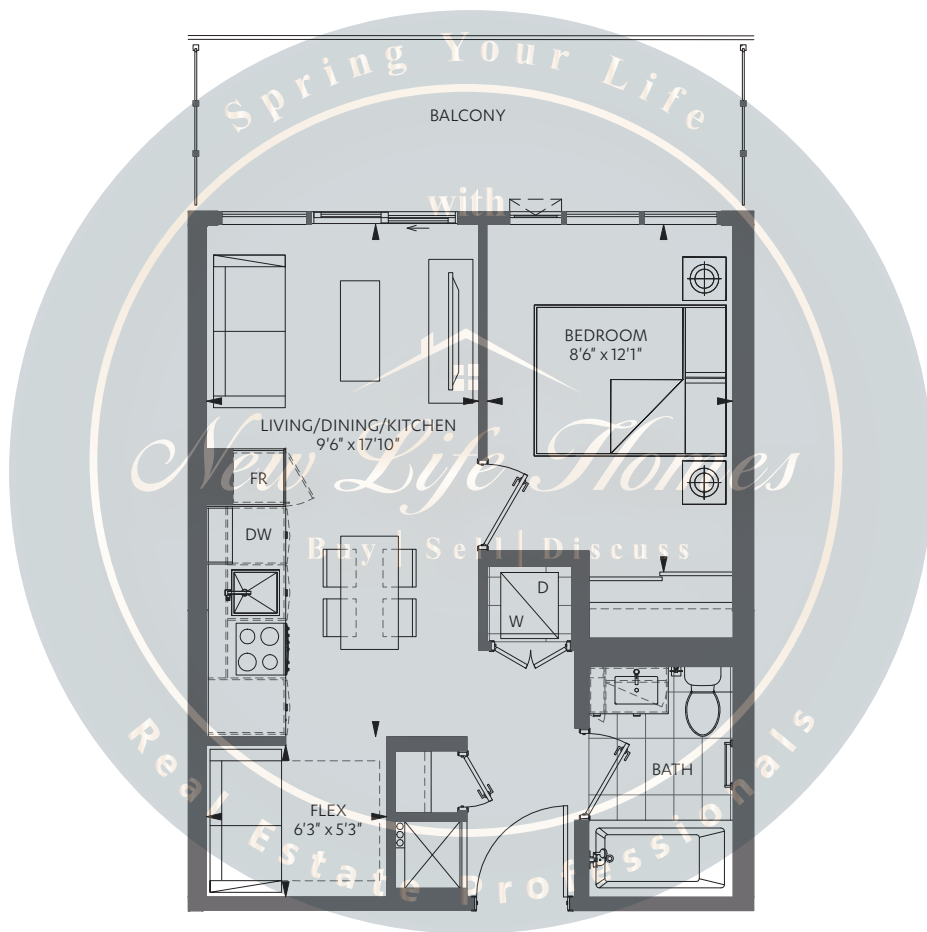

FLOOR 05

The Purchaser acknowledges and agrees that he/she has reviewed the key plan for the level on which the Unit is located, including, without limitation, the anticipated design, configuration and/or access point(s) of any exclusive use common area balcony or terrace appurtenant to the specific Unit being purchased, which design, configuration, and/or access point(s) may vary from unit to unit and/or level to level. The Purchaser acknowledges and agrees that the glass panels appurtenant to the Unit may be spandrel glass, vision glass, glazed glass, and/or such other glass as the Vendor may determine, in its sole and absolute discretion, based on the final architectural design of the building and the energy model report for the building. Exterior areas may contain architectural elements not shown on plans. Sizes and specifications are subject to change without notice. E. + O.E. March, 2024

1 BED + FLEX + 2 BATH

INTERIOR: 634 SF

# PC-634

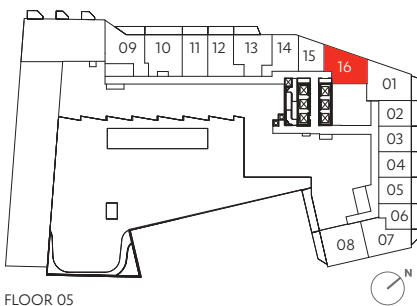
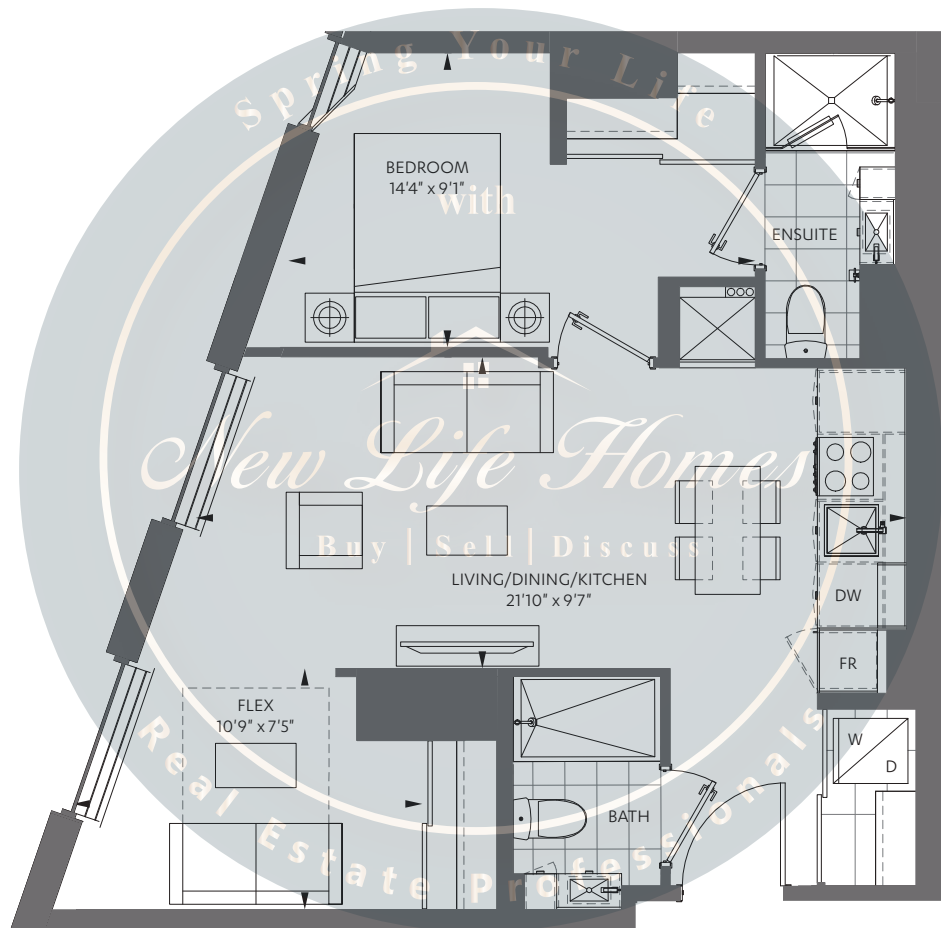

The Purchaser acknowledges and agrees that he/she has reviewed the key plan for the level on which the Unit is located, including, without limitation, the anticipated design, configuration and/or access point(s) of any exclusive use common area balcony or terrace appurtenant to the specific Unit being purchased, which design, configuration, and/or access point(s) may vary from unit to unit and/or level to level. The Purchaser acknowledges and agrees that the glass panels appurtenant to the Unit may be spandrel glass, vision glass, glazed glass, and/or such other glass as the Vendor may determine, in its sole and absolute discretion, based on the final architectural design of the building and the energy model report for the building. Exterior areas may contain architectural elements not shown on plans. Sizes and specifications are subject to change without notice. E. + O.E. March, 2024

1 BED + FLEX + 1 BATH

INTERIOR: 593 SF

BALCONY: 114 SF

BALCONY AT FLOOR 4, 5, 6: 109 SF

# PG-593

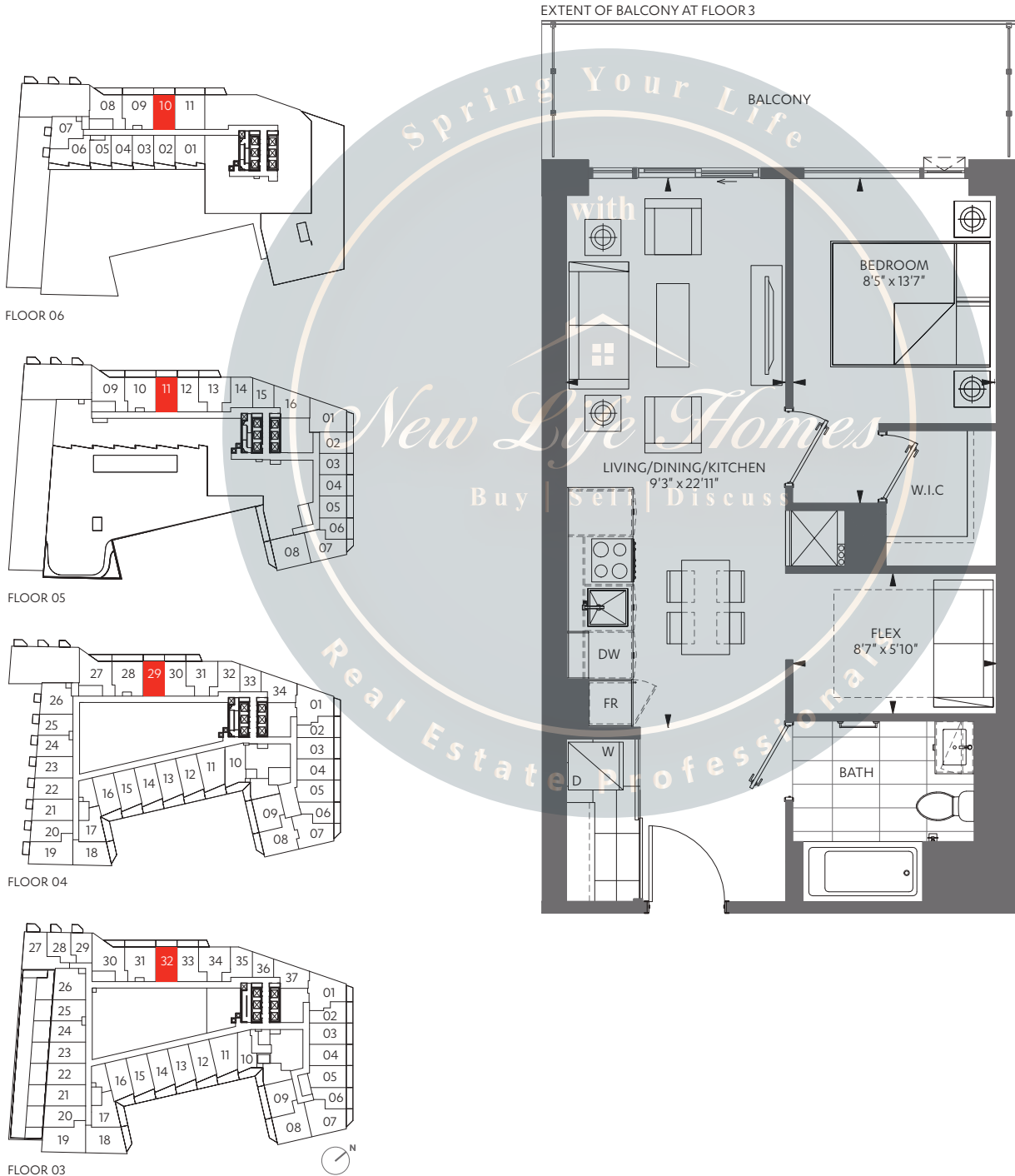

The Purchaser acknowledges and agrees that he/she has reviewed the key plan for the level on which the Unit is located, including, without limitation, the anticipated design, configuration and/or access point(s) of any exclusive use common area balcony or terrace appurtenant to the specific Unit being purchased, which design, configuration, and/or access point(s) may vary from unit to unit and/or level to level. The Purchaser acknowledges and agrees that the glass panels appurtenant to the Unit may be spandrel glass, vision glass, glazed glass, and/or such other glass as the Vendor may determine, in its sole and absolute discretion, based on the final architectural design of the building and the energy model report for the building. Exterior areas may contain architectural elements not shown on plans. Sizes and specifications are subject to change without notice. E. + O.E. March, 2024

1 BED + FLEX + 2 BATH (BF)

INTERIOR: 587 SF

TERRACE: 289 SF

BALCONY AT FLOOR 4: 51 SF

# PG-587

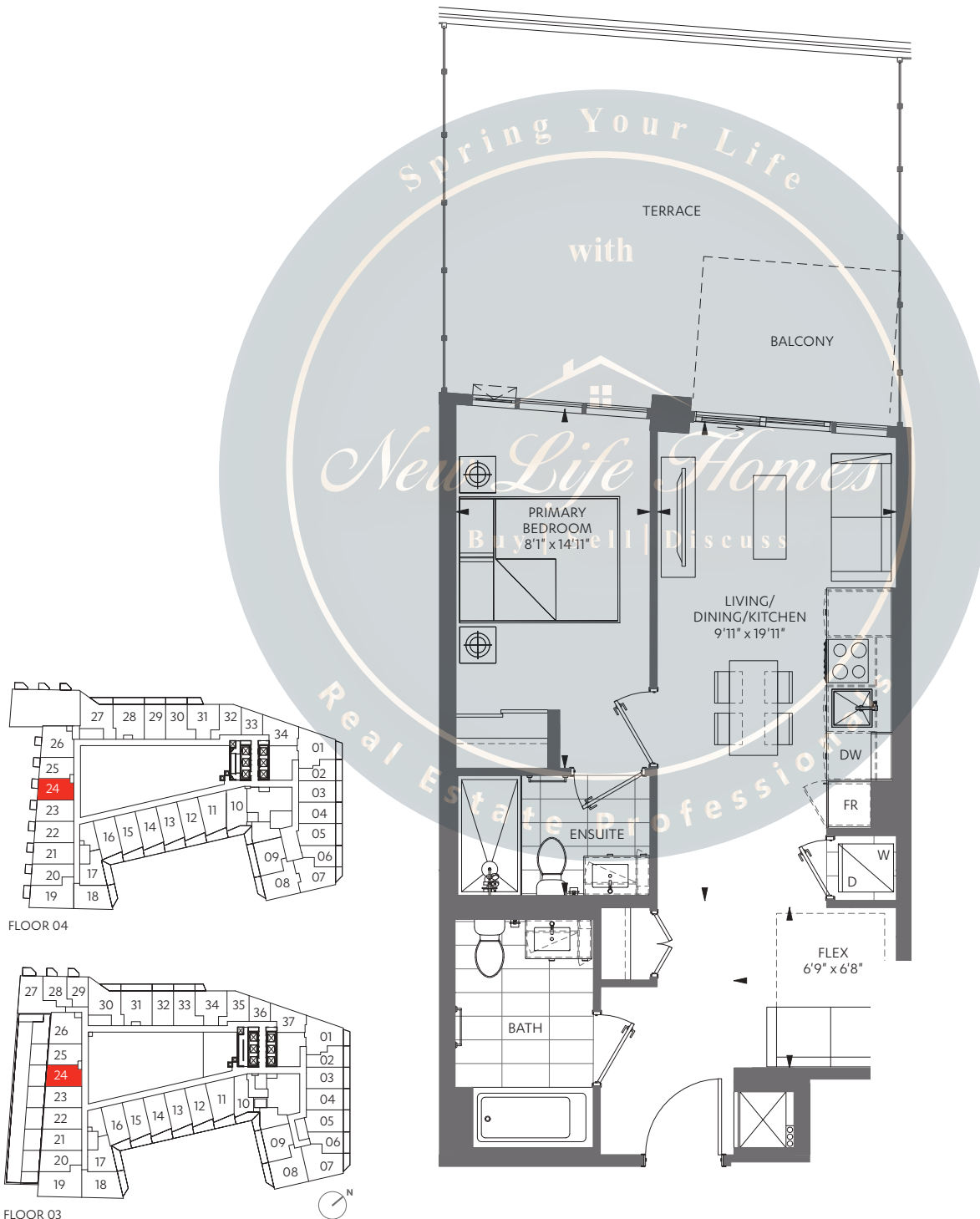

The Purchaser acknowledges and agrees that he/she has reviewed the key plan for the level on which the Unit is located, including, without limitation, the anticipated design, configuration and/or access point(s) of any exclusive use common area balcony or terrace appurtenant to the specific Unit being purchased, which design, configuration, and/or access point(s) may vary from unit to unit and/or level to level. The Purchaser acknowledges and agrees that the glass panels appurtenant to the Unit may be spandrel glass, vision glass, glazed glass, and/or such other glass as the Vendor may determine, in its sole and absolute discretion, based on the final architectural design of the building and the energy model report for the building. Exterior areas may contain architectural elements not shown on plans. Sizes and specifications are subject to change without notice. E. + O.E. March, 2024

1 BED + FLEX + MEDIA + 2 BATH

INTERIOR: 660 SF

EXTERIOR: 131 SF

# PG-660

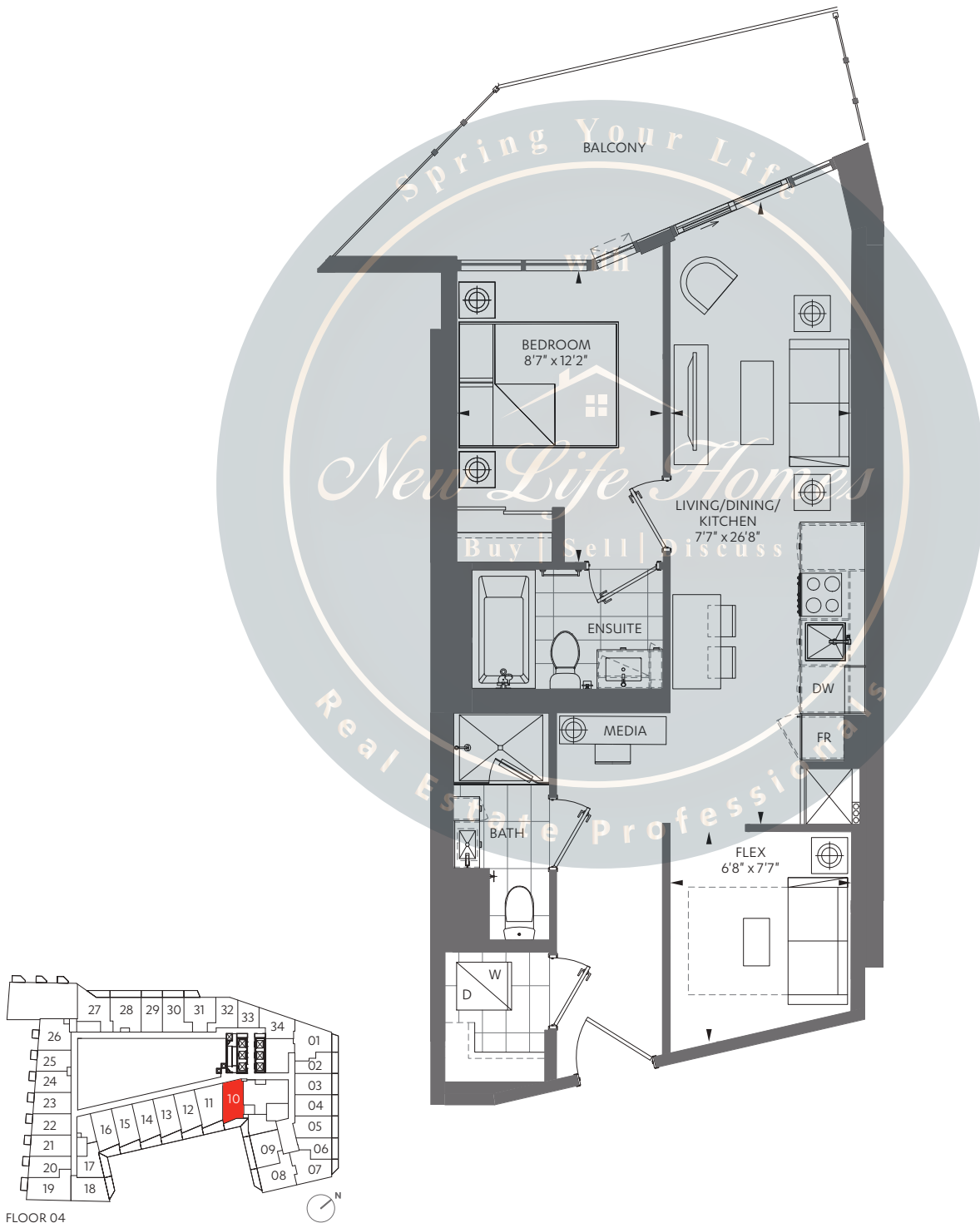

FLOOR 04

The Purchaser acknowledges and agrees that he/she has reviewed the key plan for the level on which the Unit is located, including, without limitation, the anticipated design, configuration and/or access point(s) of any exclusive use common area balcony or terrace appurtenant to the specific Unit being purchased, which design, configuration, and/or access point(s) may vary from unit to unit and/or level to level. The Purchaser acknowledges and agrees that the glass panels appurtenant to the Unit may be spandrel glass, vision glass, glazed glass, and/or such other glass as the Vendor may determine, in its sole and absolute discretion, based on the final architectural design of the building and the energy model report for the building. Exterior areas may contain architectural elements not shown on plans. Sizes and specifications are subject to change without notice. E. + O.E. March, 2024

1 BED + MEDIA + 1 BATH

INTERIOR: 446 SF

# PB-446

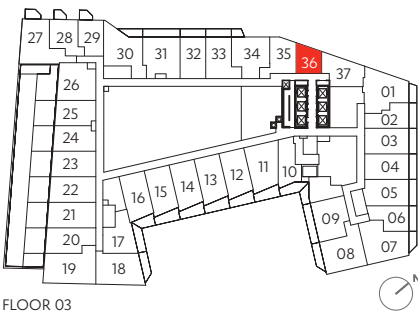
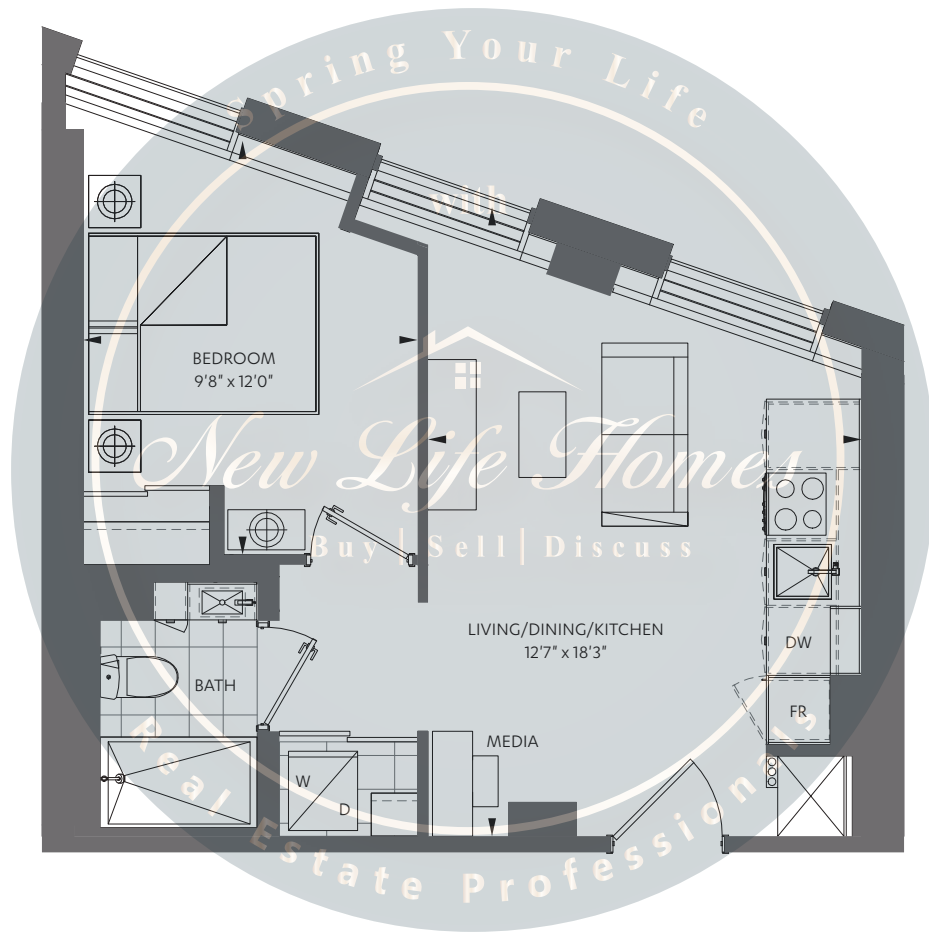

FLOOR 03

The Purchaser acknowledges and agrees that he/she has reviewed the key plan for the level on which the Unit is located, including, without limitation, the anticipated design, configuration and/or access point(s) of any exclusive use common area balcony or terrace appurtenant to the specific Unit being purchased, which design, configuration, and/or access point(s) may vary from unit to unit and/or level to level. The Purchaser acknowledges and agrees that the glass panels appurtenant to the Unit may be spandrel glass, vision glass, glazed glass, and/or such other glass as the Vendor may determine, in its sole and absolute discretion, based on the final architectural design of the building and the energy model report for the building. Exterior areas may contain architectural elements not shown on plans. Sizes and specifications are subject to change without notice. E. + O.E. March, 2024



1 BED + MEDIA + 1 BATH

INTERIOR: 529 SF

EXTERIOR: 131 SF

# PB-529

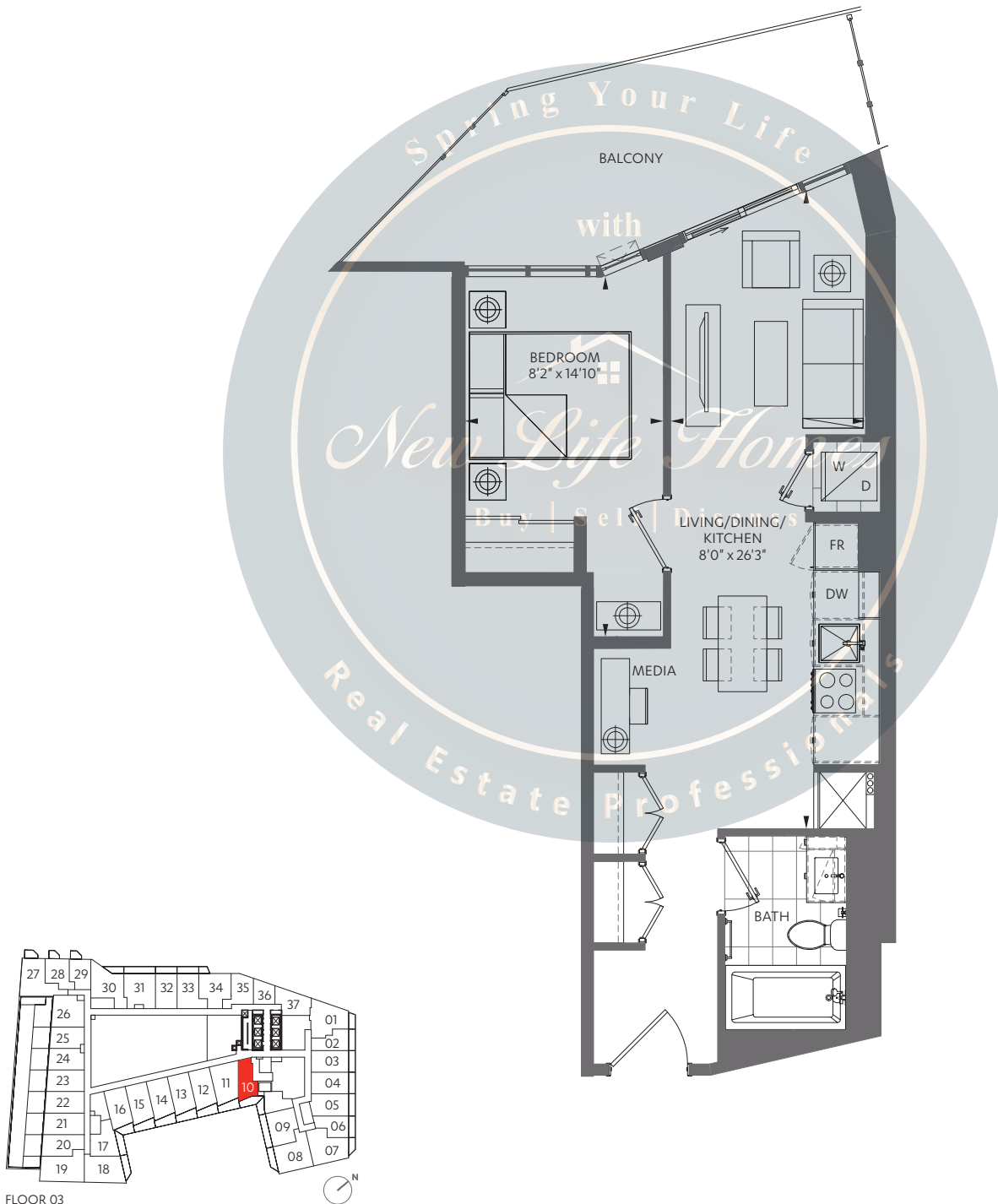

FLOOR 03

The Purchaser acknowledges and agrees that he/she has reviewed the key plan for the level on which the Unit is located, including, without limitation, the anticipated design, configuration and/or access point(s) of any exclusive use common area balcony or terrace appurtenant to the specific Unit being purchased, which design, configuration, and/or access point(s) may vary from unit to unit and/or level to level. The Purchaser acknowledges and agrees that the glass panels appurtenant to the Unit may be spandrel glass, vision glass, glazed glass, and/or such other glass as the Vendor may determine, in its sole and absolute discretion, based on the final architectural design of the building and the energy model report for the building. Exterior areas may contain architectural elements not shown on plans. Sizes and specifications are subject to change without notice. E. + O.E. March, 2024

2 BED + 2 BATH

INTERIOR: 648 SF

EXTERIOR: 140 SF

# PD-648



The Purchaser acknowledges and agrees that he/she has reviewed the key plan for the level on which the Unit is located, including, without limitation, the anticipated design, configuration and/or access point(s) of any exclusive use common area balcony or terrace appurtenant to the specific Unit being purchased, which design, configuration, and/or access point(s) may vary from unit to unit and/or level to level. The Purchaser acknowledges and agrees that the glass panels appurtenant to the Unit may be spandrel glass, vision glass, glazed glass, and/or such other glass as the Vendor may determine, in its sole and absolute discretion, based on the final architectural design of the building and the energy model report for the building. Exterior areas may contain architectural elements not shown on plans. Sizes and specifications are subject to change without notice. E. + O.E. March, 2024

2 BED + 2 BATH

INTERIOR: 664 SF

BALCONY: 107 SF

BALCONY AT FLOOR 4 & 5: 110 SF

# PD-664

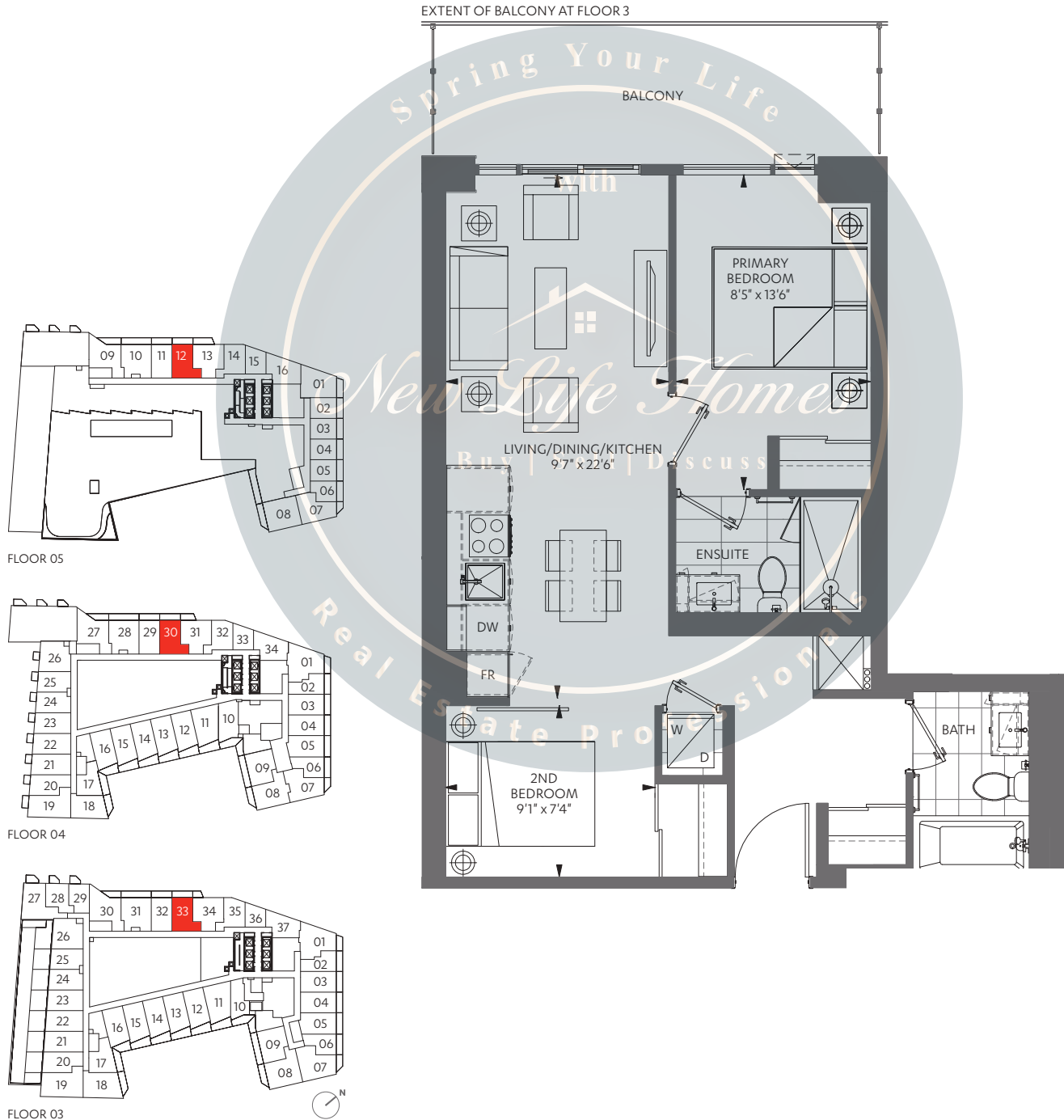

The Purchaser acknowledges and agrees that he/she has reviewed the key plan for the level on which the Unit is located, including, without limitation, the anticipated design, configuration and/or access point(s) of any exclusive use common area balcony or terrace appurtenant to the specific Unit being purchased, which design, configuration, and/or access point(s) may vary from unit to unit and/or level to level. The Purchaser acknowledges and agrees that the glass panels appurtenant to the Unit may be spandrel glass, vision glass, glazed glass, and/or such other glass as the Vendor may determine, in its sole and absolute discretion, based on the final architectural design of the building and the energy model report for the building. Exterior areas may contain architectural elements not shown on plans. Sizes and specifications are subject to change without notice. E. + O.E. March, 2024

2 BED + DEN + 2 BATH

INTERIOR: 628 SF

TERRACE: 289 SF

BALCONY AT FLOOR 4: 51 SF

# PE-628

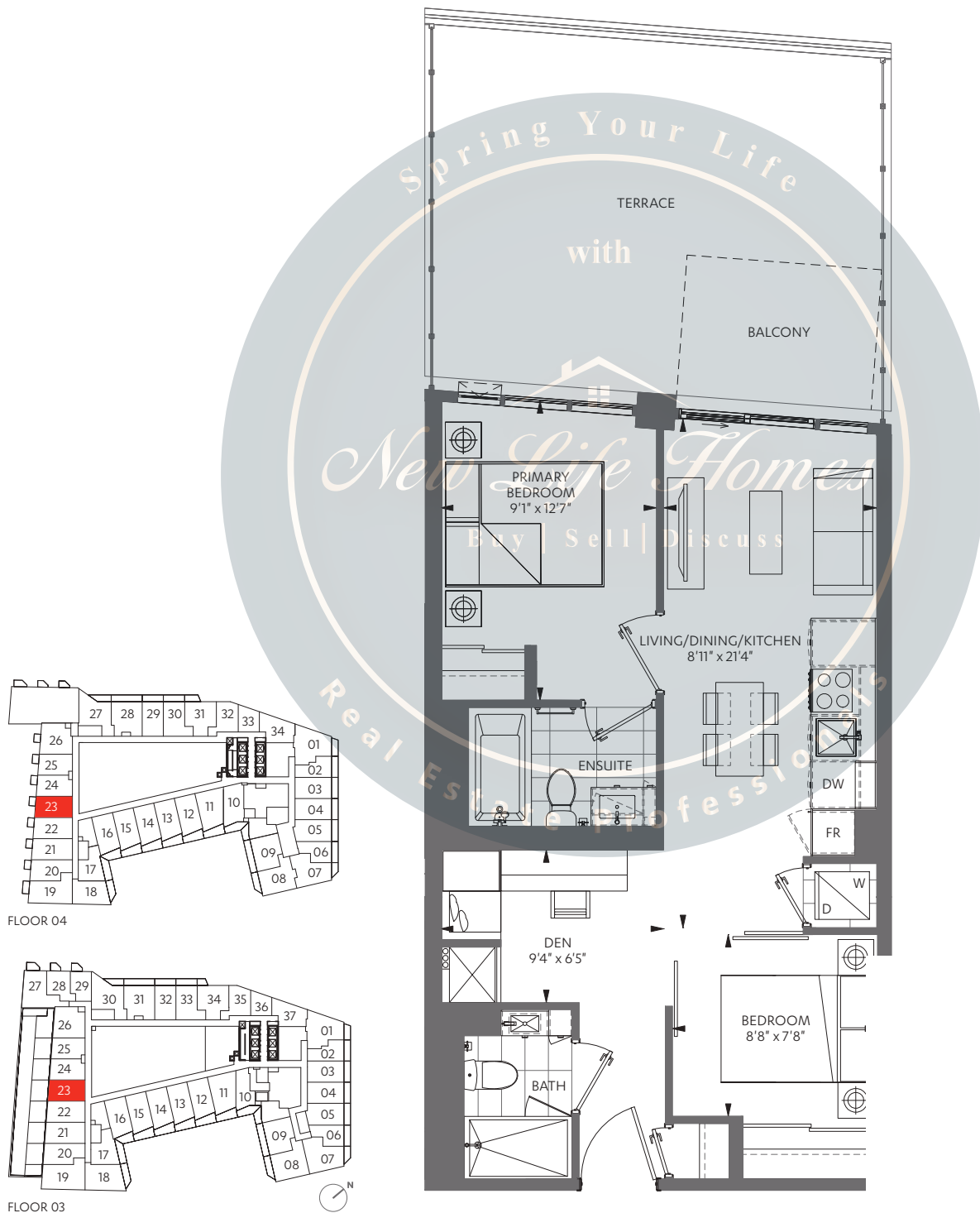

The Purchaser acknowledges and agrees that he/she has reviewed the key plan for the level on which the Unit is located, including, without limitation, the anticipated design, configuration and/or access point(s) of any exclusive use common area balcony or terrace appurtenant to the specific Unit being purchased, which design, configuration, and/or access point(s) may vary from unit to unit and/or level to level. The Purchaser acknowledges and agrees that the glass panels appurtenant to the Unit may be spandrel glass, vision glass, glazed glass, and/or such other glass as the Vendor may determine, in its sole and absolute discretion, based on the final architectural design of the building and the energy model report for the building. Exterior areas may contain architectural elements not shown on plans. Sizes and specifications are subject to change without notice. E. + O.E. March, 2024

2 BED + DEN + 2 BATH

INTERIOR: 655 SF

TERRACE: 292 SF

BALCONY AT FLOOR 4: 51 SF

# PE-655



The Purchaser acknowledges and agrees that he/she has reviewed the key plan for the level on which the Unit is located, including, without limitation, the anticipated design, configuration and/or access point(s) of any exclusive use common area balcony or terrace appurtenant to the specific Unit being purchased, which design, configuration, and/or access point(s) may vary from unit to unit and/or level to level. The Purchaser acknowledges and agrees that the glass panels appurtenant to the Unit may be spandrel glass, vision glass, glazed glass, and/or such other glass as the Vendor may determine, in its sole and absolute discretion, based on the final architectural design of the building and the energy model report for the building. Exterior areas may contain architectural elements not shown on plans. Sizes and specifications are subject to change without notice. E. + O.E. March, 2024

2 BED + DEN + 2 BATH

INTERIOR: 767 SF

BALCONY AT FLOOR 3: 60 SF

BALCONY AT FLOOR 4: 74 SF

BALCONY AT FLOOR 5: 104 SF

# PE-767

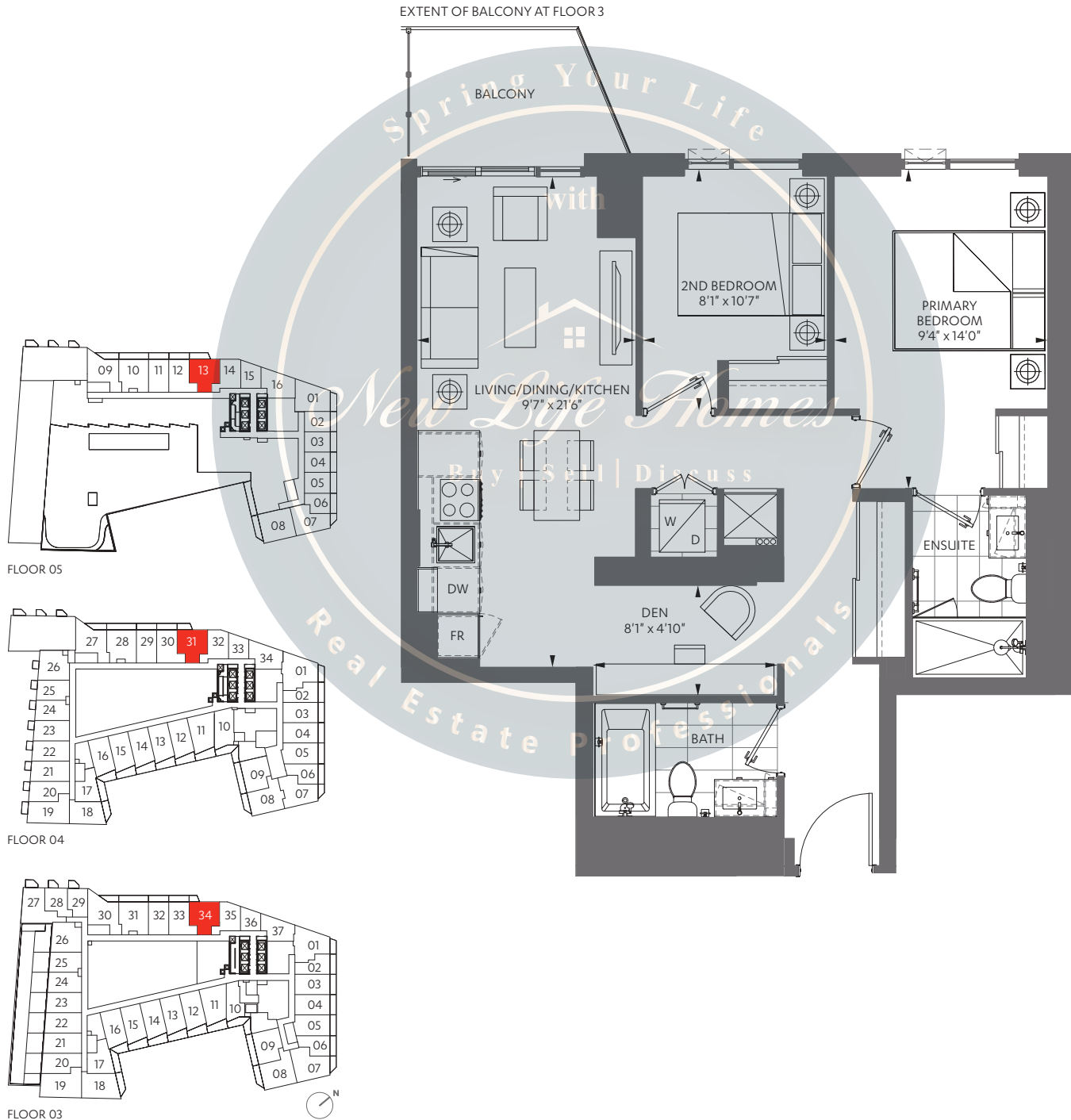

The Purchaser acknowledges and agrees that he/she has reviewed the key plan for the level on which the Unit is located, including, without limitation, the anticipated design, configuration and/or access point(s) of any exclusive use common area balcony or terrace appurtenant to the specific Unit being purchased, which design, configuration, and/or access point(s) may vary from unit to unit and/or level to level. The Purchaser acknowledges and agrees that the glass panels appurtenant to the Unit may be spandrel glass, vision glass, glazed glass, and/or such other glass as the Vendor may determine, in its sole and absolute discretion, based on the final architectural design of the building and the energy model report for the building. Exterior areas may contain architectural elements not shown on plans. Sizes and specifications are subject to change without notice. E. + O.E. March, 2024

2 BED + FLEX + 2 BATH

INTERIOR: 706 SF

EXTERIOR: 122 SF

# PE-706

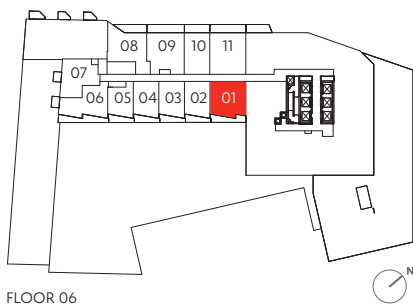
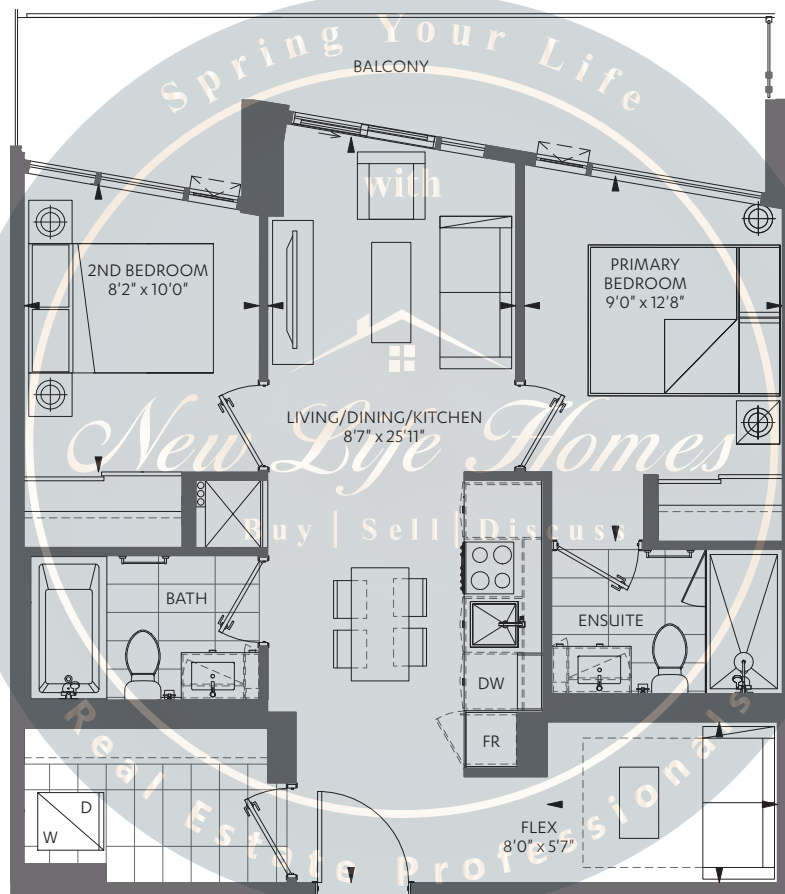

FLOOR 06

The Purchaser acknowledges and agrees that he/she has reviewed the key plan for the level on which the Unit is located, including, without limitation, the anticipated design, configuration and/or access point(s) of any exclusive use common area balcony or terrace appurtenant to the specific Unit being purchased, which design, configuration, and/or access point(s) may vary from unit to unit and/or level to level. The Purchaser acknowledges and agrees that the glass panels appurtenant to the Unit may be spandrel glass, vision glass, glazed glass, and/or such other glass as the Vendor may determine, in its sole and absolute discretion, based on the final architectural design of the building and the energy model report for the building. Exterior areas may contain architectural elements not shown on plans. Sizes and specifications are subject to change without notice. E. + O.E. March, 2024

2 BED + FLEX + 2 BATH

INTERIOR: 732 SF

EXTERIOR: 177 SF

# PE-732

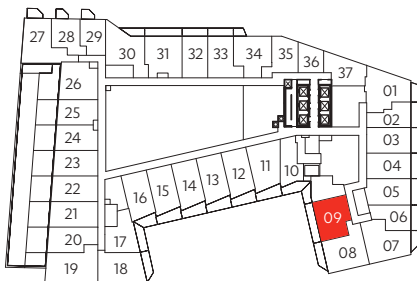
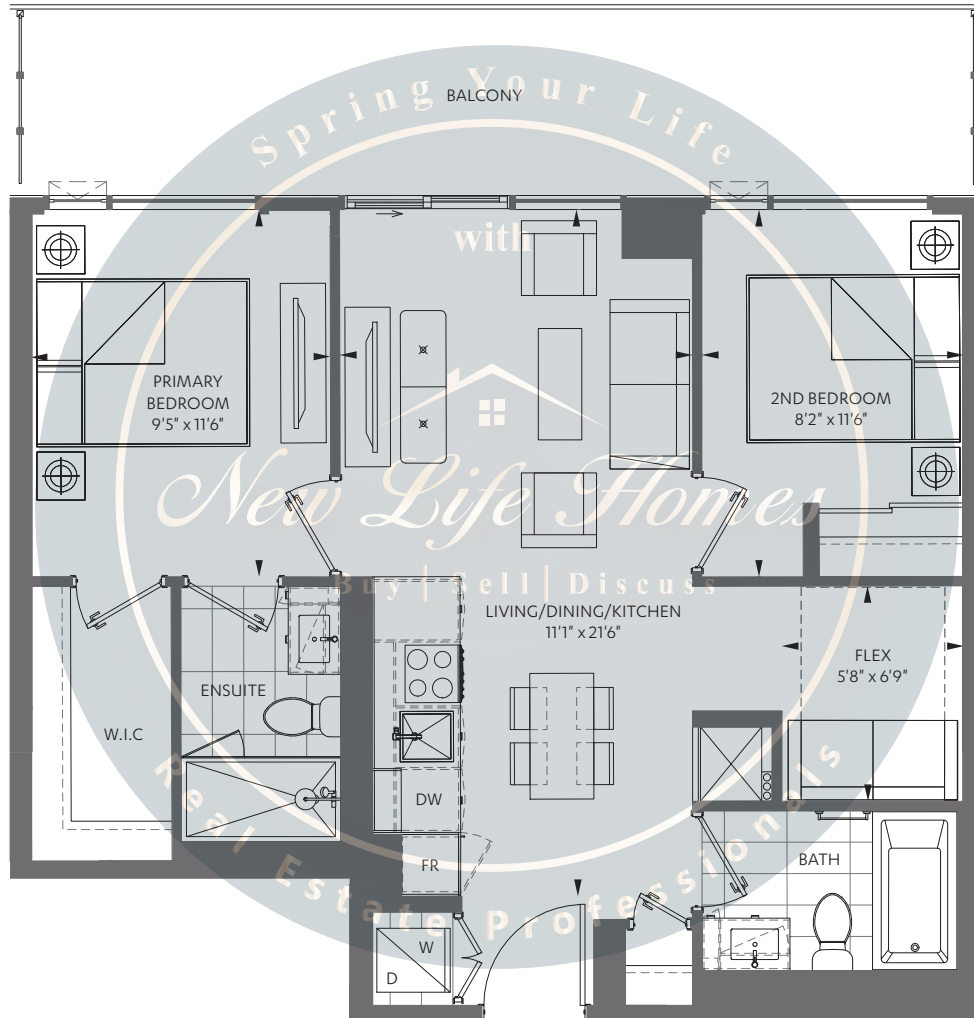

FLOOR 03

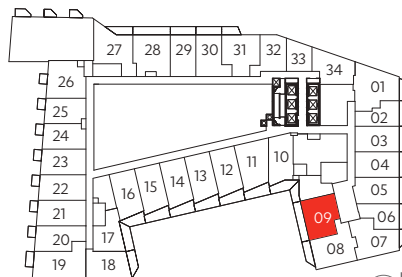

FLOOR 04

The Purchaser acknowledges and agrees that he/she has reviewed the key plan for the level on which the Unit is located, including, without limitation, the anticipated design, configuration and/or access point(s) of any exclusive use common area balcony or terrace appurtenant to the specific Unit being purchased, which design, configuration, and/or access point(s) may vary from unit to unit and/or level to level. The Purchaser acknowledges and agrees that the glass panels appurtenant to the Unit may be spandrel glass, vision glass, glazed glass, and/or such other glass as the Vendor may determine, in its sole and absolute discretion, based on the final architectural design of the building and the energy model report for the building. Exterior areas may contain architectural elements not shown on plans. Sizes and specifications are subject to change without notice. E. + O.E. March, 2024



2 BED + FLEX + 2 BATH

INTERIOR: 768 SF

EXTERIOR: 145 SF

# PE-768

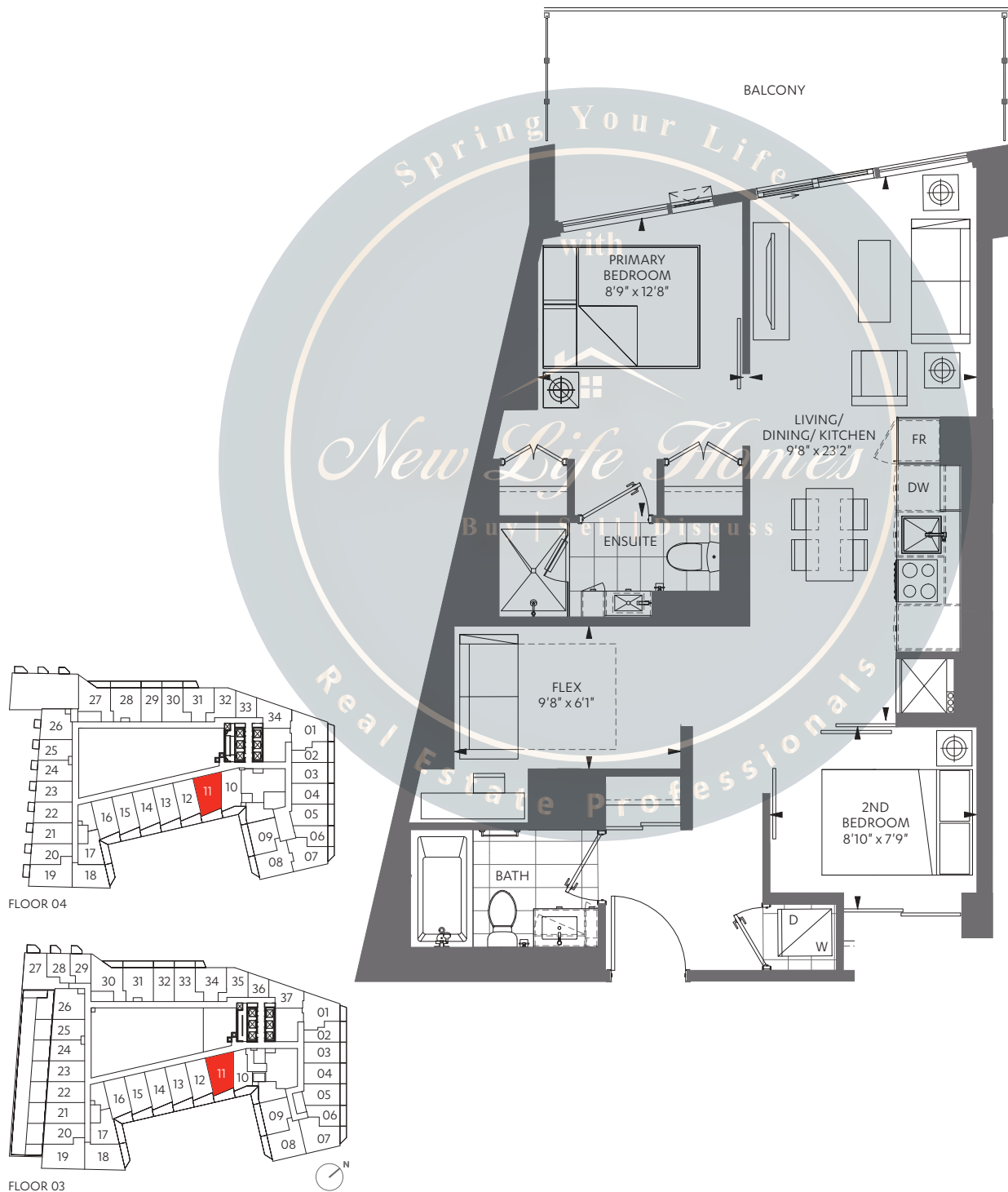

The Purchaser acknowledges and agrees that he/she has reviewed the key plan for the level on which the Unit is located, including, without limitation, the anticipated design, configuration and/or access point(s) of any exclusive use common area balcony or terrace appurtenant to the specific Unit being purchased, which design, configuration, and/or access point(s) may vary from unit to unit and/or level to level. The Purchaser acknowledges and agrees that the glass panels appurtenant to the Unit may be spandrel glass, vision glass, glazed glass, and/or such other glass as the Vendor may determine, in its sole and absolute discretion, based on the final architectural design of the building and the energy model report for the building. Exterior areas may contain architectural elements not shown on plans. Sizes and specifications are subject to change without notice. E. + O.E. March, 2024

2 BED + FLEX + 2 BATH

INTERIOR: 859 SF

EXTERIOR: 96 SF

# PE-859

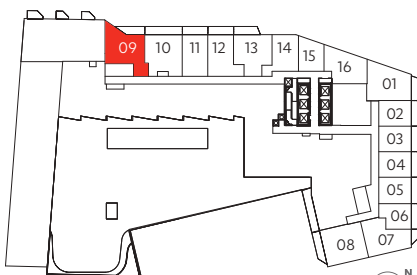
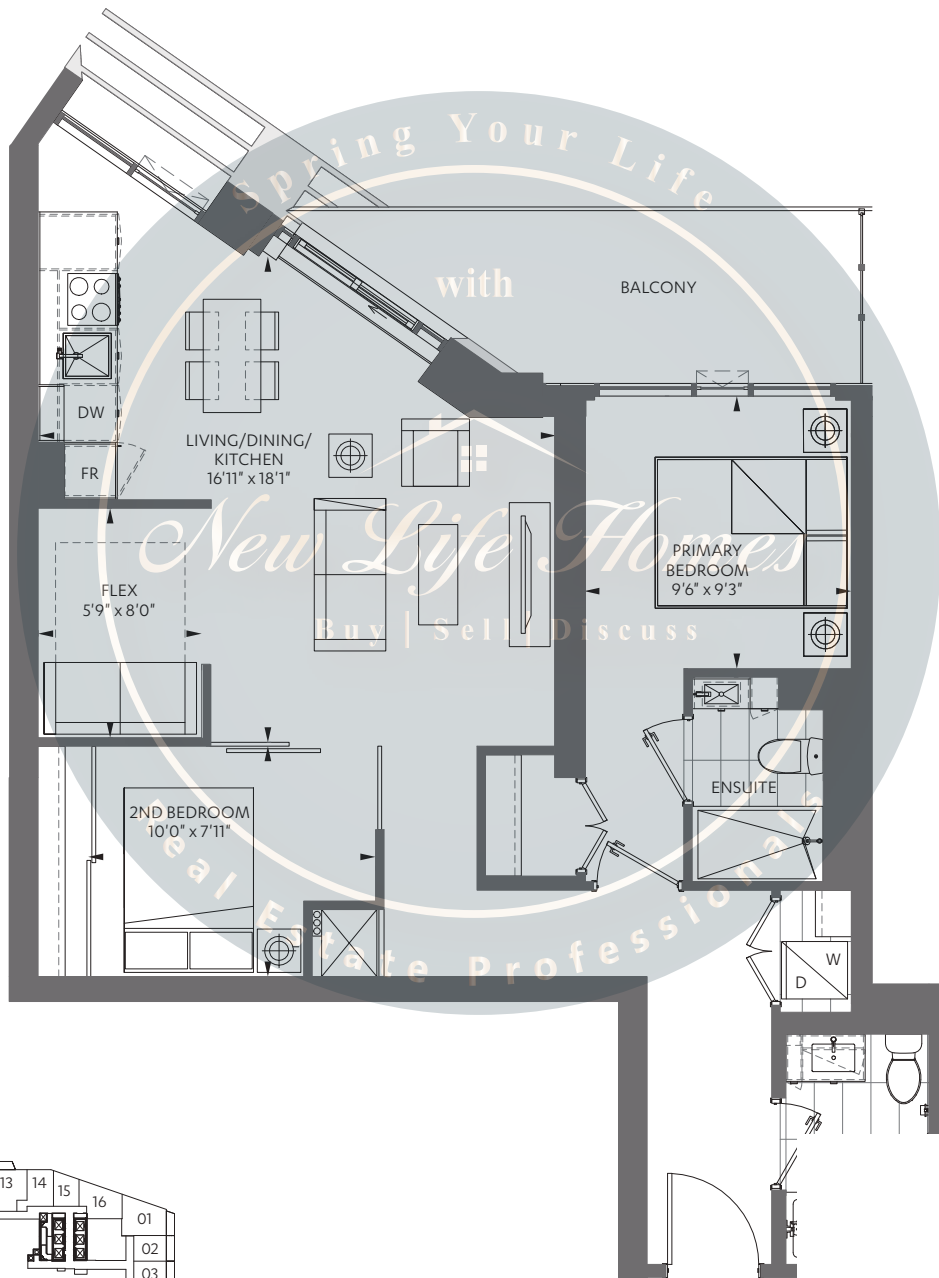

FLOOR 05

The Purchaser acknowledges and agrees that he/she has reviewed the key plan for the level on which the Unit is located, including, without limitation, the anticipated design, configuration and/or access point(s) of any exclusive use common area balcony or terrace appurtenant to the specific Unit being purchased, which design, configuration, and/or access point(s) may vary from unit to unit and/or level to level. The Purchaser acknowledges and agrees that the glass panels appurtenant to the Unit may be spandrel glass, vision glass, glazed glass, and/or such other glass as the Vendor may determine, in its sole and absolute discretion, based on the final architectural design of the building and the energy model report for the building. Exterior areas may contain architectural elements not shown on plans. Sizes and specifications are subject to change without notice. E. + O.E. March, 2024

2 BED + FLEX + 2 BATH

INTERIOR: 773 SF

EXTERIOR: 344 SF

# PE-773

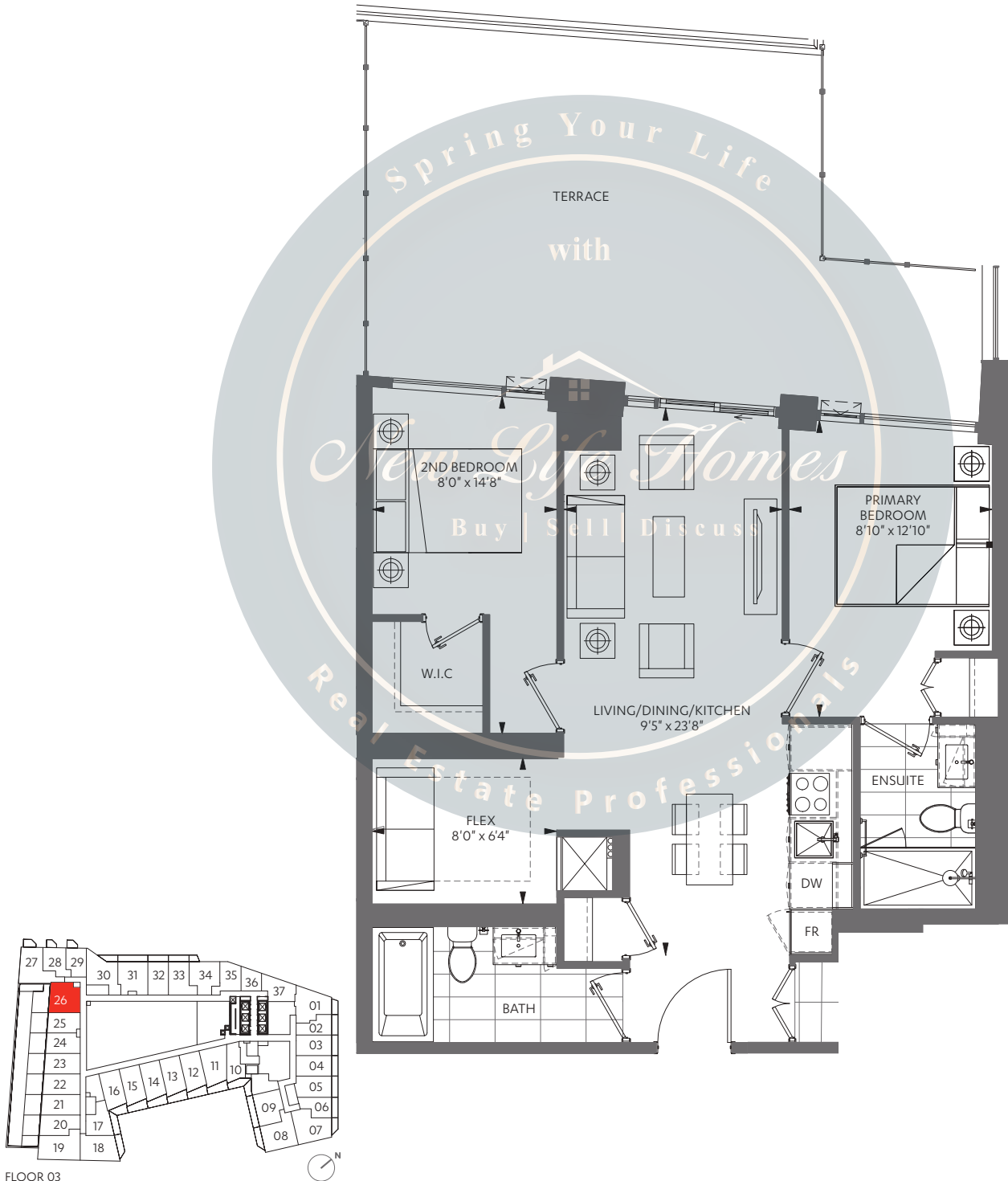

The Purchaser acknowledges and agrees that he/she has reviewed the key plan for the level on which the Unit is located, including, without limitation, the anticipated design, configuration and/or access point(s) of any exclusive use common area balcony or terrace appurtenant to the specific Unit being purchased, which design, configuration, and/or access point(s) may vary from unit to unit and/or level to level. The Purchaser acknowledges and agrees that the glass panels appurtenant to the Unit may be spandrel glass, vision glass, glazed glass, and/or such other glass as the Vendor may determine, in its sole and absolute discretion, based on the final architectural design of the building and the energy model report for the building. Exterior areas may contain architectural elements not shown on plans. Sizes and specifications are subject to change without notice. E. + O.E. March, 2024

2 BED + MEDIA + 2 BATH

INTERIOR: 671 SF

EXTERIOR: 48 SF

# PD-671

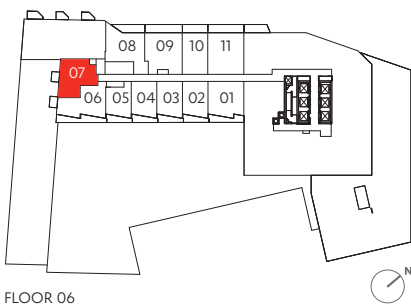
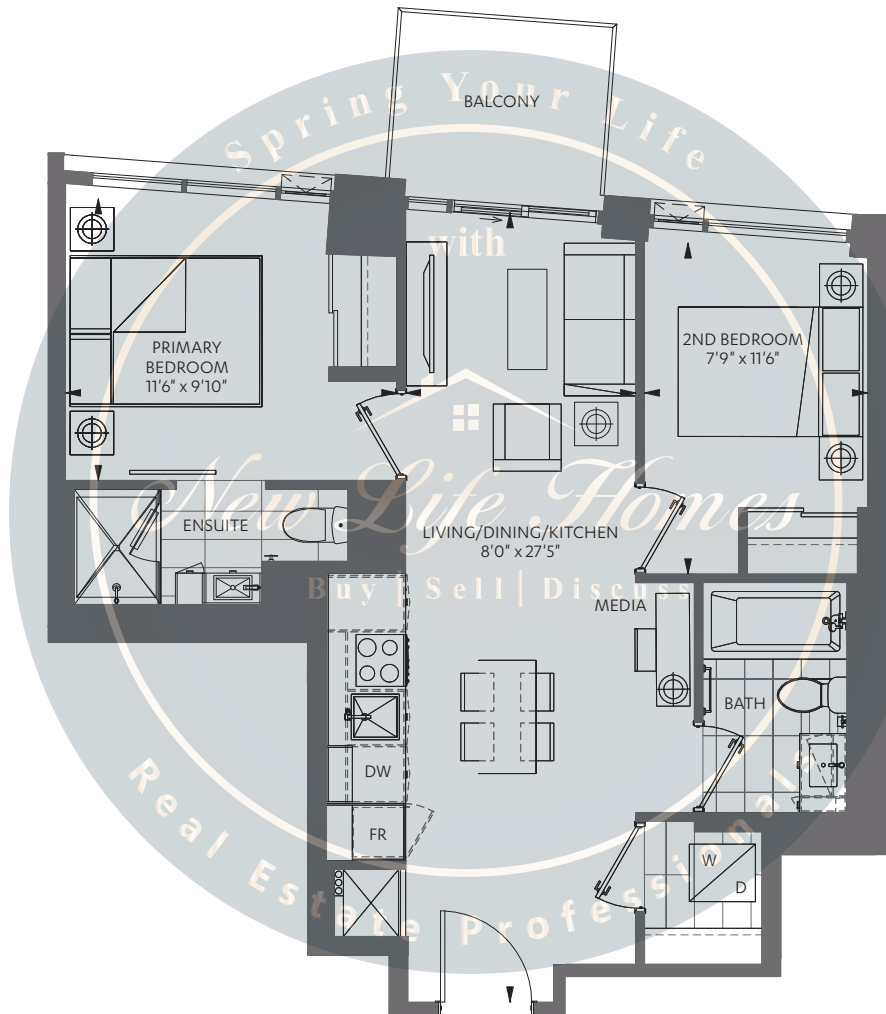

FLOOR 06

The Purchaser acknowledges and agrees that he/she has reviewed the key plan for the level on which the Unit is located, including, without limitation, the anticipated design, configuration and/or access point(s) of any exclusive use common area balcony or terrace appurtenant to the specific Unit being purchased, which design, configuration, and/or access point(s) may vary from unit to unit and/or level to level. The Purchaser acknowledges and agrees that the glass panels appurtenant to the Unit may be spandrel glass, vision glass, glazed glass, and/or such other glass as the Vendor may determine, in its sole and absolute discretion, based on the final architectural design of the building and the energy model report for the building. Exterior areas may contain architectural elements not shown on plans. Sizes and specifications are subject to change without notice. E. + O.E. March, 2024

2 BED + MEDIA + 2 BATH

INTERIOR: 639 SF

TERRACE: 289 SF

BALCONY AT FLOOR 4: 51 SF

# PD-639

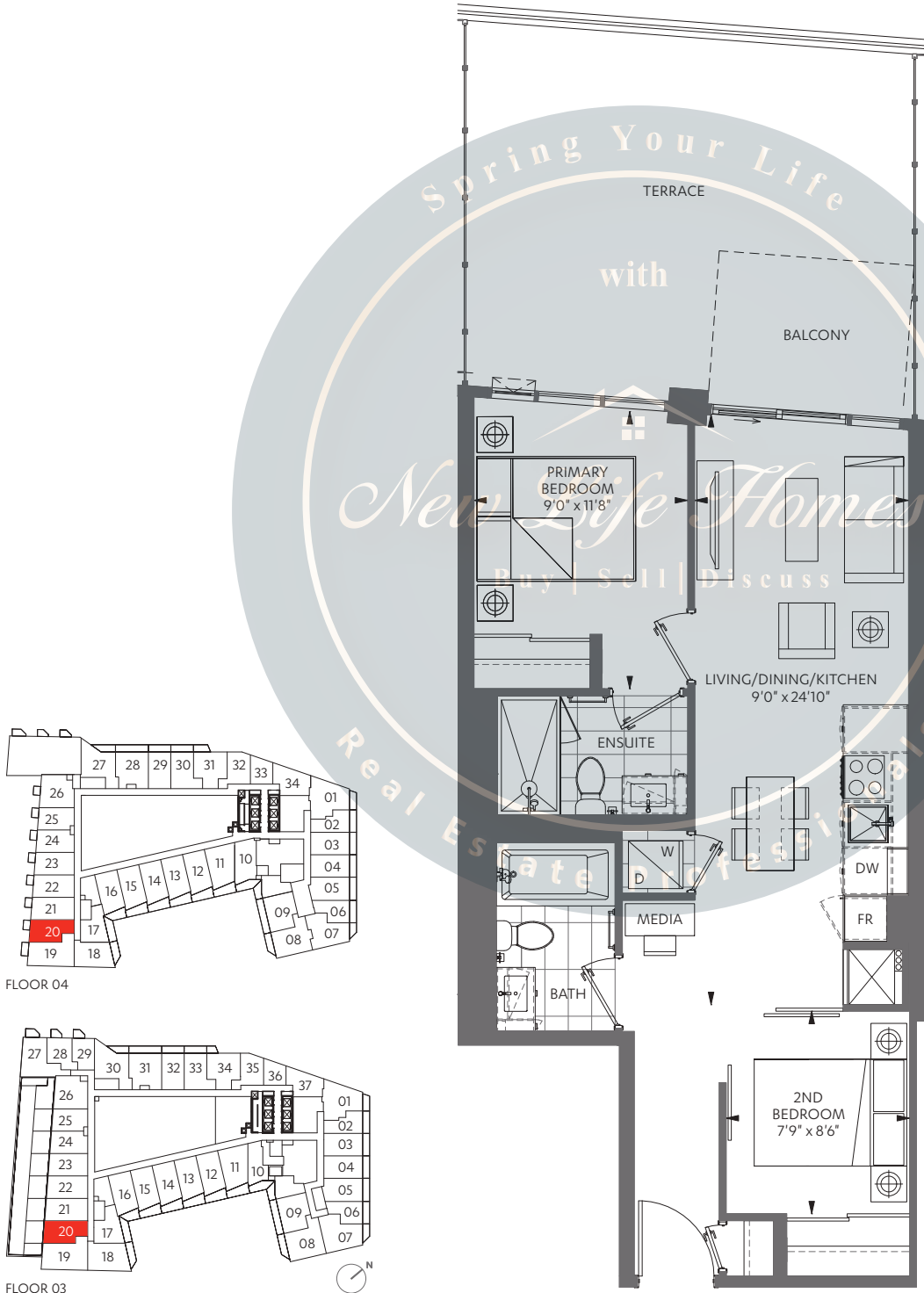

The Purchaser acknowledges and agrees that he/she has reviewed the key plan for the level on which the Unit is located, including, without limitation, the anticipated design, configuration and/or access point(s) of any exclusive use common area balcony or terrace appurtenant to the specific Unit being purchased, which design, configuration, and/or access point(s) may vary from unit to unit and/or level to level. The Purchaser acknowledges and agrees that the glass panels appurtenant to the Unit may be spandrel glass, vision glass, glazed glass, and/or such other glass as the Vendor may determine, in its sole and absolute discretion, based on the final architectural design of the building and the energy model report for the building. Exterior areas may contain architectural elements not shown on plans. Sizes and specifications are subject to change without notice. E. + O.E. March, 2024

3 BED + DEN + 2 BATH

INTERIOR: 813 SF

BALCONY AT FLOOR 3: 168 SF

BALCONY AT FLOOR 4, 5, 6: 160 SF

# PG-813

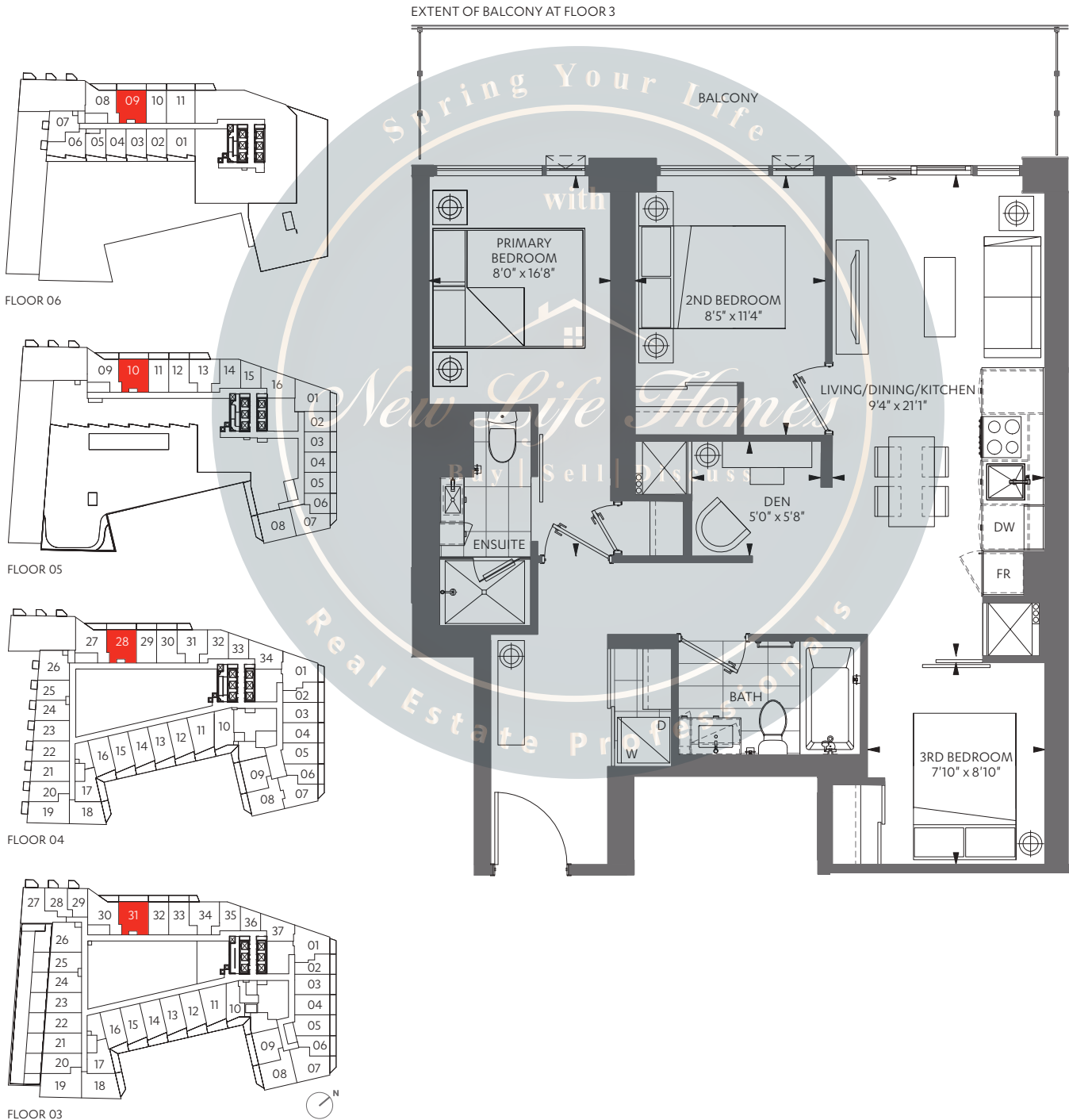

The Purchaser acknowledges and agrees that he/she has reviewed the key plan for the level on which the Unit is located, including, without limitation, the anticipated design, configuration and/or access point(s) of any exclusive use common area balcony or terrace appurtenant to the specific Unit being purchased, which design, configuration, and/or access point(s) may vary from unit to unit and/or level to level. The Purchaser acknowledges and agrees that the glass panels appurtenant to the Unit may be spandrel glass, vision glass, glazed glass, and/or such other glass as the Vendor may determine, in its sole and absolute discretion, based on the final architectural design of the building and the energy model report for the building. Exterior areas may contain architectural elements not shown on plans. Sizes and specifications are subject to change without notice. E. + O.E. March, 2024

3 BED + DEN + 2 BATH

INTERIOR: 856 SF

EXTERIOR: 154 SF

# PG-856

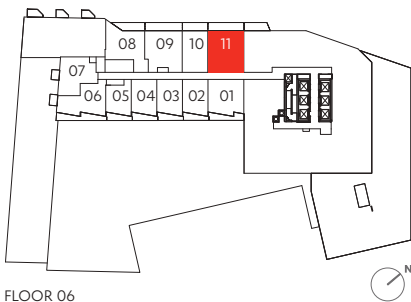
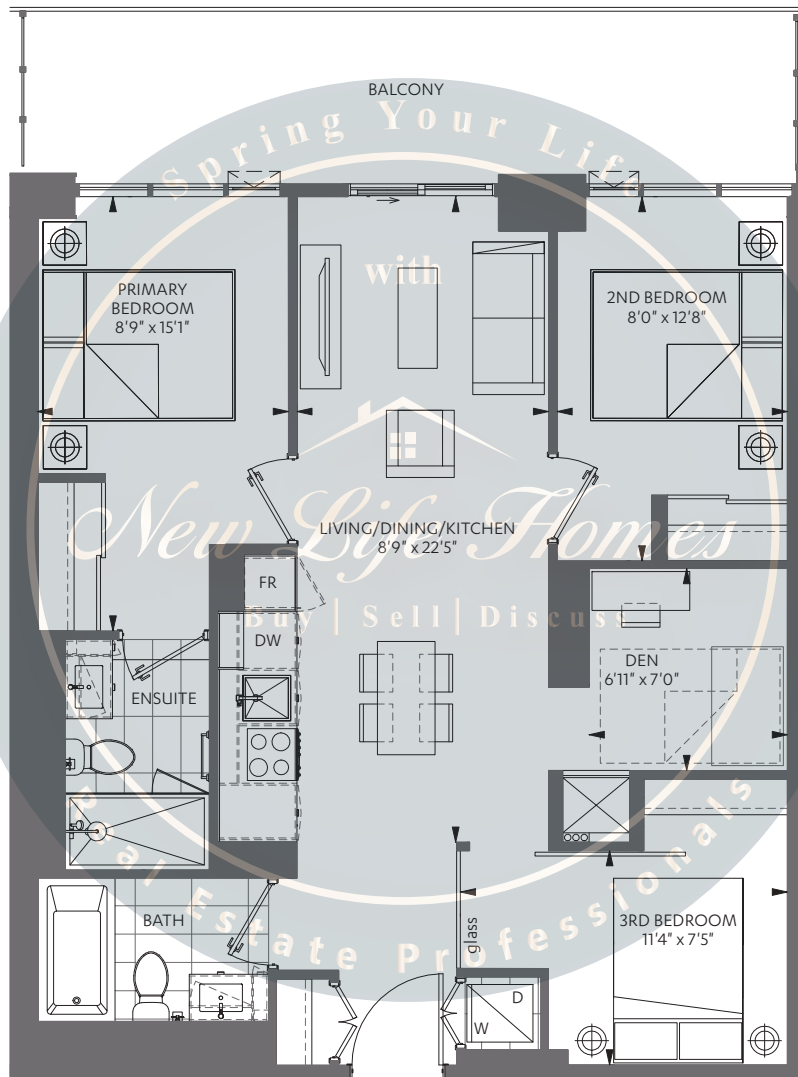

FLOOR 06

The Purchaser acknowledges and agrees that he/she has reviewed the key plan for the level on which the Unit is located, including, without limitation, the anticipated design, configuration and/or access point(s) of any exclusive use common area balcony or terrace appurtenant to the specific Unit being purchased, which design, configuration, and/or access point(s) may vary from unit to unit and/or level to level. The Purchaser acknowledges and agrees that the glass panels appurtenant to the Unit may be spandrel glass, vision glass, glazed glass, and/or such other glass as the Vendor may determine, in its sole and absolute discretion, based on the final architectural design of the building and the energy model report for the building. Exterior areas may contain architectural elements not shown on plans. Sizes and specifications are subject to change without notice. E. + O.E. March, 2024

3 BED + DEN + 2 BATH

INTERIOR: 900 SF

EXTERIOR: 79 SF

# PG-900

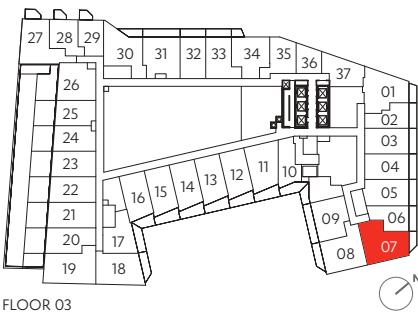
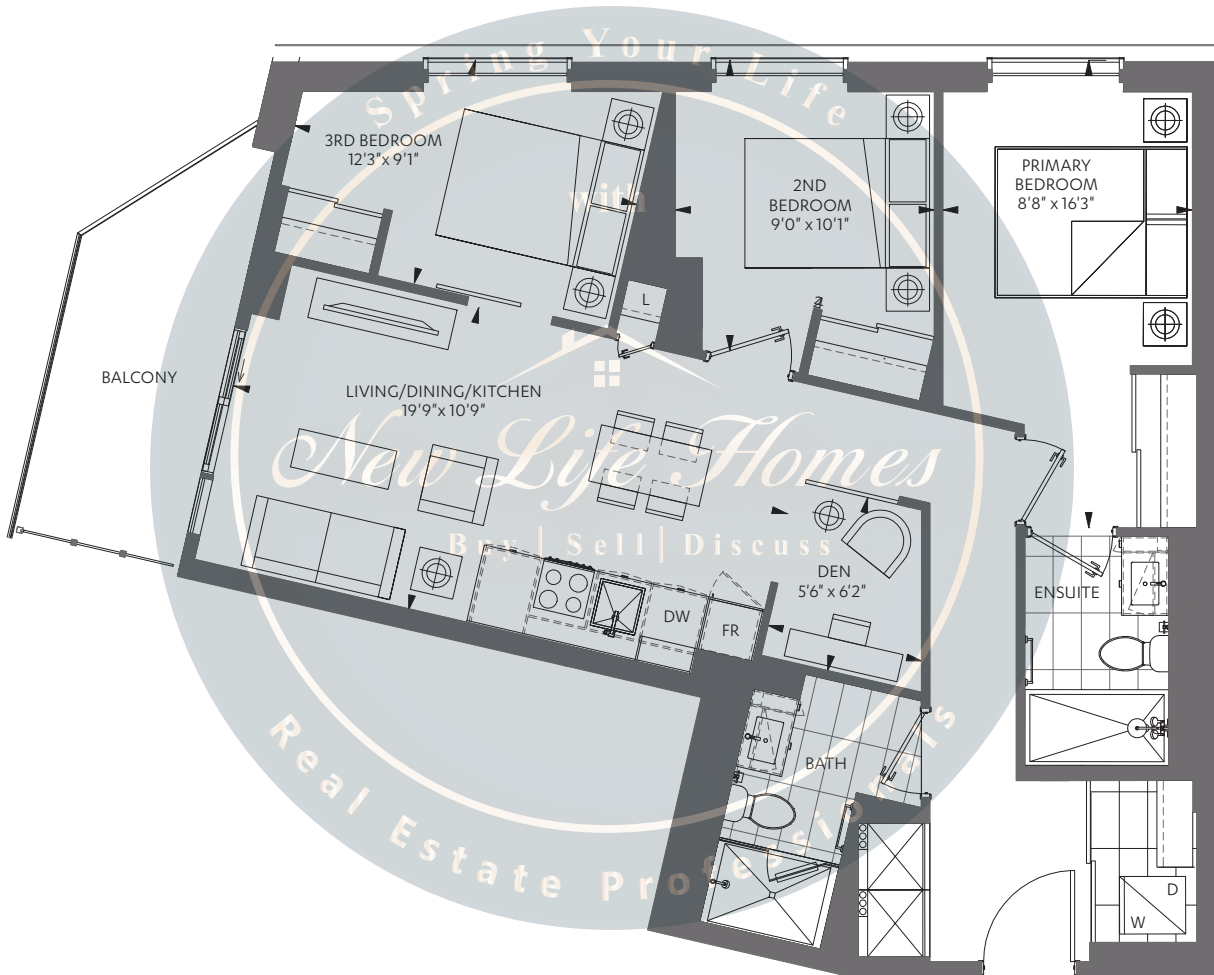

FLOOR 03

The Purchaser acknowledges and agrees that he/she has reviewed the key plan for the level on which the Unit is located, including, without limitation, the anticipated design, configuration and/or access point(s) of any exclusive use common area balcony or terrace appurtenant to the specific Unit being purchased, which design, configuration, and/or access point(s) may vary from unit to unit and/or level to level. The Purchaser acknowledges and agrees that the glass panels appurtenant to the Unit may be spandrel glass, vision glass, glazed glass, and/or such other glass as the Vendor may determine, in its sole and absolute discretion, based on the final architectural design of the building and the energy model report for the building. Exterior areas may contain architectural elements not shown on plans. Sizes and specifications are subject to change without notice. E. + O.E. March, 2024



3 BED + DEN + 2 BATH (BF)

INTERIOR: 989 SF

EXTERIOR: 152 SF

# PG-989

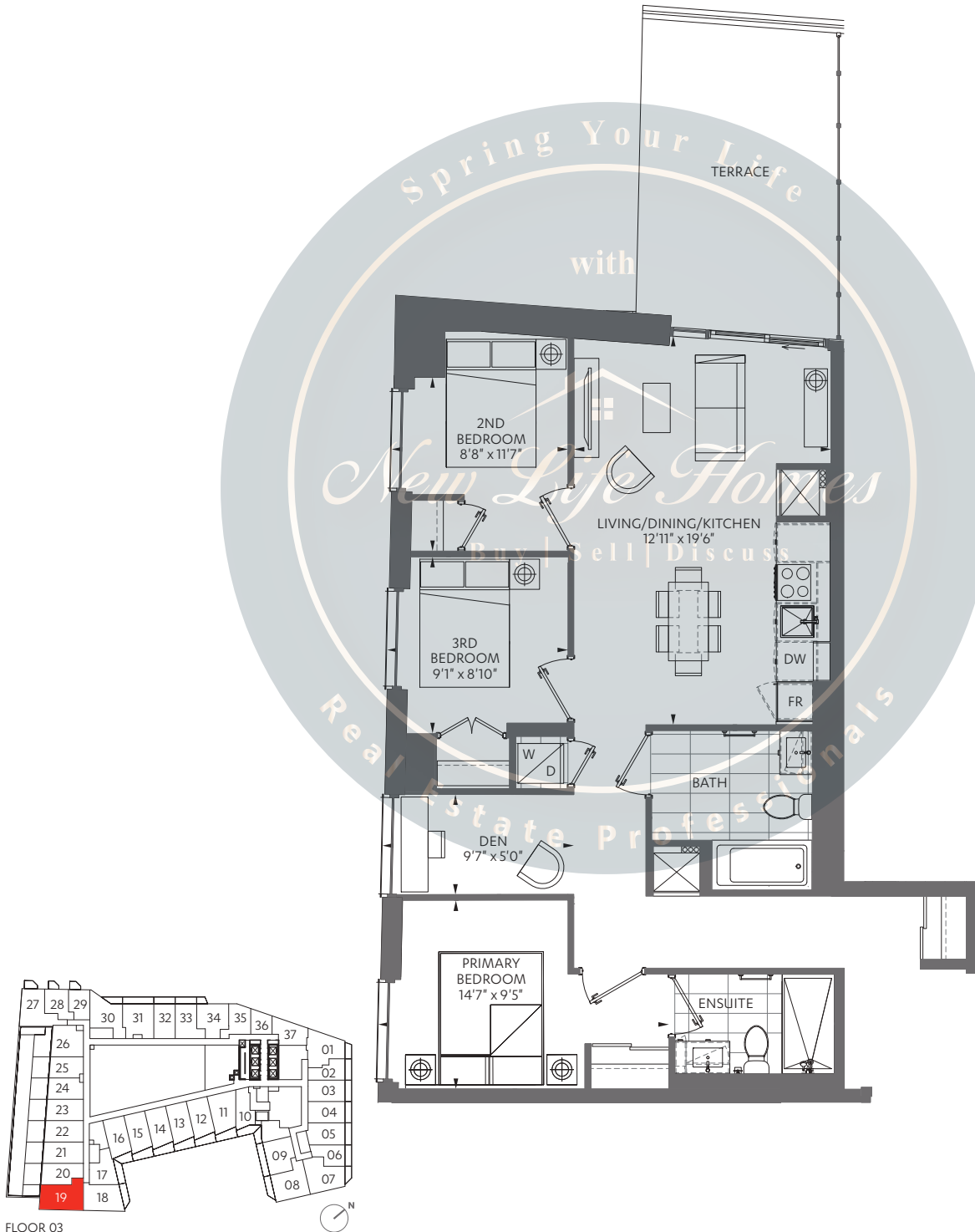

The Purchaser acknowledges and agrees that he/she has reviewed the key plan for the level on which the Unit is located, including, without limitation, the anticipated design, configuration and/or access point(s) of any exclusive use common area balcony or terrace appurtenant to the specific Unit being purchased, which design, configuration, and/or access point(s) may vary from unit to unit and/or level to level. The Purchaser acknowledges and agrees that the glass panels appurtenant to the Unit may be spandrel glass, vision glass, glazed glass, and/or such other glass as the Vendor may determine, in its sole and absolute discretion, based on the final architectural design of the building and the energy model report for the building. Exterior areas may contain architectural elements not shown on plans. Sizes and specifications are subject to change without notice. E. + O.E. March, 2024

3 BED + FLEX + 2 BATH

INTERIOR: 885 SF

EXTERIOR: 132 SF

# PC-885

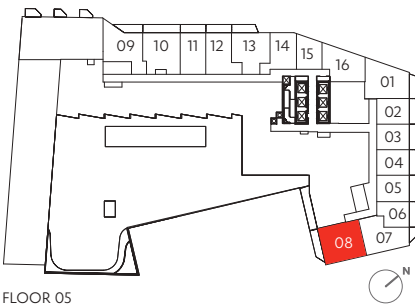
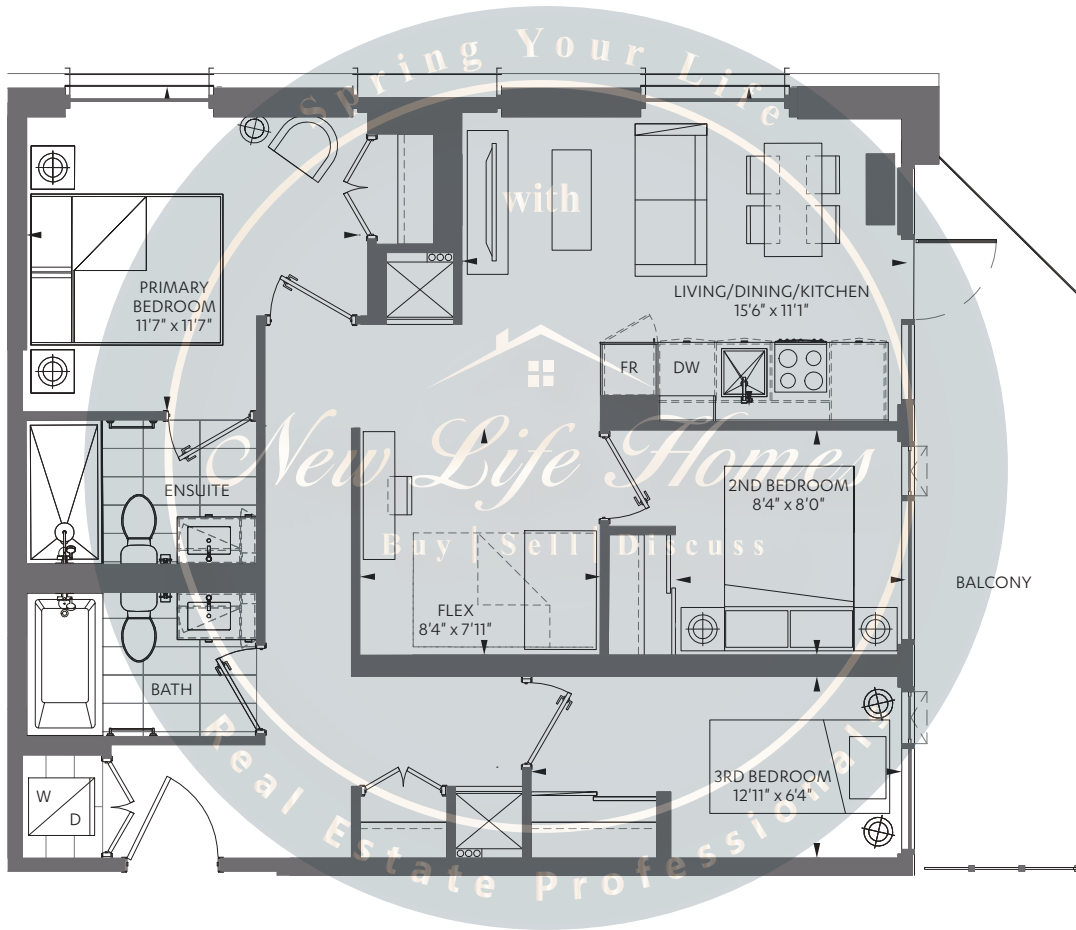

FLOOR 05

The Purchaser acknowledges and agrees that he/she has reviewed the key plan for the level on which the Unit is located, including, without limitation, the anticipated design, configuration and/or access point(s) of any exclusive use common area balcony or terrace appurtenant to the specific Unit being purchased, which design, configuration, and/or access point(s) may vary from unit to unit and/or level to level. The Purchaser acknowledges and agrees that the glass panels appurtenant to the Unit may be spandrel glass, vision glass, glazed glass, and/or such other glass as the Vendor may determine, in its sole and absolute discretion, based on the final architectural design of the building and the energy model report for the building. Exterior areas may contain architectural elements not shown on plans. Sizes and specifications are subject to change without notice. E. + O.E. March, 2024

3 BED + MEDIA + 2 BATH (BF)

INTERIOR: 858 SF

EXTERIOR: 81 SF

# PF-858

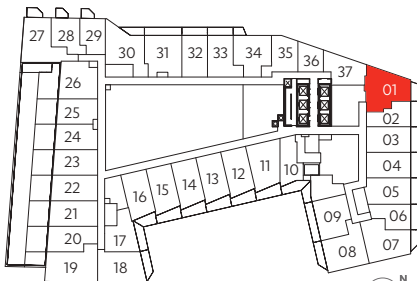
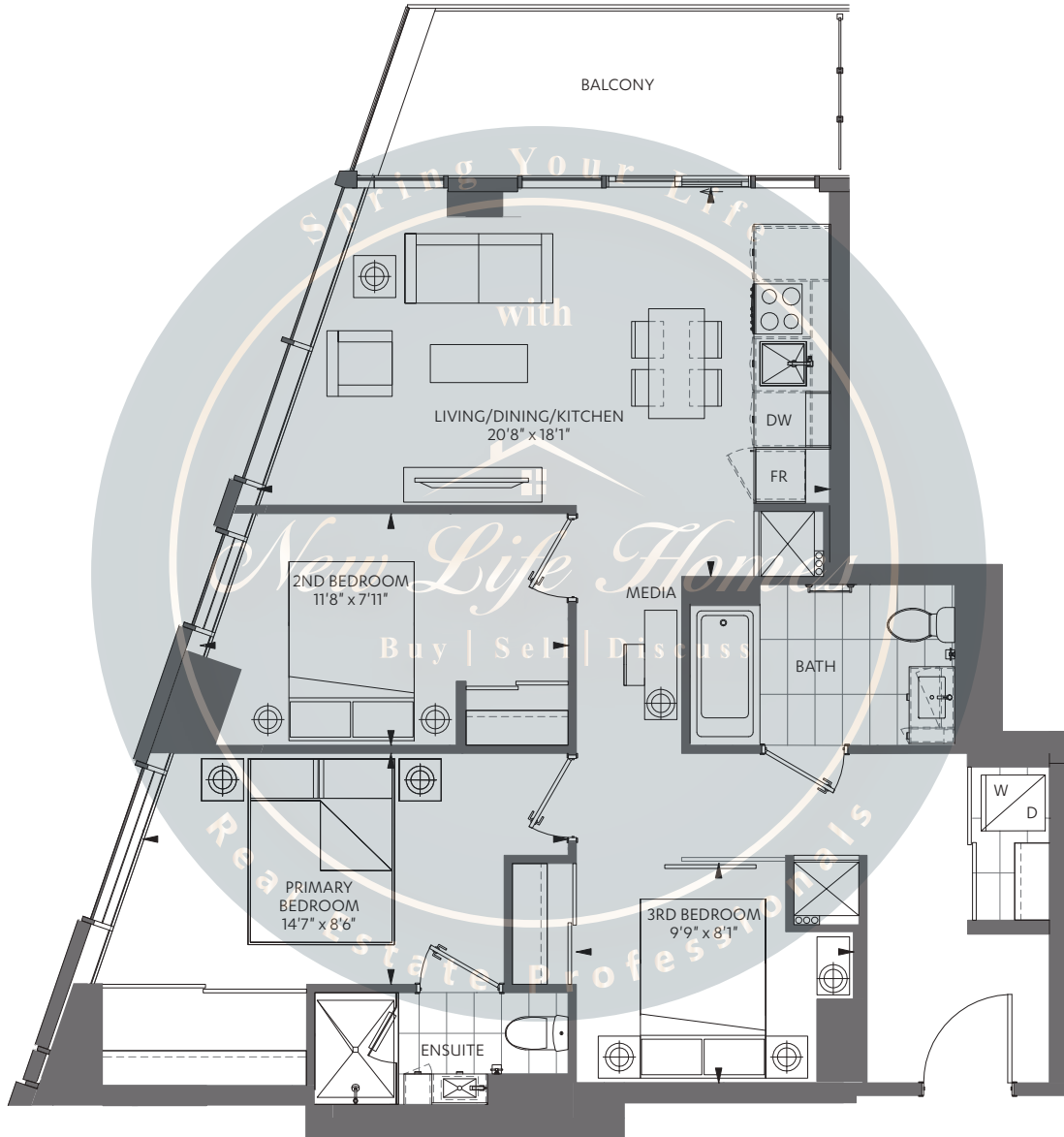

FLOOR 03

The Purchaser acknowledges and agrees that he/she has reviewed the key plan for the level on which the Unit is located, including, without limitation, the anticipated design, configuration and/or access point(s) of any exclusive use common area balcony or terrace appurtenant to the specific Unit being purchased, which design, configuration, and/or access point(s) may vary from unit to unit and/or level to level. The Purchaser acknowledges and agrees that the glass panels appurtenant to the Unit may be spandrel glass, vision glass, glazed glass, and/or such other glass as the Vendor may determine, in its sole and absolute discretion, based on the final architectural design of the building and the energy model report for the building. Exterior areas may contain architectural elements not shown on plans. Sizes and specifications are subject to change without notice. E. + O.E. March, 2024

3 BED + MEDIA + 2 BATH (BF)

INTERIOR: 864 SF

EXTERIOR: 94 SF

# PF-864

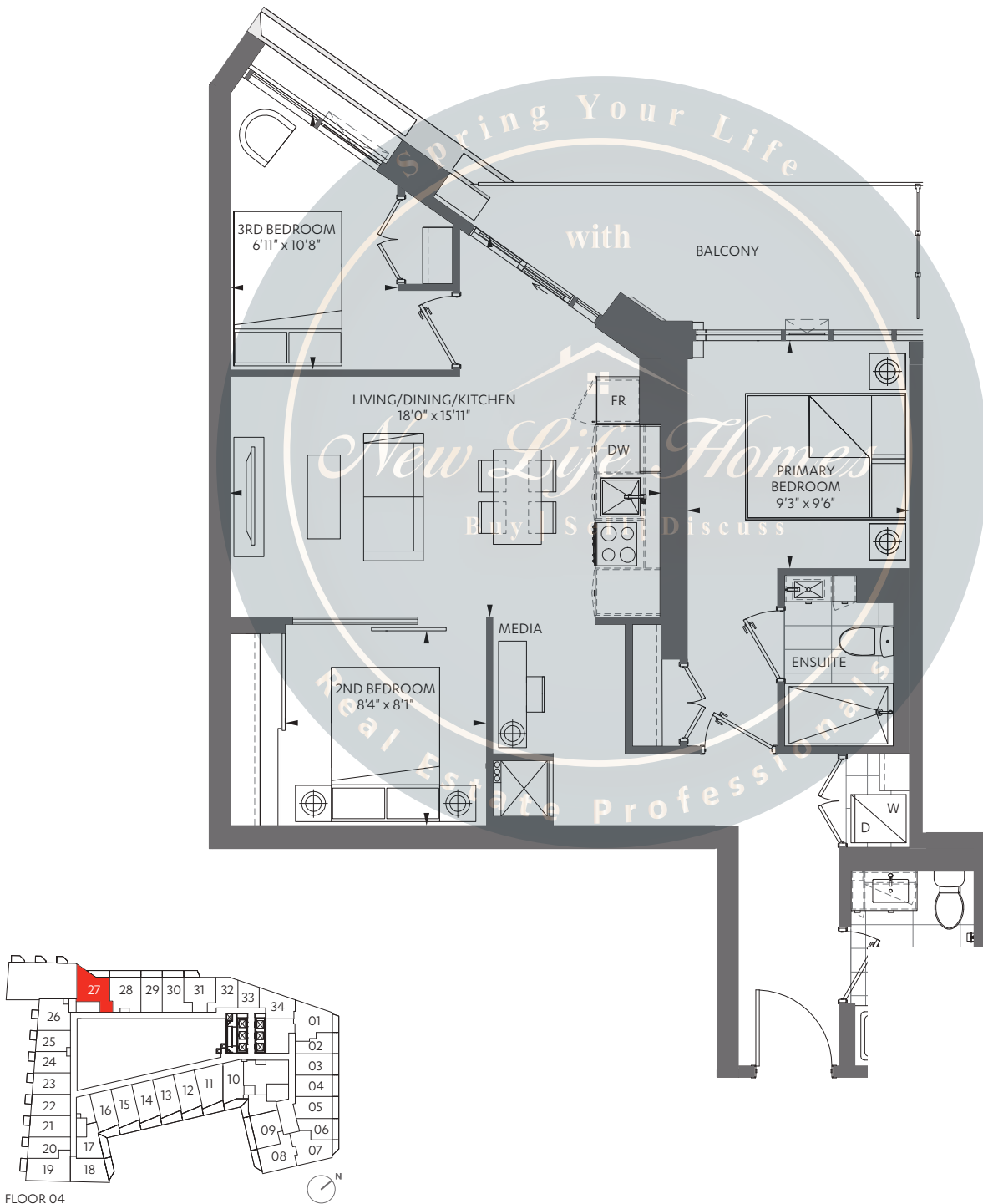

The Purchaser acknowledges and agrees that he/she has reviewed the key plan for the level on which the Unit is located, including, without limitation, the anticipated design, configuration and/or access point(s) of any exclusive use common area balcony or terrace appurtenant to the specific Unit being purchased, which design, configuration, and/or access point(s) may vary from unit to unit and/or level to level. The Purchaser acknowledges and agrees that the glass panels appurtenant to the Unit may be spandrel glass, vision glass, glazed glass, and/or such other glass as the Vendor may determine, in its sole and absolute discretion, based on the final architectural design of the building and the energy model report for the building. Exterior areas may contain architectural elements not shown on plans. Sizes and specifications are subject to change without notice. E. + O.E. March, 2024

3 BED + MEDIA + 2 BATH

INTERIOR: 843 SF

EXTERIOR: 133 SF

# PF-843

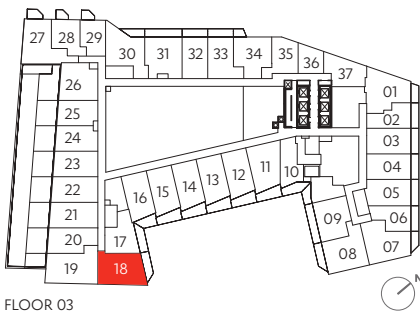
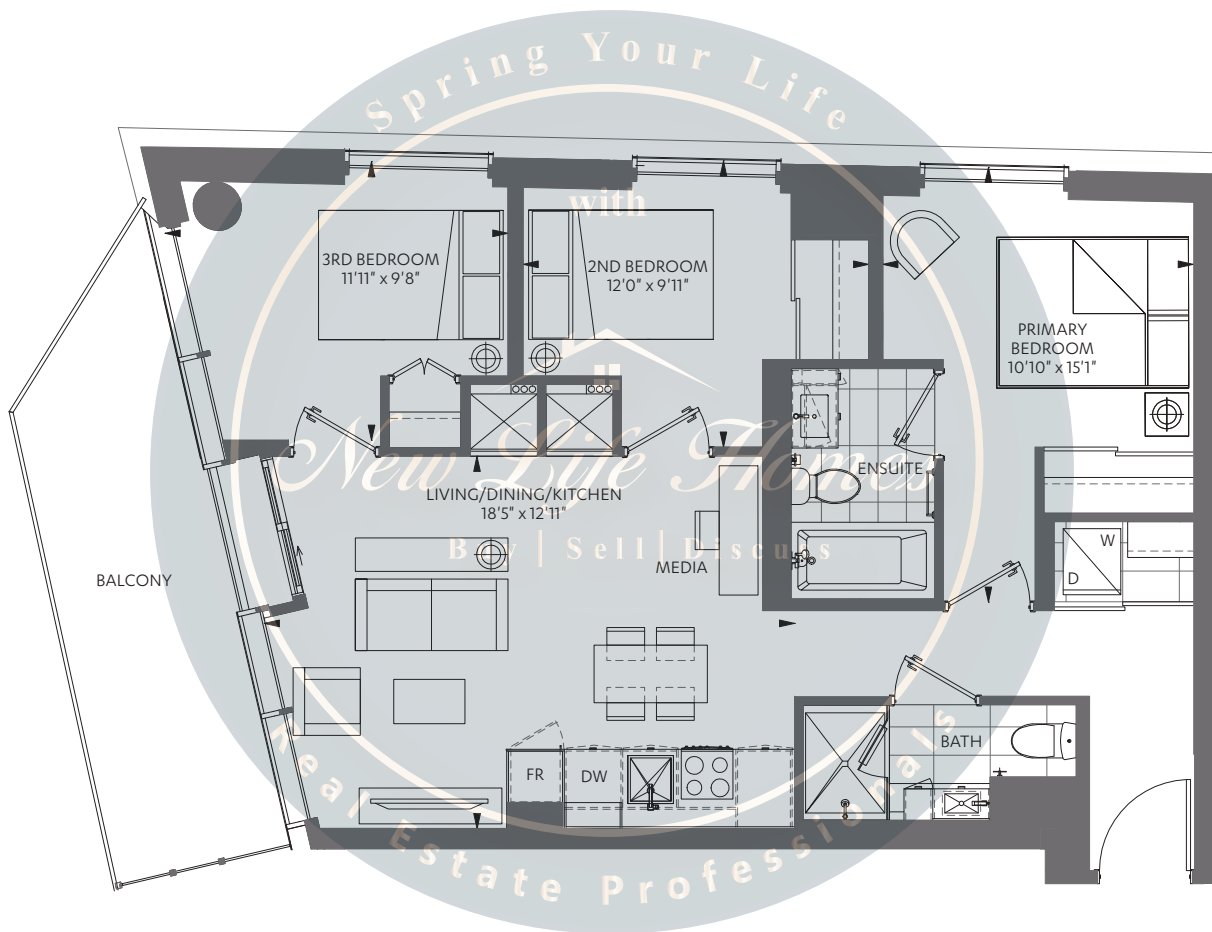

FLOOR 03

The Purchaser acknowledges and agrees that he/she has reviewed the key plan for the level on which the Unit is located, including, without limitation, the anticipated design, configuration and/or access point(s) of any exclusive use common area balcony or terrace appurtenant to the specific Unit being purchased, which design, configuration, and/or access point(s) may vary from unit to unit and/or level to level. The Purchaser acknowledges and agrees that the glass panels appurtenant to the Unit may be spandrel glass, vision glass, glazed glass, and/or such other glass as the Vendor may determine, in its sole and absolute discretion, based on the final architectural design of the building and the energy model report for the building. Exterior areas may contain architectural elements not shown on plans. Sizes and specifications are subject to change without notice. E. + O.E. March, 2024

3 BED + MEDIA + 2 BATH (BF)

INTERIOR: 881 SF

EXTERIOR: 117 SF

# PF-881

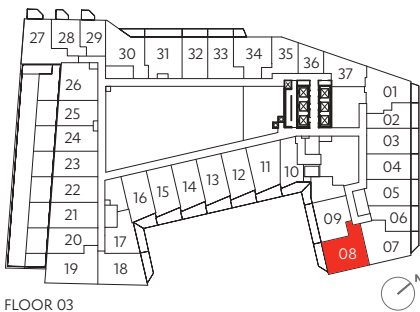
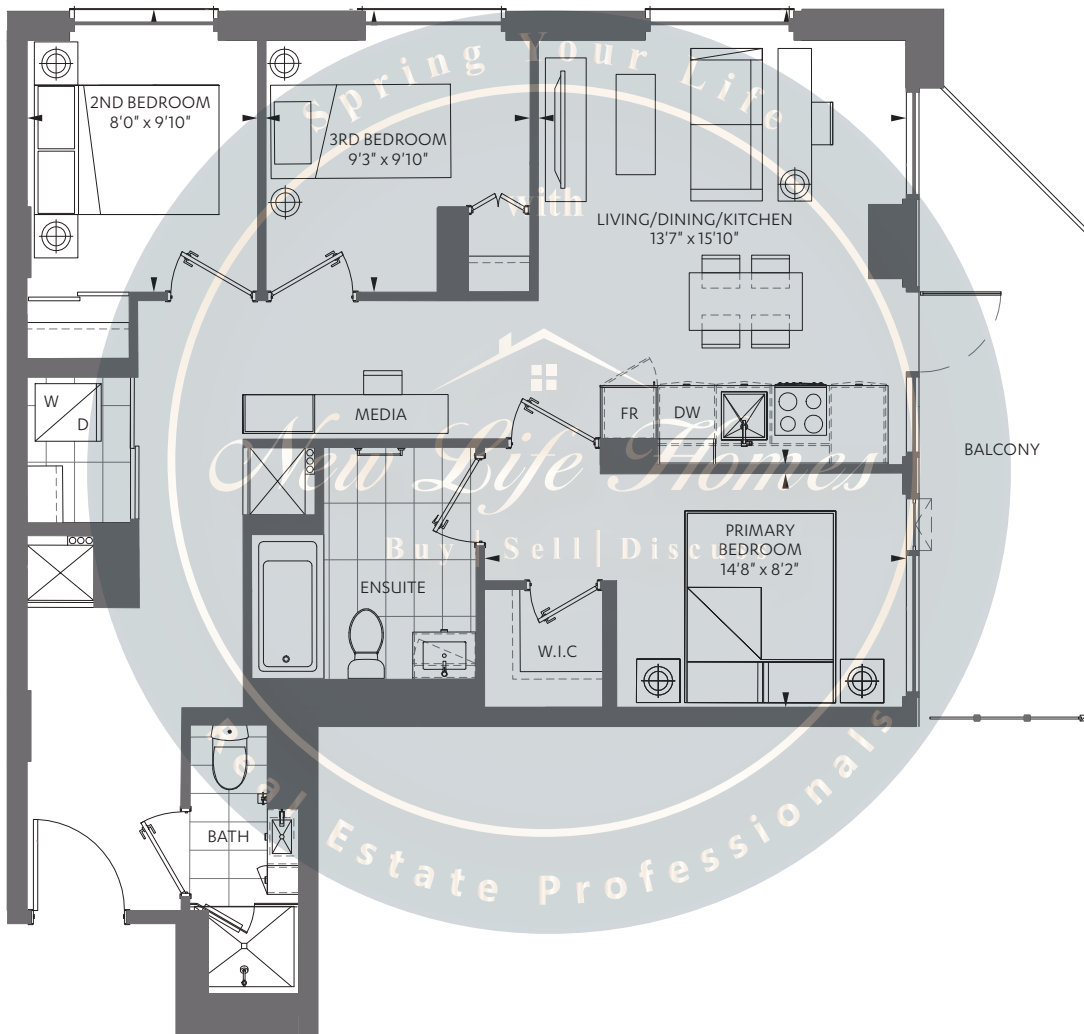

FLOOR 03

The Purchaser acknowledges and agrees that he/she has reviewed the key plan for the level on which the Unit is located, including, without limitation, the anticipated design, configuration and/or access point(s) of any exclusive use common area balcony or terrace appurtenant to the specific Unit being purchased, which design, configuration, and/or access point(s) may vary from unit to unit and/or level to level. The Purchaser acknowledges and agrees that the glass panels appurtenant to the Unit may be spandrel glass, vision glass, glazed glass, and/or such other glass as the Vendor may determine, in its sole and absolute discretion, based on the final architectural design of the building and the energy model report for the building. Exterior areas may contain architectural elements not shown on plans. Sizes and specifications are subject to change without notice. E. + O.E. March, 2024