

K O L K A T A

S T U D I O

S O U T H F A C I N G

I N T E R I O R 4 2 8 S Q . F T . | E X T E R I O R 3 7 S Q . F T .

T O T A L 4 6 5 S Q . F T .

A L L U R E

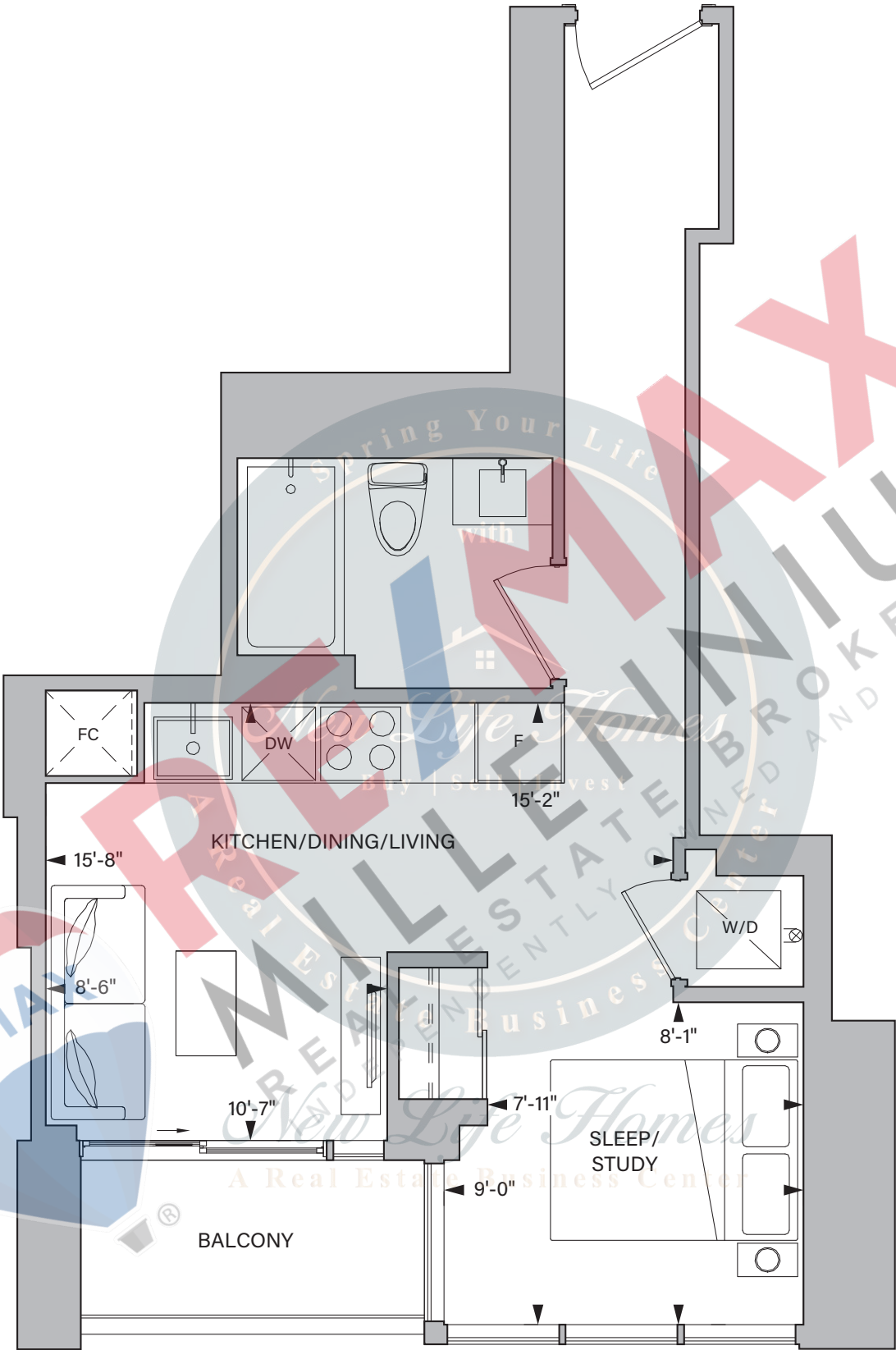

FLOOR 8

FLOOR 9

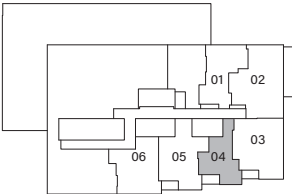

All drawings, illustrations, renderings, and views from (or of) proposed buildings shown on any brochures, advertisements, scale models, and/or marketing materials are conceptual artist's renderings only and the vendor makes no representation or warranty relating to same. Any stated areas and/or dimensions shown are approximate only and subject to normal construction variances. Actual usable floor space may vary from any stated or depicted floor area and the unit shall be measured in accordance with the provisions set out in HCRA Directive - Floor Area Calculations. Any and all measurements and/or specifications are subject to change without notice. Without limiting the foregoing, the purchaser is advised that the design, finishes, and specifications of the balcony appurtenant to the unit may vary from the design and/or finishes shown on the marketing drawing, depending on the location of the unit being purchased within the key plan and the building, and the purchaser expressly acknowledges and consents to such variation. The layout of the suite may be reversed depending on the location of the unit within the project. Any furniture depicted is for illustration purposes only and does not necessarily reflect the fixtures, finishes, appliances, and/or electrical plan of the unit and is not included in the purchase price. The view from or through the windows to the exterior may be partially obstructed by materials affixed to the exterior cladding of the building as part of an overall design element and/or interior structural columns that may be required pursuant to the recommendations of the project's engineers. Ceiling heights are subject to bulkheads, exposed ducts, dropped ceilings and structural beams, as applicable pursuant to the plans. All features and finishes are subject to change without notice. E.&O.E. November 2023.

MONTREAL

STUDIO

SOUTH FACING

INTERIOR 434 SQ.FT. | EXTERIOR 37 SQ.FT.

TOTAL 471 SQ.FT.

ALLURE

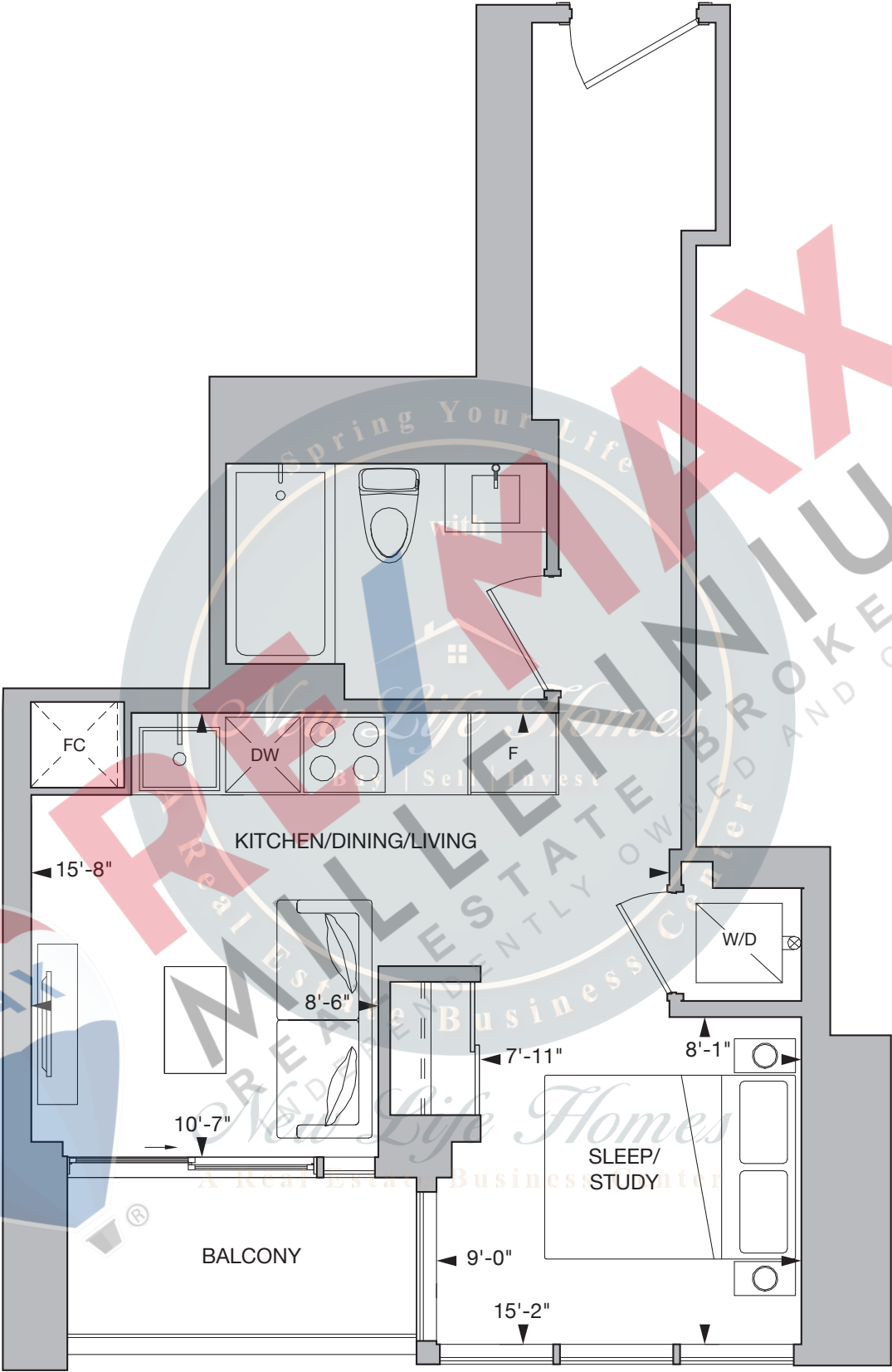

FLOORS

12-19, 21-29, 31-39, 41, 42

FLOORS 20, 30, 40

FLOOR 43



All drawings, illustrations, renderings, and views from (or of) proposed buildings shown on any brochures, advertisements, scale models, and/or marketing materials are conceptual artist's renderings only and the vendor makes no representation or warranty relating to same. Any stated areas and/or dimensions shown are approximate only and subject to normal construction variances. Actual usable floor space may vary from any stated or depicted floor area and the unit shall be measured in accordance with the provisions set out in HCRA Directive - Floor Area Calculations. Any and all measurements and/or specifications are subject to change without notice. Without limiting the foregoing, the purchaser is advised that the design, finishes, and specifications of the balcony appurtenant to the unit may vary from the design and/or finishes shown on the marketing drawing, depending on the location of the unit being purchased within the key plan and the building, and the purchaser expressly acknowledges and consents to such variation. The layout of the suite may be reversed depending on the location of the unit within the project. Any furniture depicted is for illustration purposes only and does not necessarily reflect the fixtures, finishes, appliances, and/or electrical plan of the unit and is not included in the purchase price. The view from or through the windows to the exterior may be partially obstructed by materials affixed to the exterior cladding of the building as part of an overall design element and/or interior structural columns that may be required pursuant to the recommendations of the project's engineers. Ceiling heights are subject to bulkheads, exposed ducts, dropped ceilings and structural beams, as applicable pursuant to the plans. All features and finishes are subject to change without notice. E.&O.E. November 2023.

PENANG

STUDIO

SOUTH FACING

INTERIOR 434 SQ.FT. | EXTERIOR 37 SQ.FT.

TOTAL 471 SQ.FT.

A L L U R E

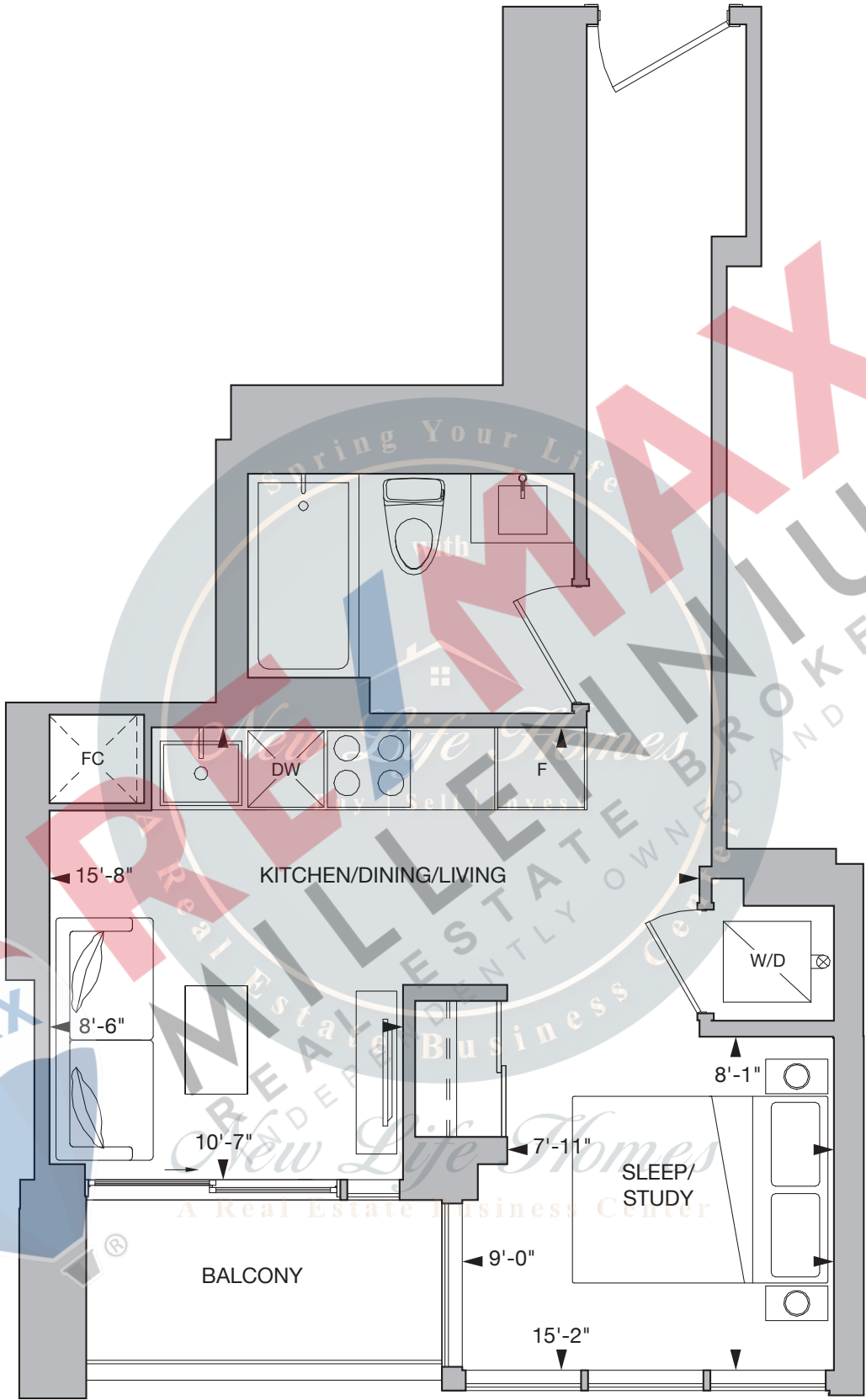

FLOOR 7



FLOOR 10



FLOOR 11



All drawings, illustrations, renderings, and views from (or of) proposed buildings shown on any brochures, advertisements, scale models, and/or marketing materials are conceptual artist's renderings only and the vendor makes no representation or warranty relating to same. Any stated areas and/or dimensions shown are approximate only and subject to normal construction variances. Actual usable floor space may vary from any stated or depicted floor area and the unit shall be measured in accordance with the provisions set out in HCRA Directive - Floor Area Calculations. Any and all measurements and/or specifications are subject to change without notice. Without limiting the foregoing, the purchaser is advised that the design, finishes, and specifications of the balcony appurtenant to the unit may vary from the design and/or finishes shown on the marketing drawing, depending on the location of the unit being purchased within the key plan and the building, and the purchaser expressly acknowledges and consents to such variation. The layout of the suite may be reversed depending on the location of the unit within the project. Any furniture depicted is for illustration purposes only and does not necessarily reflect the fixtures, finishes, appliances, and/or electrical plan of the unit and is not included in the purchase price. The view from or through the windows to the exterior may be partially obstructed by materials affixed to the exterior cladding of the building as part of an overall design element and/or interior structural columns that may be required pursuant to the recommendations of the project's engineers. Ceiling heights are subject to bulkheads, exposed ducts, dropped ceilings and structural beams, as applicable pursuant to the plans. All features and finishes are subject to change without notice. E.&O.E. November 2023.

STOCKHOLM

1 BEDROOM, 1 BATHROOM
NORTH FACING
INTERIOR 501 SQ.FT.
TOTAL 501 SQ.FT.

ALLURE

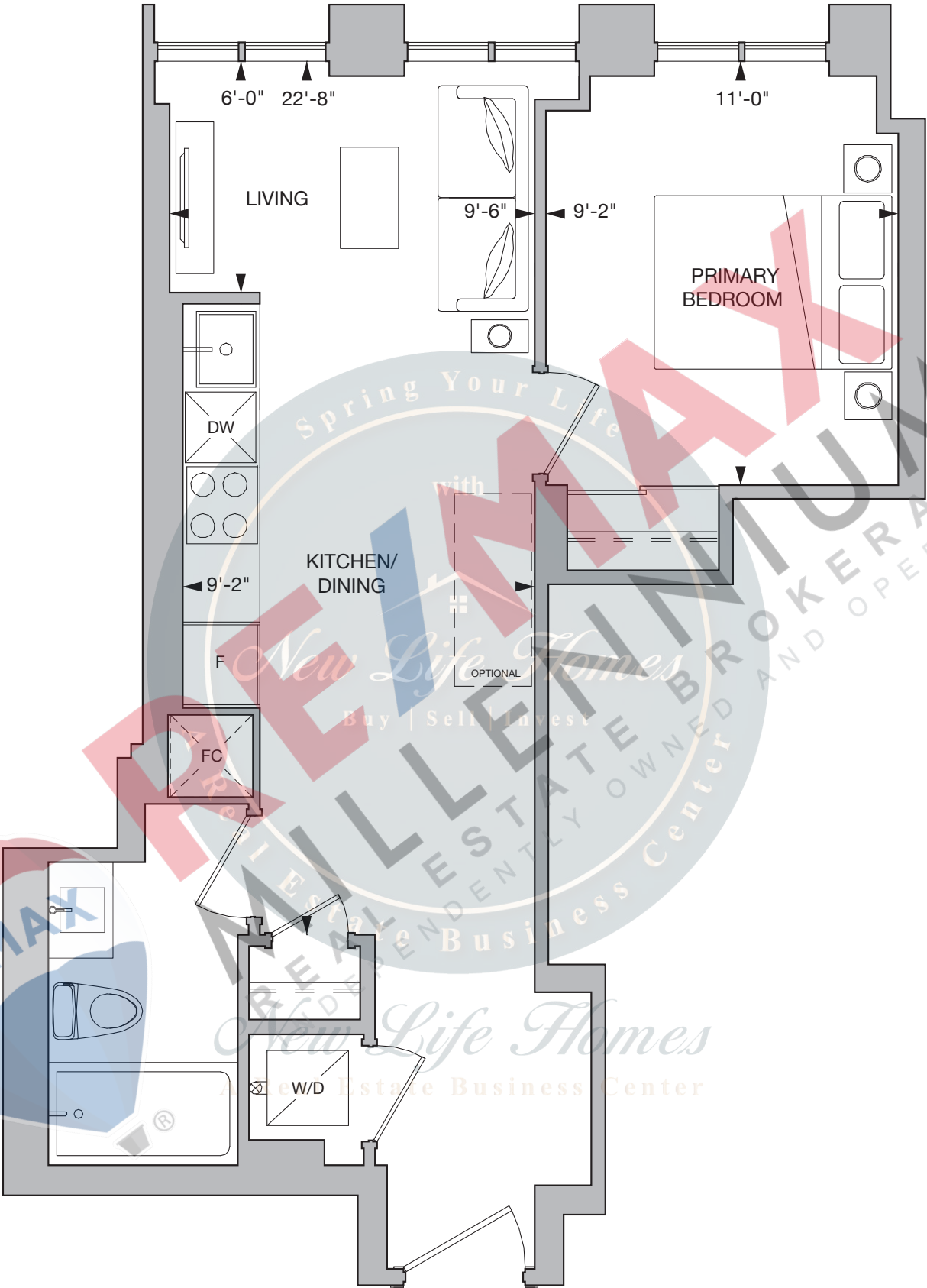

FLOORS

9, 11-19, 21-29, 31-39, 41, 42

FLOOR 43



All drawings, illustrations, renderings, and views from (or of) proposed buildings shown on any brochures, advertisements, scale models, and/or marketing materials are conceptual artist's renderings only and the vendor makes no representation or warranty relating to same. Any stated areas and/or dimensions shown are approximate only and subject to normal construction variances. Actual usable floor space may vary from any stated or depicted floor area and the unit shall be measured in accordance with the provisions set out in HCRA Directive - Floor Area Calculations. Any and all measurements and/or specifications are subject to change without notice. Without limiting the foregoing, the purchaser is advised that the design, finishes, and specifications of the balcony appurtenant to the unit may vary from the design and/or finishes shown on the marketing drawing, depending on the location of the unit being purchased within the key plan and the building, and the purchaser expressly acknowledges and consents to such variation. The layout of the suite may be reversed depending on the location of the unit within the project. Any furniture depicted is for illustration purposes only and does not necessarily reflect the fixtures, finishes, appliances, and/or electrical plan of the unit and is not included in the purchase price. The view from or through the windows to the exterior may be partially obstructed by materials affixed to the exterior cladding of the building as part of an overall design element and/or interior structural columns that may be required pursuant to the recommendations of the project's engineers. Ceiling heights are subject to bulkheads, exposed ducts, dropped ceilings and structural beams, as applicable pursuant to the plans. All features and finishes are subject to change without notice. E.&O.E. November 2023.

BATAM

1 BEDROOM, 1 BATHROOM
NORTH FACING
INTERIOR 502 SQ.FT.
TOTAL 502 SQ.FT.

ALLURE

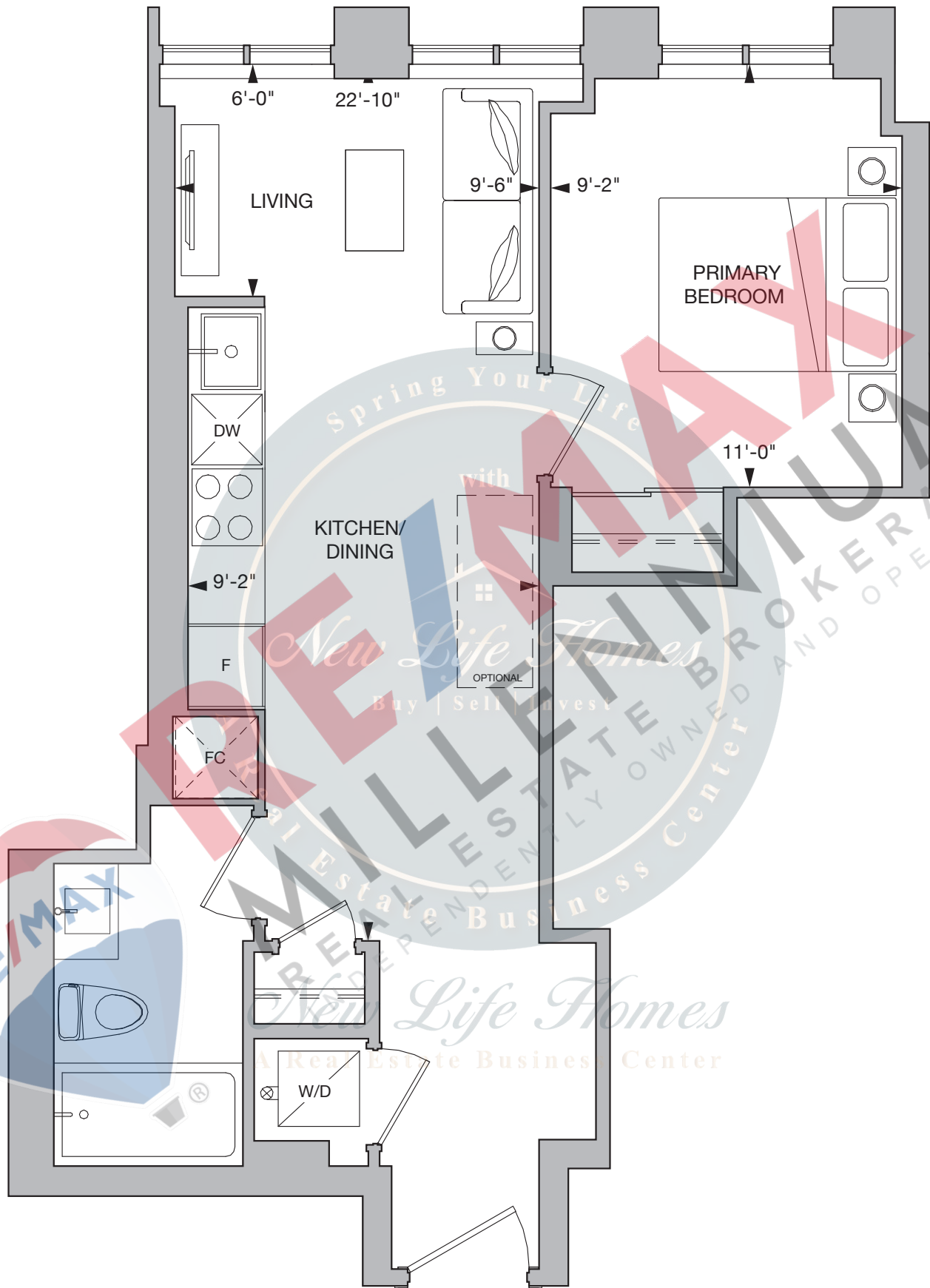

FLOORS 10, 20, 30, 40



All drawings, illustrations, renderings, and views from (or of) proposed buildings shown on any brochures, advertisements, scale models, and/or marketing materials are conceptual artist's renderings only and the vendor makes no representation or warranty relating to same. Any stated areas and/or dimensions shown are approximate only and subject to normal construction variances. Actual usable floor space may vary from any stated or depicted floor area and the unit shall be measured in accordance with the provisions set out in HCRA Directive - Floor Area Calculations. Any and all measurements and/or specifications are subject to change without notice. Without limiting the foregoing, the purchaser is advised that the design, finishes, and specifications of the balcony appurtenant to the unit may vary from the design and/or finishes shown on the marketing drawing, depending on the location of the unit being purchased within the key plan and the building, and the purchaser expressly acknowledges and consents to such variation. The layout of the suite may be reversed depending on the location of the unit within the project. Any furniture depicted is for illustration purposes only and does not necessarily reflect the fixtures, finishes, appliances, and/or electrical plan of the unit and is not included in the purchase price. The view from or through the windows to the exterior may be partially obstructed by materials affixed to the exterior cladding of the building as part of an overall design element and/or interior structural columns that may be required pursuant to the recommendations of the project's engineers. Ceiling heights are subject to bulkheads, exposed ducts, dropped ceilings and structural beams, as applicable pursuant to the plans. All features and finishes are subject to change without notice. E.&O.E. November 2023.

MARRAKECH

1 BEDROOM, 1 BATHROOM
NORTH FACING
INTERIOR 516 SQ.FT.
TOTAL 516 SQ.FT.

ALLURE

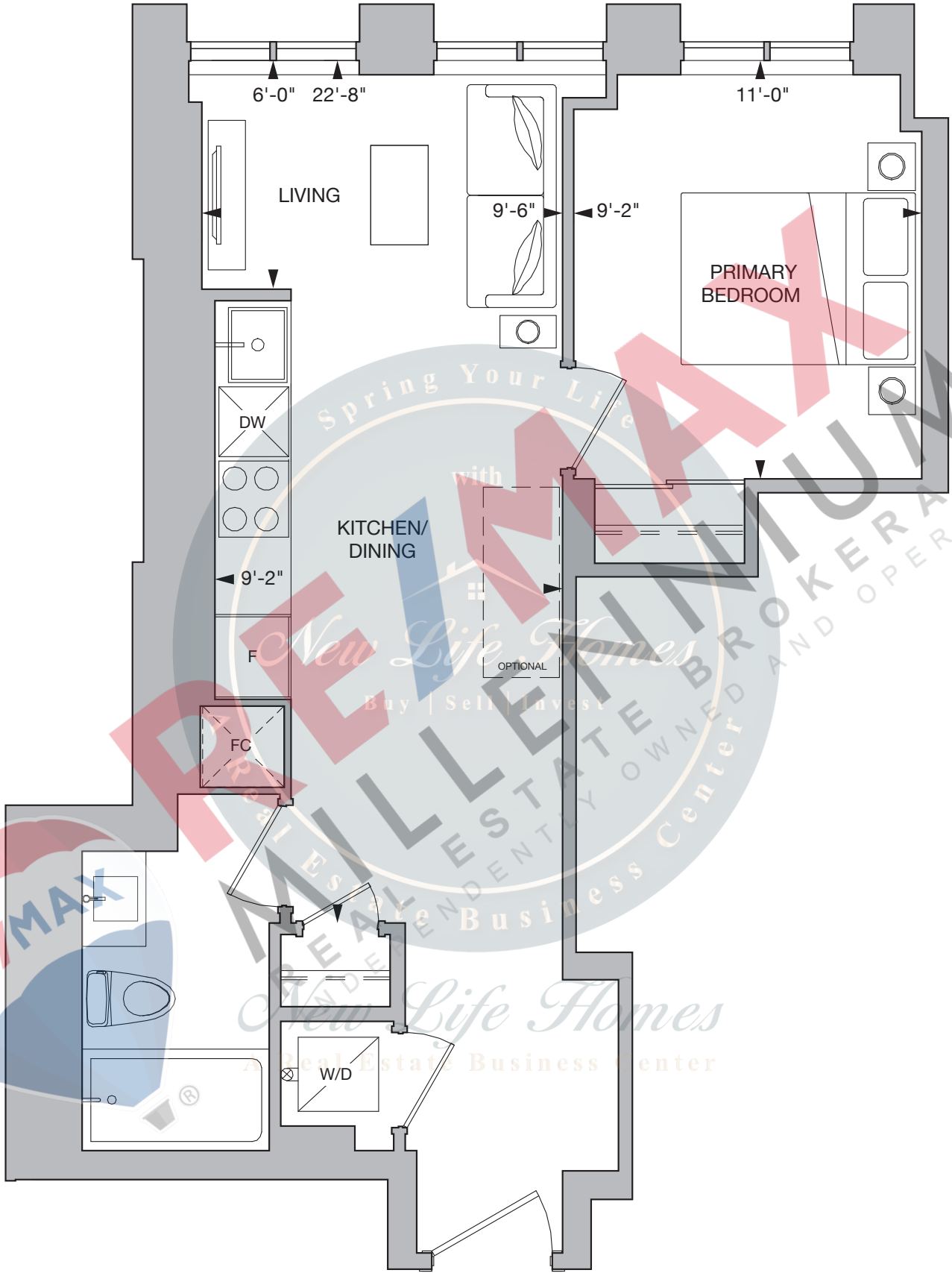

FLOOR 8

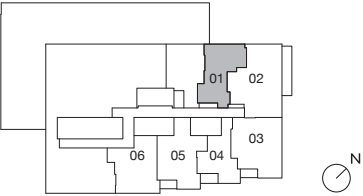

All drawings, illustrations, renderings, and views from (or of) proposed buildings shown on any brochures, advertisements, scale models, and/or marketing materials are conceptual artist's renderings only and the vendor makes no representation or warranty relating to same. Any stated areas and/or dimensions shown are approximate only and subject to normal construction variances. Actual usable floor space may vary from any stated or depicted floor area and the unit shall be measured in accordance with the provisions set out in HCRA Directive - Floor Area Calculations. Any and all measurements and/or specifications are subject to change without notice. Without limiting the foregoing, the purchaser is advised that the design, finishes, and specifications of the balcony appurtenant to the unit may vary from the design and/or finishes shown on the marketing drawing, depending on the location of the unit being purchased within the key plan and the building, and the purchaser expressly acknowledges and consents to such variation. The layout of the suite may be reversed depending on the location of the unit within the project. Any furniture depicted is for illustration purposes only and does not necessarily reflect the fixtures, finishes, appliances, and/or electrical plan of the unit and is not included in the purchase price. The view from or through the windows to the exterior may be partially obstructed by materials affixed to the exterior cladding of the building as part of an overall design element and/or interior structural columns that may be required pursuant to the recommendations of the project's engineers. Ceiling heights are subject to bulkheads, exposed ducts, dropped ceilings and structural beams, as applicable pursuant to the plans. All features and finishes are subject to change without notice. E.&O.E. November 2023.

TOTAL 534 SQ. FT.

ALLURE

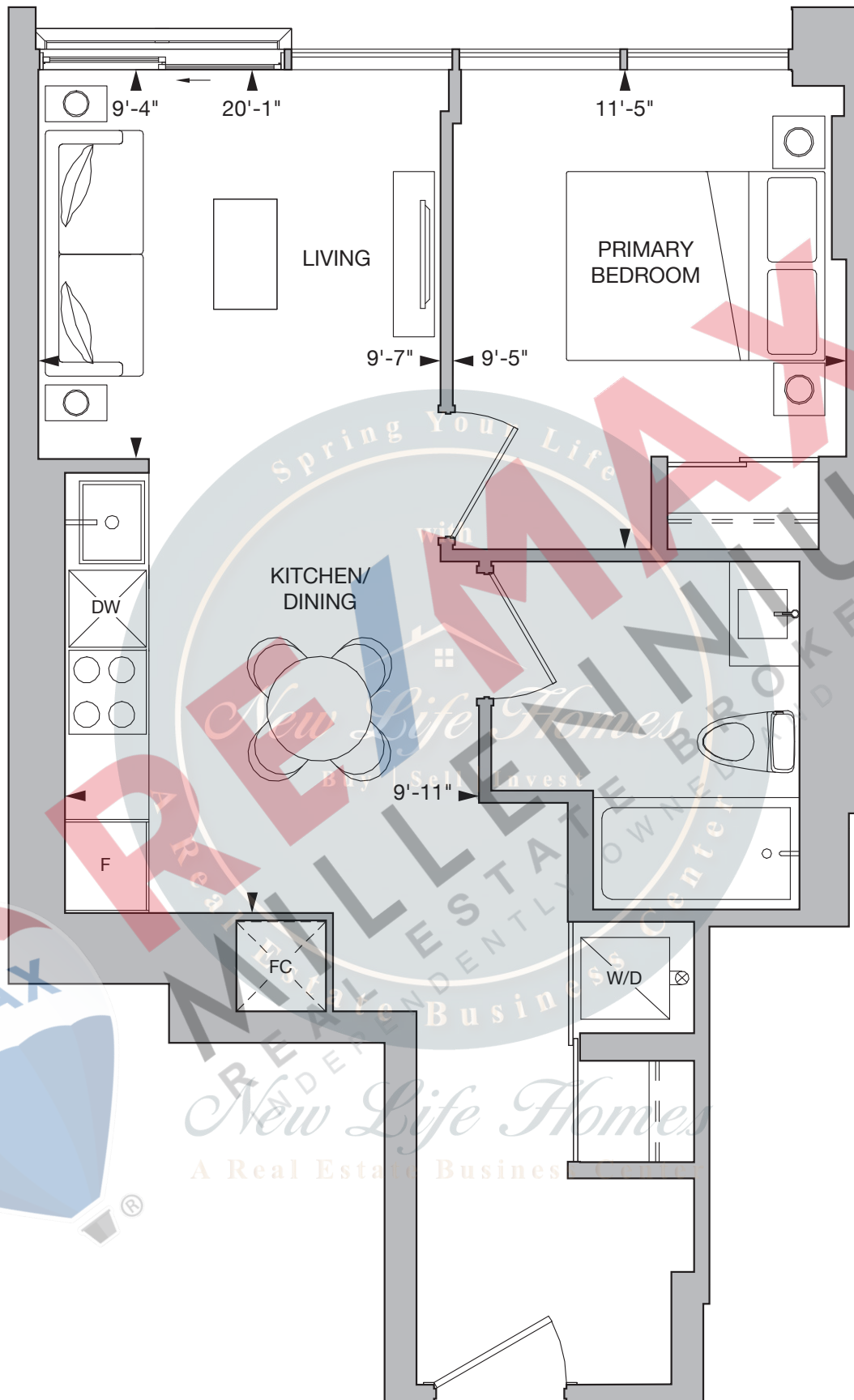

FLOORS 9, 11-19



FLOORS 10, 20



All drawings, illustrations, renderings, and views from (or of) proposed buildings shown on any brochures, advertisements, scale models, and/or marketing materials are conceptual artist's renderings only and the vendor makes no representation or warranty relating to same. Any stated areas and/or dimensions shown are approximate only and subject to normal construction variances. Actual usable floor space may vary from any stated or depicted floor area and the unit shall be measured in accordance with the provisions set out in HCTA Directive - Floor Area Calculations. Any and all measurements and/or specifications are subject to change without notice. Without limiting the foregoing, the purchaser is advised that the design, finishes, and specifications of the unit pursuant to the unit may vary from the design and/or finishes shown on the marketing drawing, depending on the location of the unit being purchased within the key plan and the building, and the purchaser expressly acknowledges and consents to such variation. The layout of the suite may be reversed depending on the location of the unit within the project. Any furniture depicted is for illustration purposes only and does not necessarily reflect the fixtures, finishes, appliances, and/or electrical plan of the unit and is not included in the purchase price. The view from or through the windows to the exterior may be partially obstructed by materials affixed to the exterior cladding of the building as part of an overall design element and/or interior structural columns that may be required pursuant to the recommendations of the project's engineers. Ceiling heights are subject to bulkheads, exposed ducts, dropped ceilings and structural beams, as applicable pursuant to the plans. All features and finishes are subject to change without notice. E.&O.E. November 2023.

Call us: 647-215-2315 | Email: Business@newlifehomes.ca

JAKARTA

1 BEDROOM, 1 BATHROOM
NORTH FACING
INTERIOR 534 SQ.FT.
TOTAL 534 SQ.FT.

ALLURE

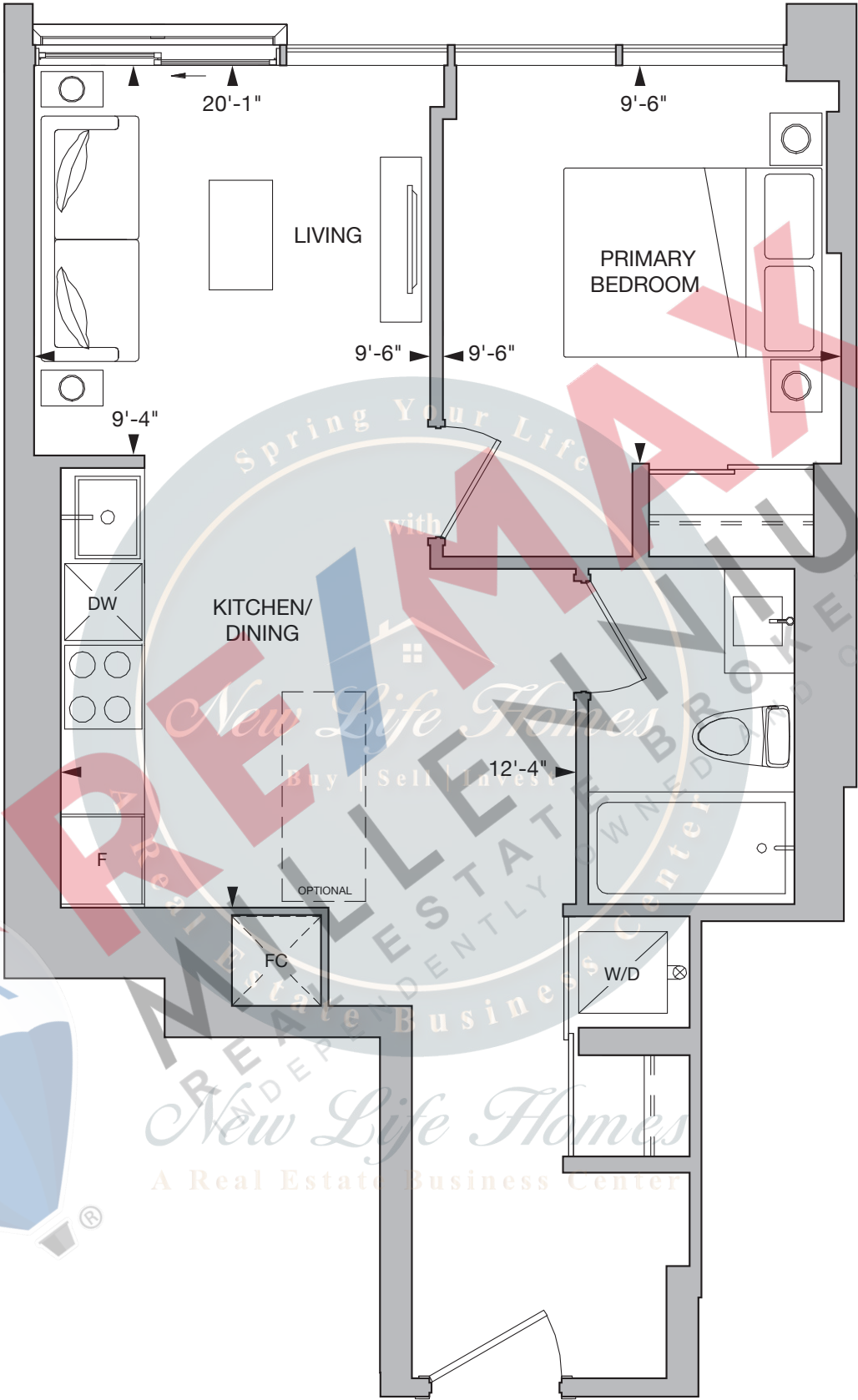

FLOORS

21-29, 31-39, 41, 42

FLOORS 30, 40

FLOOR 43



All drawings, illustrations, renderings, and views from (or of) proposed buildings shown on any brochures, advertisements, scale models, and/or marketing materials are conceptual artist's renderings only and the vendor makes no representation or warranty relating to same. Any stated areas and/or dimensions shown are approximate only and subject to normal construction variances. Actual usable floor space may vary from any stated or depicted floor area and the unit shall be measured in accordance with the provisions set out in HCRA Directive - Floor Area Calculations. Any and all measurements and/or specifications are subject to change without notice. Without limiting the foregoing, the purchaser is advised that the design, finishes, and specifications of the balcony appurtenant to the unit may vary from the design and/or finishes shown on the marketing drawing, depending on the location of the unit being purchased within the key plan and the building, and the purchaser expressly acknowledges and consents to such variation. The layout of the suite may be reversed depending on the location of the unit within the project. Any furniture depicted is for illustration purposes only and does not necessarily reflect the fixtures, finishes, appliances, and/or electrical plan of the unit and is not included in the purchase price. The view from or through the windows to the exterior may be partially obstructed by materials affixed to the exterior cladding of the building as part of an overall design element and/or interior structural columns that may be required pursuant to the recommendations of the project's engineers. Ceiling heights are subject to bulkheads, exposed ducts, dropped ceilings and structural beams, as applicable pursuant to the plans. All features and finishes are subject to change without notice. E.&O.E. November 2023.

RIO

1 BEDROOM + DEN, 1 BATHROOM
NORTH FACING
INTERIOR 544 SQ.FT.
TOTAL 544 SQ.FT.

ALLURE

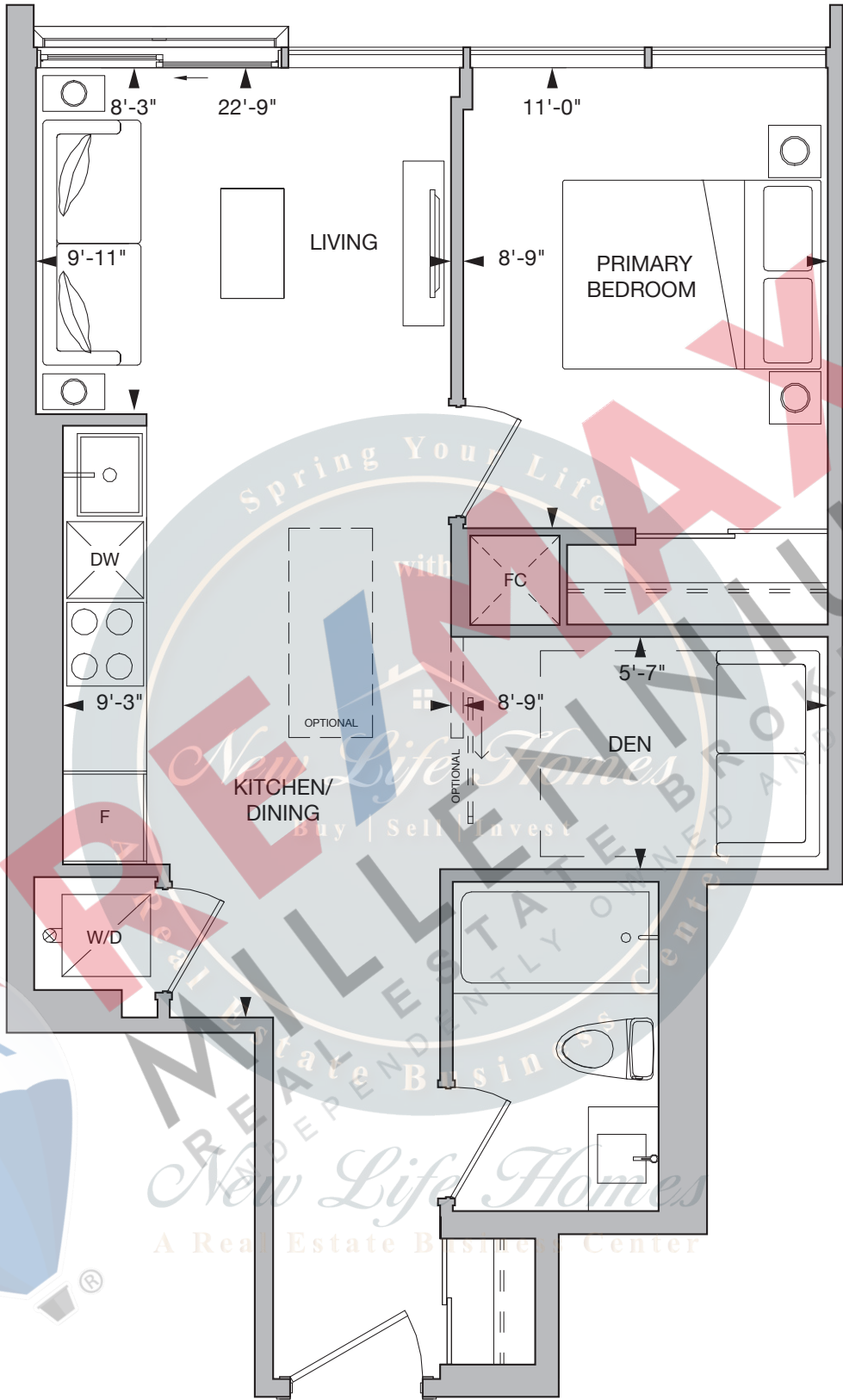

FLOORS

9, 11-19, 21-29, 31-39, 41, 42



FLOORS

10, 20, 30, 40



FLOOR 43



All drawings, illustrations, renderings, and views from (or of) proposed buildings shown on any brochures, advertisements, scale models, and/or marketing materials are conceptual artist's renderings only and the vendor makes no representation or warranty relating to same. Any stated areas and/or dimensions shown are approximate only and subject to normal construction variances. Actual usable floor space may vary from any stated or depicted floor area and the unit shall be measured in accordance with the provisions set out in HCRA Directive - Floor Area Calculations. Any and all measurements and/or specifications are subject to change without notice. Without limiting the foregoing, the purchaser is advised that the design, finishes, and specifications of the balcony appurtenant to the unit may vary from the design and/or finishes shown on the marketing drawing, depending on the location of the unit being purchased within the key plan and the building, and the purchaser expressly acknowledges and consents to such variation. The layout of the suite may be reversed depending on the location of the unit within the project. Any furniture depicted is for illustration purposes only and does not necessarily reflect the fixtures, finishes, appliances, and/or electrical plan of the unit and is not included in the purchase price. The view from or through the windows to the exterior may be partially obstructed by materials affixed to the exterior cladding of the building as part of an overall design element and/or interior structural columns that may be required pursuant to the recommendations of the project's engineers. Ceiling heights are subject to bulkheads, exposed ducts, dropped ceilings and structural beams, as applicable pursuant to the plans. All features and finishes are subject to change without notice. E.&O.E. November 2023.

P O R T O

1 B E D R O O M , 1 B A T H R O O M
N O R T H F A C I N G
I N T E R I O R 5 4 4 S Q . F T .
T O T A L 5 4 4 S Q . F T .

A L L U R E

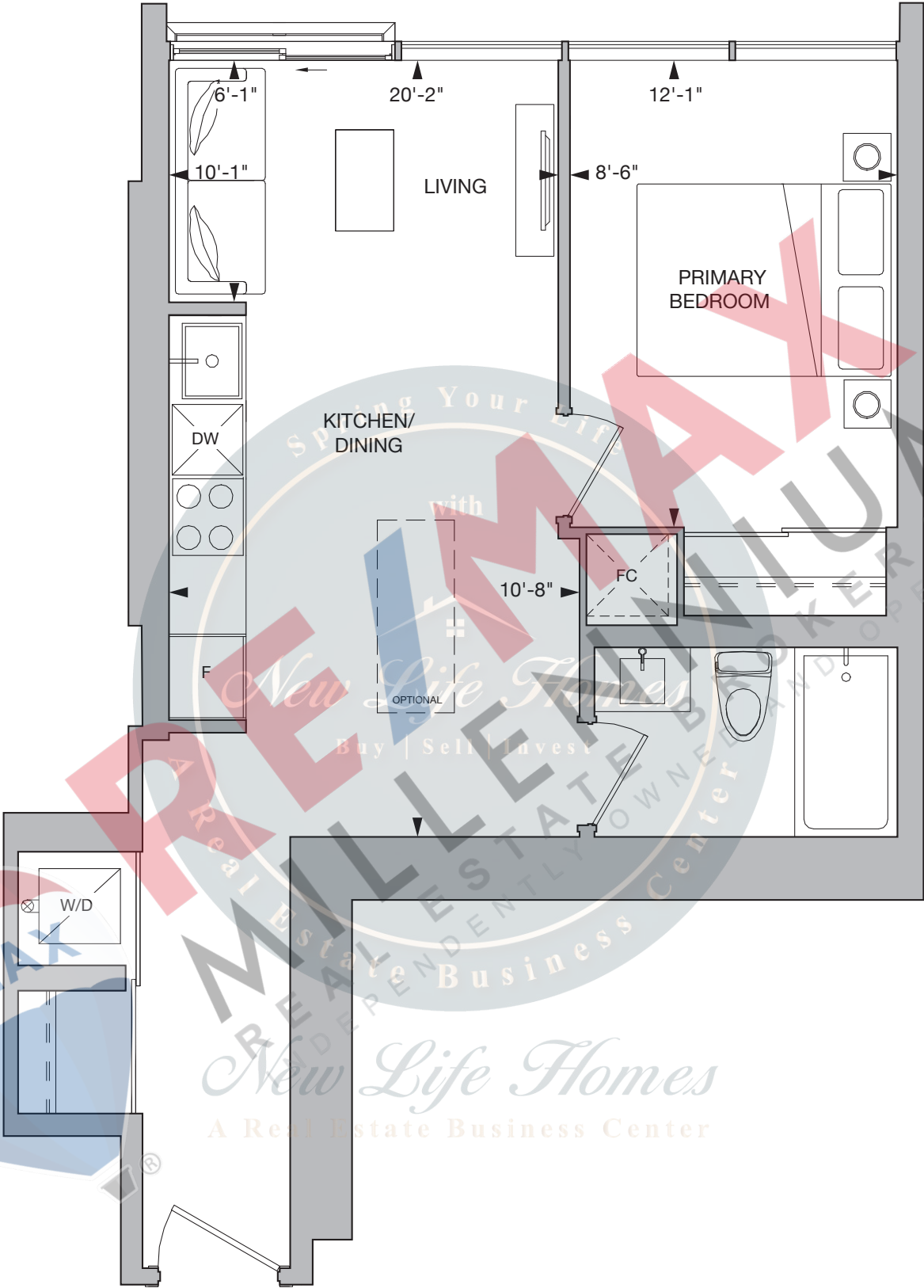

F L O O R S

9, 11-19, 21-29, 31-39, 41, 42

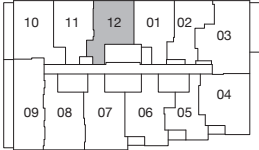

F L O O R S

10, 20, 30, 40

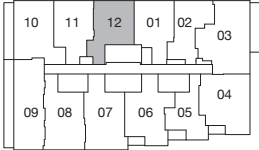

F L O O R 4 3



All drawings, illustrations, renderings, and views from (or of) proposed buildings shown on any brochures, advertisements, scale models, and/or marketing materials are conceptual artist's renderings only and the vendor makes no representation or warranty relating to same. Any stated areas and/or dimensions shown are approximate only and subject to normal construction variances. Actual usable floor space may vary from any stated or depicted floor area and the unit shall be measured in accordance with the provisions set out in HCRA Directive - Floor Area Calculations. Any and all measurements and/or specifications are subject to change without notice. Without limiting the foregoing, the purchaser is advised that the design, finishes, and specifications of the balcony appurtenant to the unit may vary from the design and/or finishes shown on the marketing drawing, depending on the location of the unit being purchased within the key plan and the building, and the purchaser expressly acknowledges and consents to such variation. The layout of the suite may be reversed depending on the location of the unit within the project. Any furniture depicted is for illustration purposes only and does not necessarily reflect the fixtures, finishes, appliances, and/or electrical plan of the unit and is not included in the purchase price. The view from or through the windows to the exterior may be partially obstructed by materials affixed to the exterior cladding of the building as part of an overall design element and/or interior structural columns that may be required pursuant to the recommendations of the project's engineers. Ceiling heights are subject to bulkheads, exposed ducts, dropped ceilings and structural beams, as applicable pursuant to the plans. All features and finishes are subject to change without notice. E.&O.E. November 2023.

H O N O L U L U

1 B E D R O O M + D E N , 1 B A T H R O O M

S O U T H F A C I N G

I N T E R I O R 5 6 7 S Q . F T .

T O T A L 5 6 7 S Q . F T .

A L L U R E

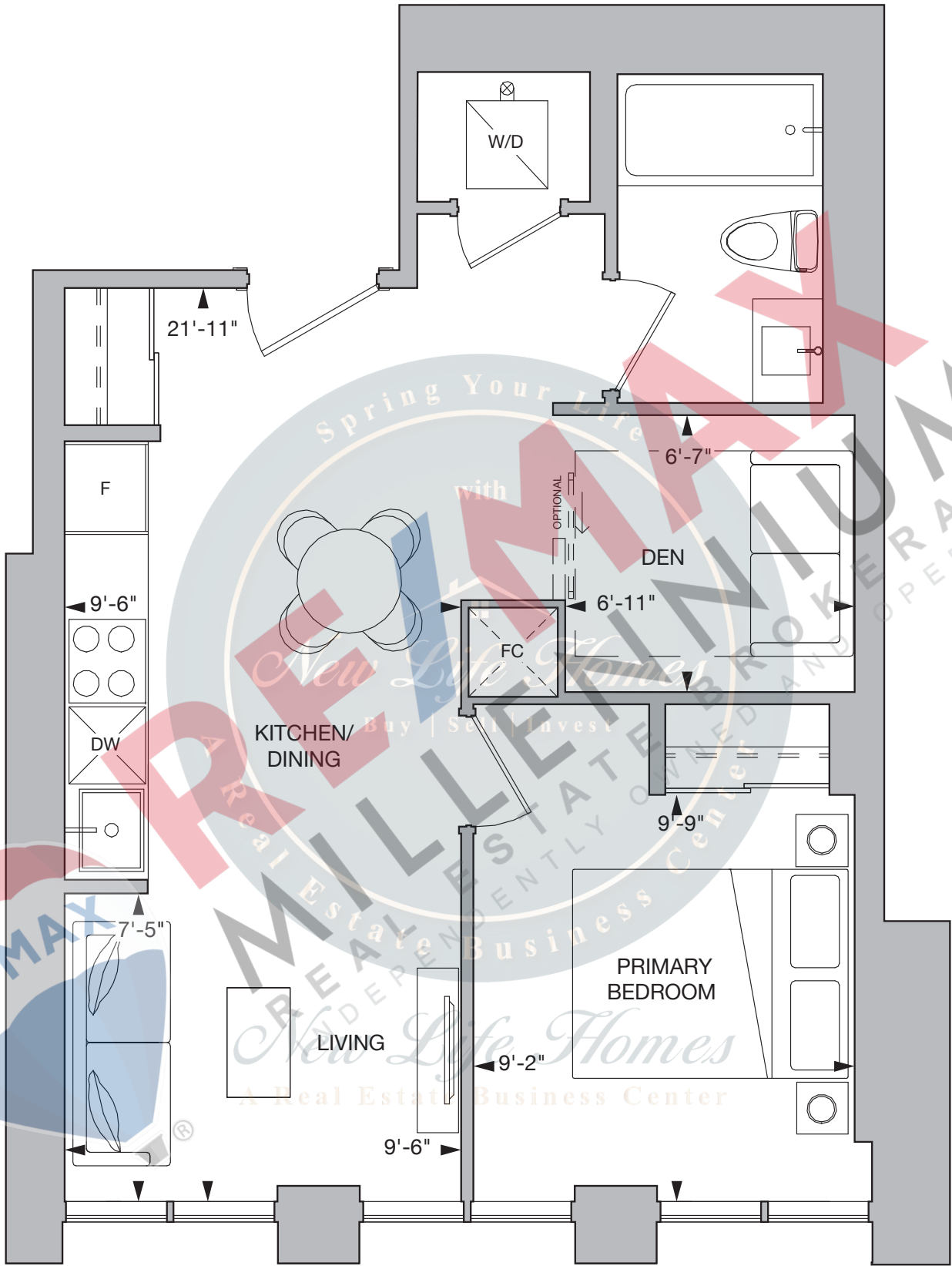

FLOOR 8

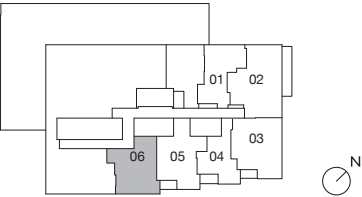

All drawings, illustrations, renderings, and views from (or of) proposed buildings shown on any brochures, advertisements, scale models, and/or marketing materials are conceptual artist's renderings only and the vendor makes no representation or warranty relating to same. Any stated areas and/or dimensions shown are approximate only and subject to normal construction variances. Actual usable floor space may vary from any stated or depicted floor area and the unit shall be measured in accordance with the provisions set out in HCRA Directive - Floor Area Calculations. Any and all measurements and/or specifications are subject to change without notice. Without limiting the foregoing, the purchaser is advised that the design, finishes, and specifications of the balcony appurtenant to the unit may vary from the design and/or finishes shown on the marketing drawing, depending on the location of the unit being purchased within the key plan and the building, and the purchaser expressly acknowledges and consents to such variation. The layout of the suite may be reversed depending on the location of the unit within the project. Any furniture depicted is for illustration purposes only and does not necessarily reflect the fixtures, finishes, appliances, and/or electrical plan of the unit and is not included in the purchase price. The view from or through the windows to the exterior may be partially obstructed by materials affixed to the exterior cladding of the building as part of an overall design element and/or interior structural columns that may be required pursuant to the recommendations of the project's engineers. Ceiling heights are subject to bulkheads, exposed ducts, dropped ceilings and structural beams, as applicable pursuant to the plans. All features and finishes are subject to change without notice. E.&O.E. November 2023.

PETRA

1 BEDROOM + DEN, 1 BATHROOM
SOUTH FACING
INTERIOR 598 SQ.FT.
TOTAL 598 SQ.FT.

ALLURE

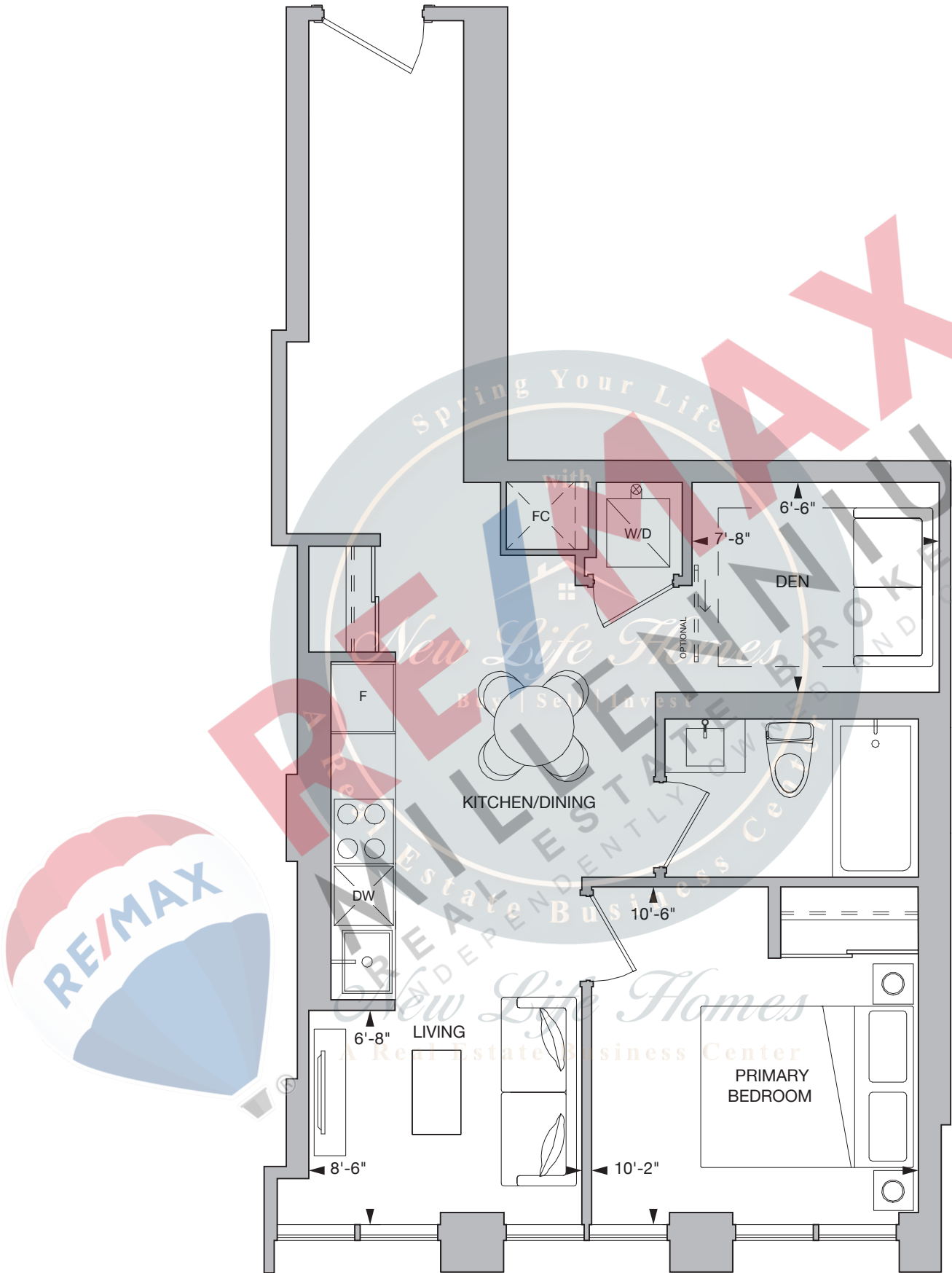

FLOOR 43



All drawings, illustrations, renderings, and views from (or of) proposed buildings shown on any brochures, advertisements, scale models, and/or marketing materials are conceptual artist's renderings only and the vendor makes no representation or warranty relating to same. Any stated areas and/or dimensions shown are approximate only and subject to normal construction variances. Actual usable floor space may vary from any stated or depicted floor area and the unit shall be measured in accordance with the provisions set out in HCRA Directive - Floor Area Calculations. Any and all measurements and/or specifications are subject to change without notice. Without limiting the foregoing, the purchaser is advised that the design, finishes, and specifications of the balcony appurtenant to the unit may vary from the design and/or finishes shown on the marketing drawing, depending on the location of the unit being purchased within the key plan and the building, and the purchaser expressly acknowledges and consents to such variation. The layout of the suite may be reversed depending on the location of the unit within the project. Any furniture depicted is for illustration purposes only and does not necessarily reflect the fixtures, finishes, appliances, and/or electrical plan of the unit and is not included in the purchase price. The view from or through the windows to the exterior may be partially obstructed by materials affixed to the exterior cladding of the building as part of an overall design element and/or interior structural columns that may be required pursuant to the recommendations of the project's engineers. Ceiling heights are subject to bulkheads, exposed ducts, dropped ceilings and structural beams, as applicable pursuant to the plans. All features and finishes are subject to change without notice. E.&O.E. November 2023.

EDINBURGH

1 BEDROOM + DEN, 1 BATHROOM
SOUTH FACING
INTERIOR 639 SQ.FT.
TOTAL 639 SQ.FT.

ALLURE

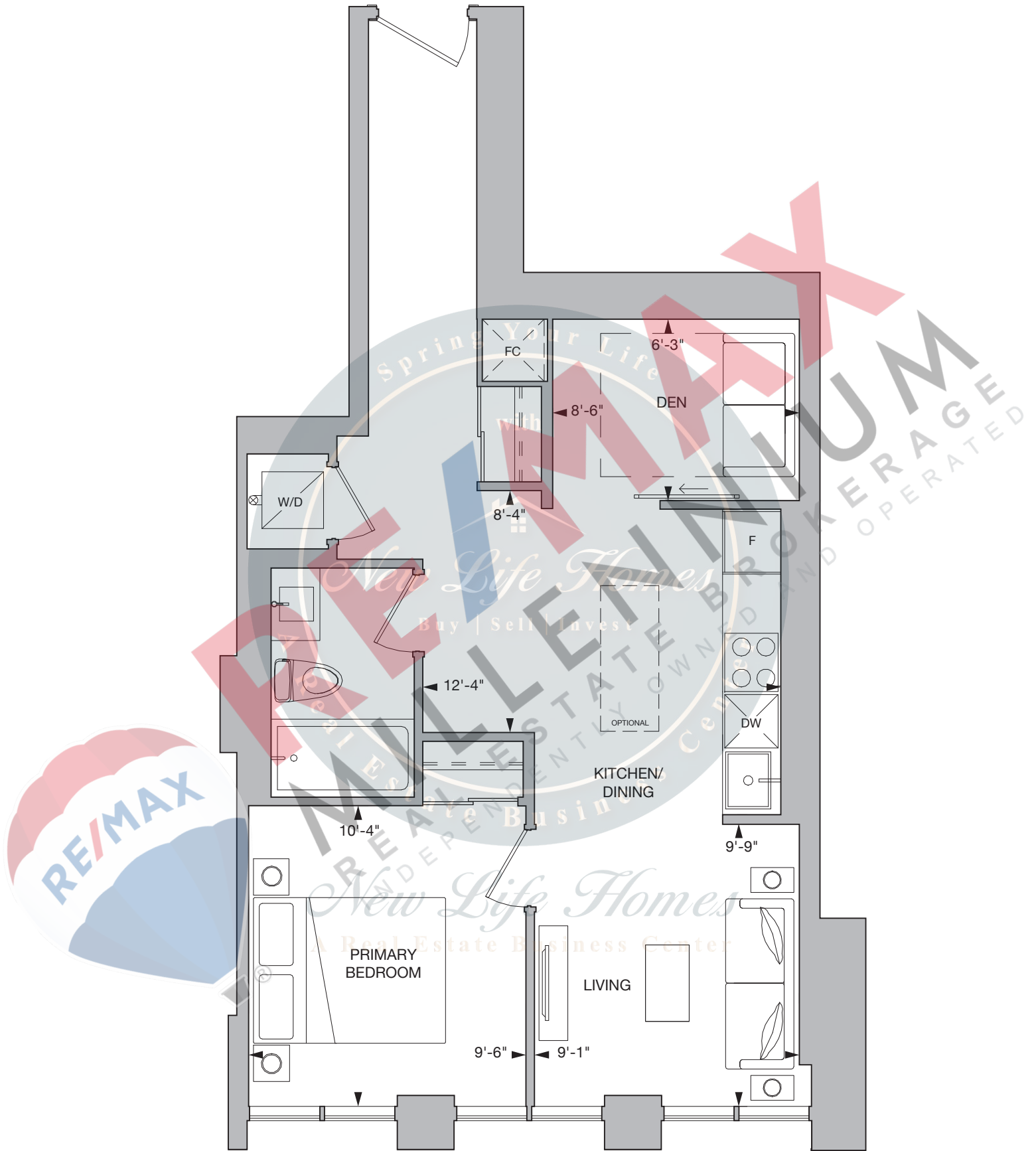

FLOOR 43



All drawings, illustrations, renderings, and views from (or of) proposed buildings shown on any brochures, advertisements, scale models, and/or marketing materials are conceptual artist's renderings only and the vendor makes no representation or warranty relating to same. Any stated areas and/or dimensions shown are approximate only and subject to normal construction variances. Actual usable floor space may vary from any stated or depicted floor area and the unit shall be measured in accordance with the provisions set out in HCRA Directive - Floor Area Calculations. Any and all measurements and/or specifications are subject to change without notice. Without limiting the foregoing, the purchaser is advised that the design, finishes, and specifications of the balcony appurtenant to the unit may vary from the design and/or finishes shown on the marketing drawing, depending on the location of the unit being purchased within the key plan and the building, and the purchaser expressly acknowledges and consents to such variation. The layout of the suite may be reversed depending on the location of the unit within the project. Any furniture depicted is for illustration purposes only and does not necessarily reflect the fixtures, finishes, appliances, and/or electrical plan of the unit and is not included in the purchase price. The view from or through the windows to the exterior may be partially obstructed by materials affixed to the exterior cladding of the building as part of an overall design element and/or interior structural columns that may be required pursuant to the recommendations of the project's engineers. Ceiling heights are subject to bulkheads, exposed ducts, dropped ceilings and structural beams, as applicable pursuant to the plans. All features and finishes are subject to change without notice. E.&O.E. November 2023.

L I M A

2 BEDROOMS, 1 BATHROOM
SOUTH FACING
INTERIOR 666 SQ.FT.
TOTAL 666 SQ.FT.

A L L U R E

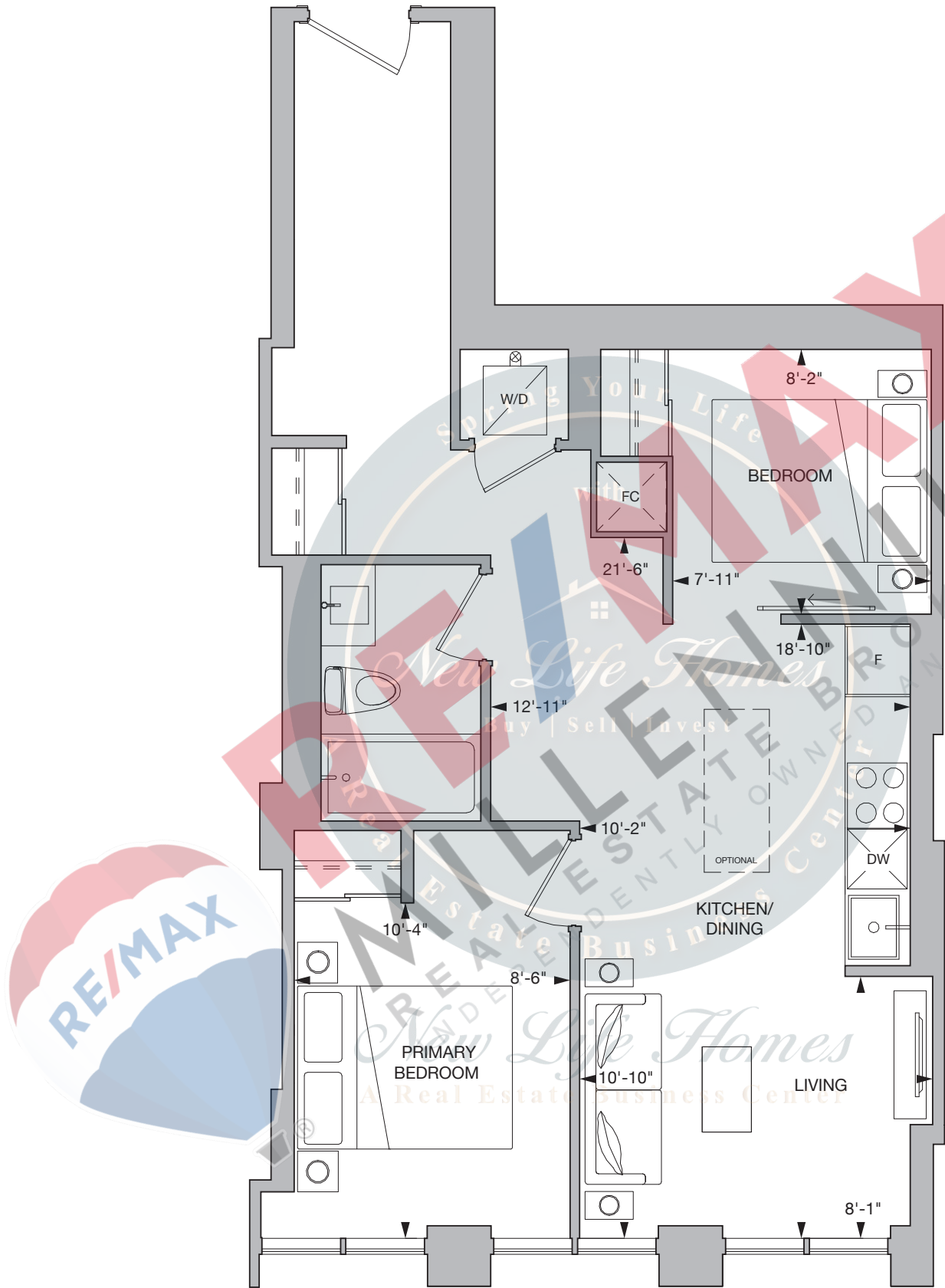

FLOORS

9, 11-19, 21-29, 31-39, 41, 42

FLOORS

10, 20, 30, 40

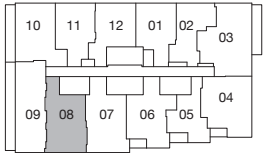

All drawings, illustrations, renderings, and views from (or of) proposed buildings shown on any brochures, advertisements, scale models, and/or marketing materials are conceptual artist's renderings only and the vendor makes no representation or warranty relating to same. Any stated areas and/or dimensions shown are approximate only and subject to normal construction variances. Actual usable floor space may vary from any stated or depicted floor area and the unit shall be measured in accordance with the provisions set out in HCRA Directive - Floor Area Calculations. Any and all measurements and/or specifications are subject to change without notice. Without limiting the foregoing, the purchaser is advised that the design, finishes, and specifications of the balcony appurtenant to the unit may vary from the design and/or finishes shown on the marketing drawing, depending on the location of the unit being purchased within the key plan and the building, and the purchaser expressly acknowledges and consents to such variation. The layout of the suite may be reversed depending on the location of the unit within the project. Any furniture depicted is for illustration purposes only and does not necessarily reflect the fixtures, finishes, appliances, and/or electrical plan of the unit and is not included in the purchase price. The view from or through the windows to the exterior may be partially obstructed by materials affixed to the exterior cladding of the building as part of an overall design element and/or interior structural columns that may be required pursuant to the recommendations of the project's engineers. Ceiling heights are subject to bulkheads, exposed ducts, dropped ceilings and structural beams, as applicable pursuant to the plans. All features and finishes are subject to change without notice. E.&O.E. November 2023.

KYOTO

1 BEDROOM + DEN, 1 BATHROOM

SOUTH FACING

INTERIOR 632 SQ.FT. | EXTERIOR 37 SQ.FT.

TOTAL 669 SQ.FT.

ALLURE

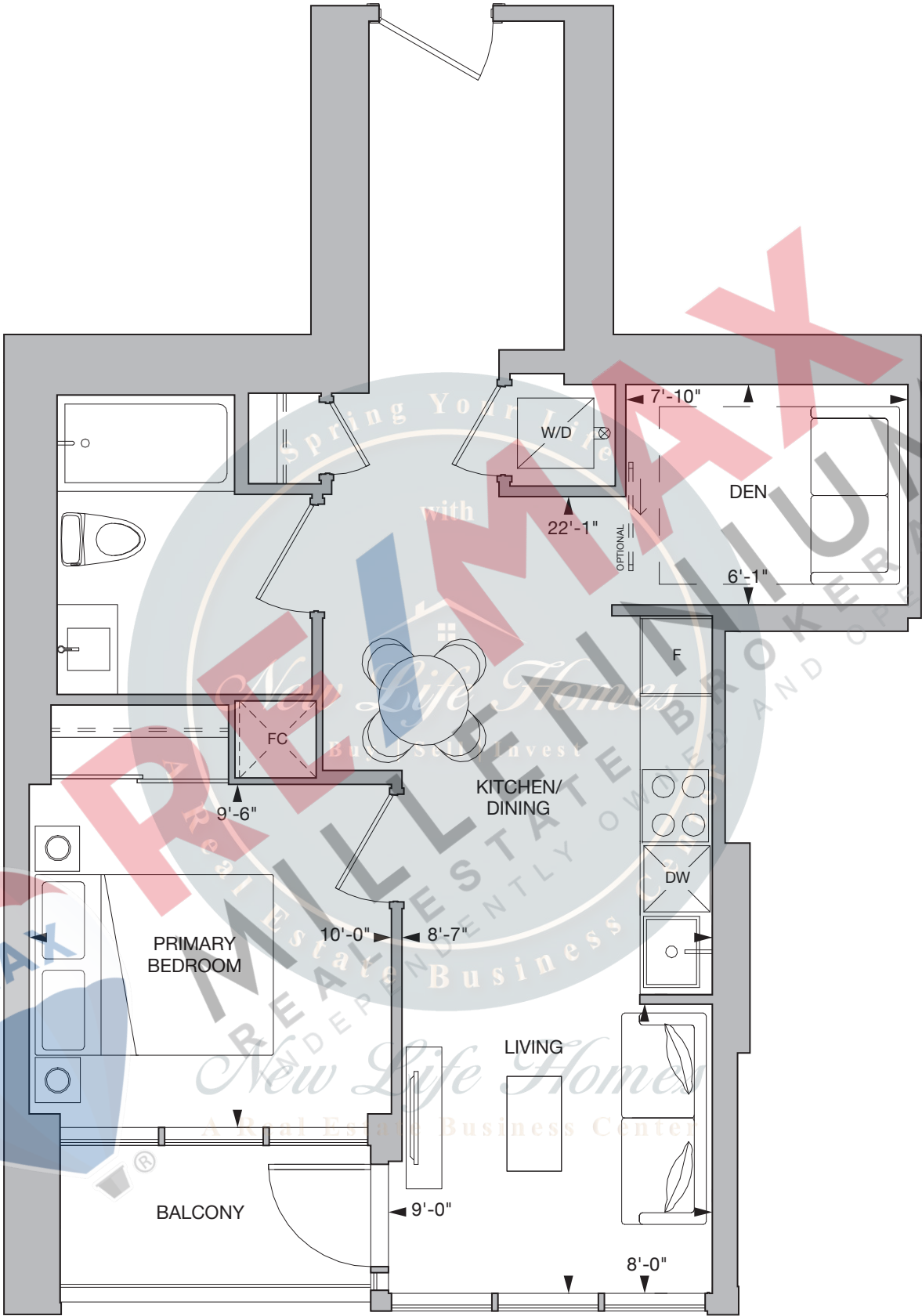

FLOOR 7

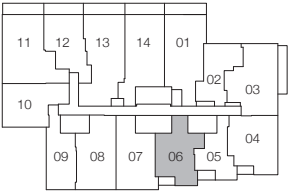

FLOOR 8

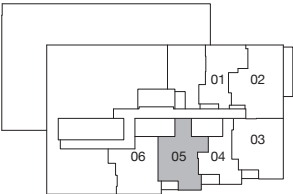

FLOORS 9, 11-19



FLOORS 10, 20



All drawings, illustrations, renderings, and views from (or of) proposed buildings shown on any brochures, advertisements, scale models, and/or marketing materials are conceptual artist's renderings only and the vendor makes no representation or warranty relating to same. Any stated areas and/or dimensions shown are approximate only and subject to normal construction variances. Actual usable floor space may vary from any stated or depicted floor area and the unit shall be measured in accordance with the provisions set out in HCRA Directive - Floor Area Calculations. Any and all measurements and/or specifications are subject to change without notice. Without limiting the foregoing, the purchaser is advised that the design, finishes, and specifications of the balcony appurtenant to the unit may vary from the design and/or finishes shown on the marketing drawing, depending on the location of the unit being purchased within the key plan and the building, and the purchaser expressly acknowledges and consents to such variation. The layout of the suite may be reversed depending on the location of the unit within the project. Any furniture depicted is for illustration purposes only and does not necessarily reflect the fixtures, finishes, appliances, and/or electrical plan of the unit and is not included in the purchase price. The view from or through the windows to the exterior may be partially obstructed by materials affixed to the exterior cladding of the building as part of an overall design element and/or interior structural columns that may be required pursuant to the recommendations of the project's engineers. Ceiling heights are subject to bulkheads, exposed ducts, dropped ceilings and structural beams, as applicable pursuant to the plans. All features and finishes are subject to change without notice. E.&O.E. November 2023.

V A R N A

1 B E D R O O M + D E N , 1 B A T H R O O M

S O U T H F A C I N G

I N T E R I O R 6 3 2 S Q . F T . | E X T E R I O R 3 7 S Q . F T .

T O T A L 6 6 9 S Q . F T .

A L L U R E

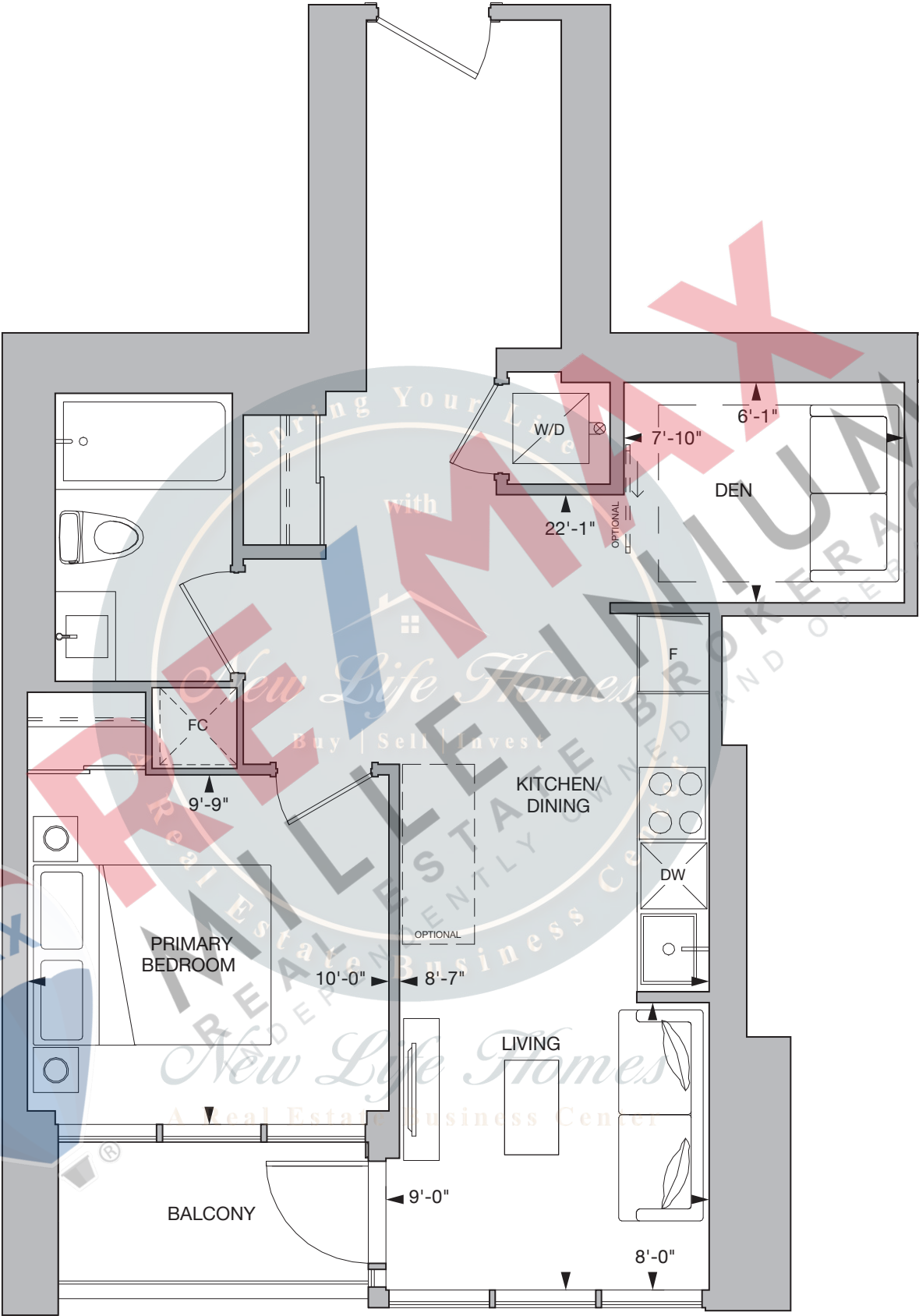

F L O O R S

21-29, 31-42

F L O O R 3 0

F L O O R 4 3



All drawings, illustrations, renderings, and views from (or of) proposed buildings shown on any brochures, advertisements, scale models, and/or marketing materials are conceptual artist's renderings only and the vendor makes no representation or warranty relating to same. Any stated areas and/or dimensions shown are approximate only and subject to normal construction variances. Actual usable floor space may vary from any stated or depicted floor area and the unit shall be measured in accordance with the provisions set out in HCRA Directive - Floor Area Calculations. Any and all measurements and/or specifications are subject to change without notice. Without limiting the foregoing, the purchaser is advised that the design, finishes, and specifications of the balcony appurtenant to the unit may vary from the design and/or finishes shown on the marketing drawing, depending on the location of the unit being purchased within the key plan and the building, and the purchaser expressly acknowledges and consents to such variation. The layout of the suite may be reversed depending on the location of the unit within the project. Any furniture depicted is for illustration purposes only and does not necessarily reflect the fixtures, finishes, appliances, and/or electrical plan of the unit and is not included in the purchase price. The view from or through the windows to the exterior may be partially obstructed by materials affixed to the exterior cladding of the building as part of an overall design element and/or interior structural columns that may be required pursuant to the recommendations of the project's engineers. Ceiling heights are subject to bulkheads, exposed ducts, dropped ceilings and structural beams, as applicable pursuant to the plans. All features and finishes are subject to change without notice. E.&O.E. November 2023.

CHIBA

2 BEDROOMS, 1 BATHROOM
SOUTH FACING
INTERIOR 681 SQ.FT.
TOTAL 681 SQ.FT.

ALLURE

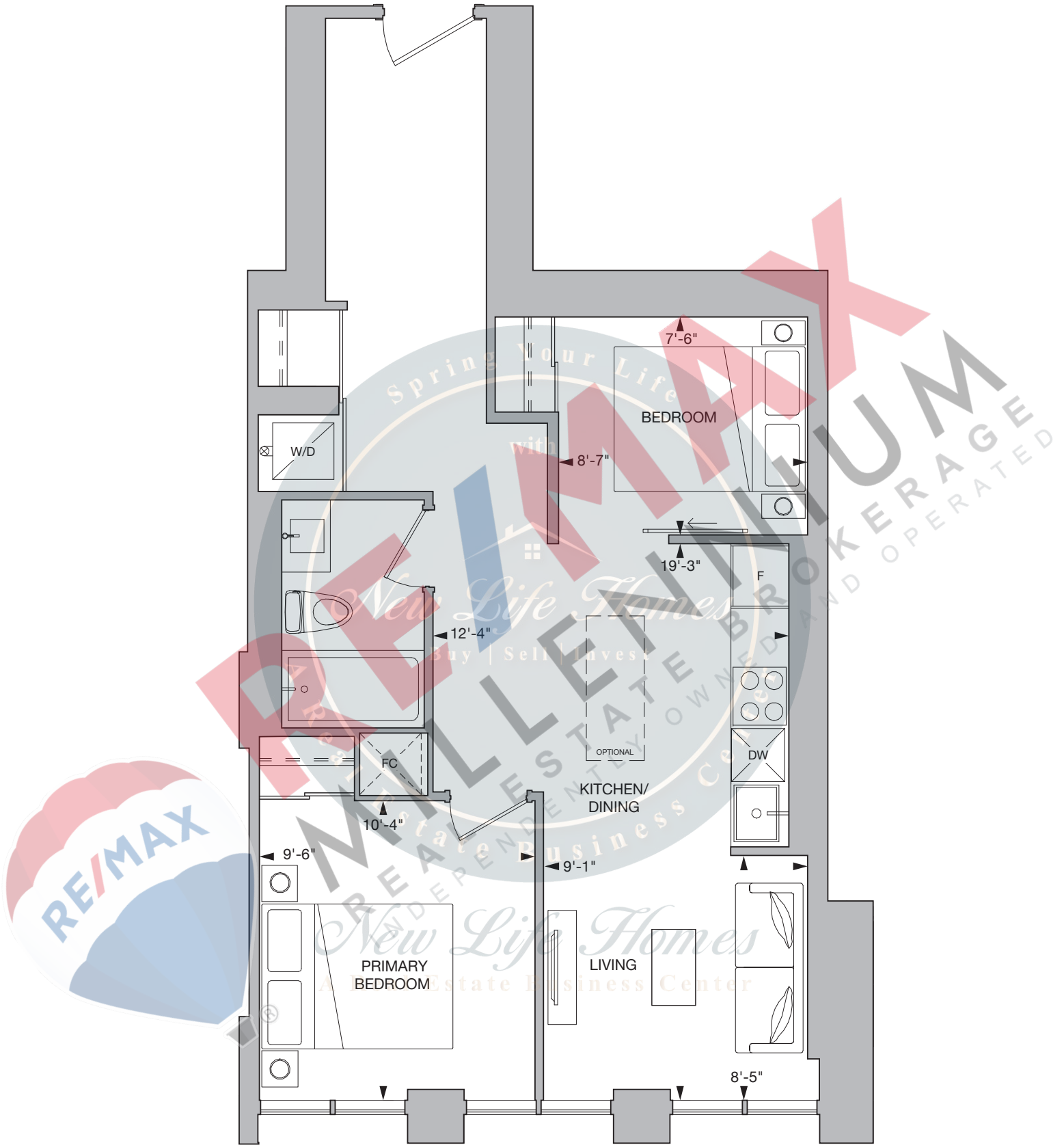

FLOORS

9, 11-19, 21-29, 31-39, 41, 42

FLOORS

10, 20, 30, 40



All drawings, illustrations, renderings, and views from (or of) proposed buildings shown on any brochures, advertisements, scale models, and/or marketing materials are conceptual artist's renderings only and the vendor makes no representation or warranty relating to same. Any stated areas and/or dimensions shown are approximate only and subject to normal construction variances. Actual usable floor space may vary from any stated or depicted floor area and the unit shall be measured in accordance with the provisions set out in HCRA Directive - Floor Area Calculations. Any and all measurements and/or specifications are subject to change without notice. Without limiting the foregoing, the purchaser is advised that the design, finishes, and specifications of the balcony appurtenant to the unit may vary from the design and/or finishes shown on the marketing drawing, depending on the location of the unit being purchased within the key plan and the building, and the purchaser expressly acknowledges and consents to such variation. The layout of the suite may be reversed depending on the location of the unit within the project. Any furniture depicted is for illustration purposes only and does not necessarily reflect the fixtures, finishes, appliances, and/or electrical plan of the unit and is not included in the purchase price. The view from or through the windows to the exterior may be partially obstructed by materials affixed to the exterior cladding of the building as part of an overall design element and/or interior structural columns that may be required pursuant to the recommendations of the project's engineers. Ceiling heights are subject to bulkheads, exposed ducts, dropped ceilings and structural beams, as applicable pursuant to the plans. All features and finishes are subject to change without notice. E.&O.E. November 2023.

L I S B O N

2 BEDROOMS, 2 BATHROOMS

SOUTHEAST FACING

INTERIOR 714 SQ.FT. | EXTERIOR 37 SQ.FT.

TOTAL 751 SQ.FT.

A L L U R E

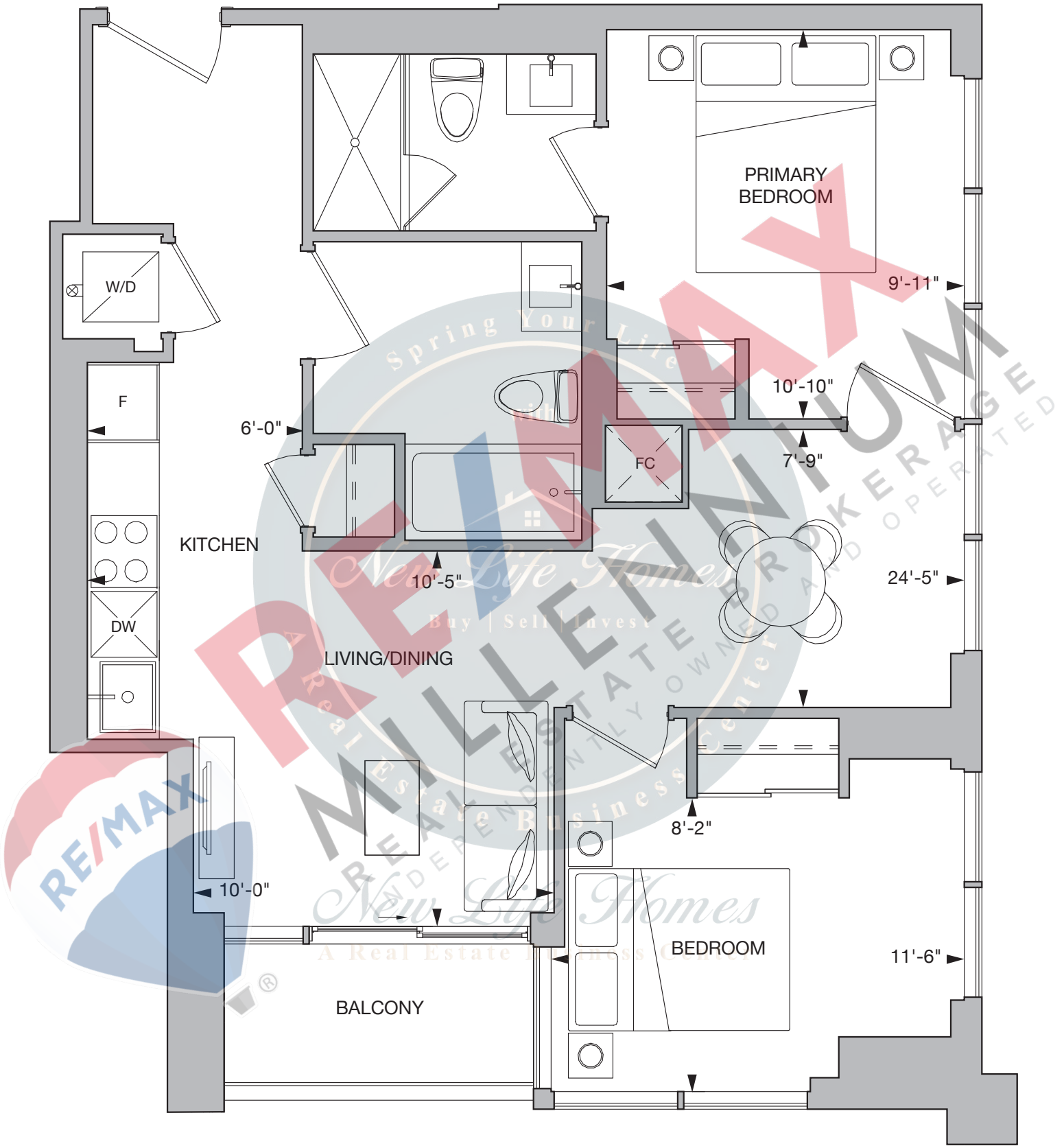

FLOOR 7

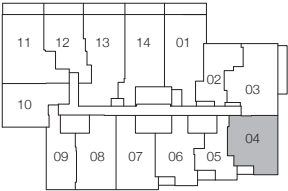

FLOOR 8

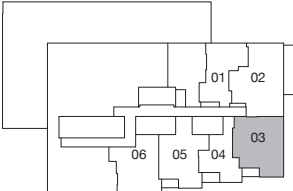

FLOORS 9, 11-19, 21-25

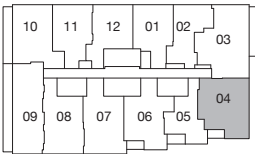

FLOORS 10, 20



All drawings, illustrations, renderings, and views from (or of) proposed buildings shown on any brochures, advertisements, scale models, and/or marketing materials are conceptual artist's renderings only and the vendor makes no representation or warranty relating to same. Any stated areas and/or dimensions shown are approximate only and subject to normal construction variances. Actual usable floor space may vary from any stated or depicted floor area and the unit shall be measured in accordance with the provisions set out in HCRA Directive - Floor Area Calculations. Any and all measurements and/or specifications are subject to change without notice. Without limiting the foregoing, the purchaser is advised that the design, finishes, and specifications of the balcony appurtenant to the unit may vary from the design and/or finishes shown on the marketing drawing, depending on the location of the unit being purchased within the key plan and the building, and the purchaser expressly acknowledges and consents to such variation. The layout of the suite may be reversed depending on the location of the unit within the project. Any furniture depicted is for illustration purposes only and does not necessarily reflect the fixtures, finishes, appliances, and/or electrical plan of the unit and is not included in the purchase price. The view from or through the windows to the exterior may be partially obstructed by materials affixed to the exterior cladding of the building as part of an overall design element and/or interior structural columns that may be required pursuant to the recommendations of the project's engineers. Ceiling heights are subject to bulkheads, exposed ducts, dropped ceilings and structural beams, as applicable pursuant to the plans. All features and finishes are subject to change without notice. E.&O.E. November 2023.

OSLO

2 BEDROOMS, 2 BATHROOMS

SOUTHEAST FACING

INTERIOR 714 SQ.FT. | EXTERIOR 37 SQ.FT.

TOTAL 751 SQ.FT.

ALLURE

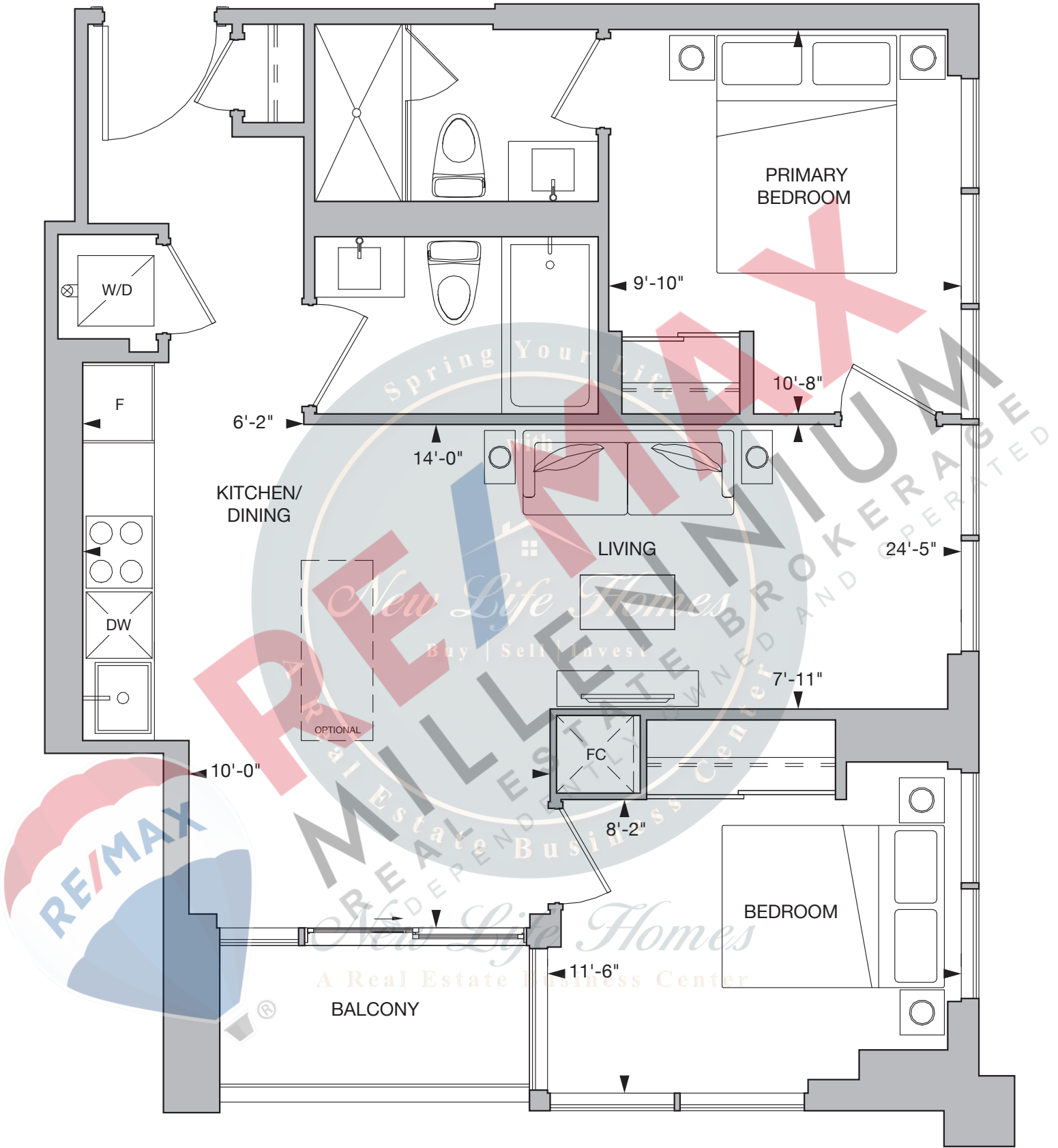

FLOORS

26-29, 31-39, 41, 42

FLOORS 30, 40

FLOOR 43



All drawings, illustrations, renderings, and views from (or of) proposed buildings shown on any brochures, advertisements, scale models, and/or marketing materials are conceptual artist's renderings only and the vendor makes no representation or warranty relating to same. Any stated areas and/or dimensions shown are approximate only and subject to normal construction variances. Actual usable floor space may vary from any stated or depicted floor area and the unit shall be measured in accordance with the provisions set out in HCRA Directive - Floor Area Calculations. Any and all measurements and/or specifications are subject to change without notice. Without limiting the foregoing, the purchaser is advised that the design, finishes, and specifications of the balcony appurtenant to the unit may vary from the design and/or finishes shown on the marketing drawing, depending on the location of the unit being purchased within the key plan and the building, and the purchaser expressly acknowledges and consents to such variation. The layout of the suite may be reversed depending on the location of the unit within the project. Any furniture depicted is for illustration purposes only and does not necessarily reflect the fixtures, finishes, appliances, and/or electrical plan of the unit and is not included in the purchase price. The view from or through the windows to the exterior may be partially obstructed by materials affixed to the exterior cladding of the building as part of an overall design element and/or interior structural columns that may be required pursuant to the recommendations of the project's engineers. Ceiling heights are subject to bulkheads, exposed ducts, dropped ceilings and structural beams, as applicable pursuant to the plans. All features and finishes are subject to change without notice. E.&O.E. November 2023.

TOTAL 808 SQ. FT.

ALLURE

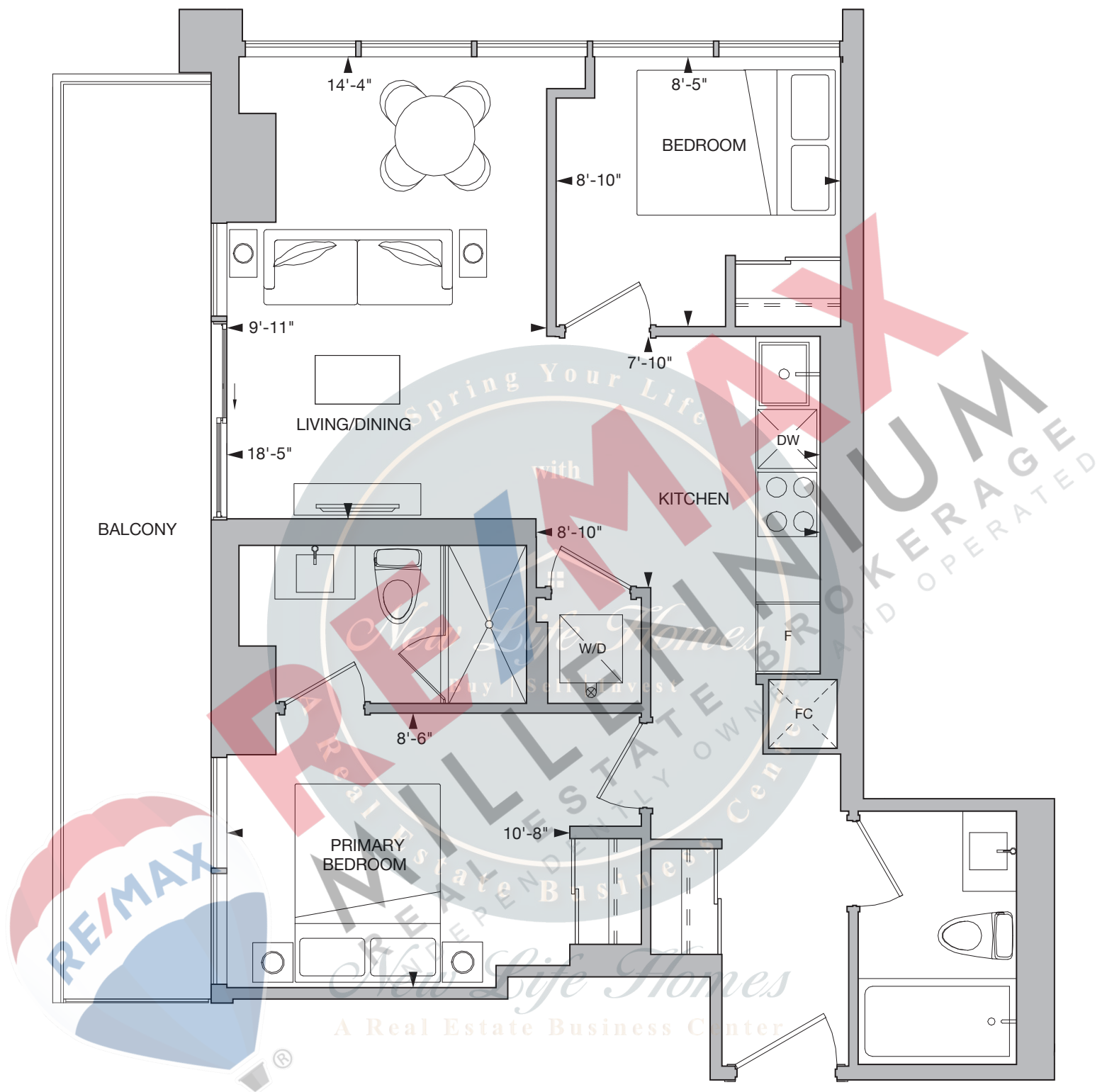

FLOORS

9, 11-19, 21-29, 31-39, 41, 42



FLOORS

10, 20, 30, 40



FLOOR 43

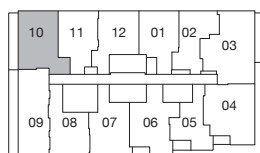

All drawings, illustrations, renderings, and views from (or of) proposed buildings shown on any brochures, advertisements, scale models, and/or marketing materials are conceptual artist's renderings only and the vendor makes no representation or warranty relating to same. Any stated areas and/or dimensions shown are approximate only and subject to normal construction variances. Actual usable floor space may vary from any stated or depicted floor area and the unit shall be measured in accordance with the provisions set out in HCTA Directive - Floor Area Calculations. Any and all measurements and/or specifications are subject to change without notice. Without limiting the foregoing, the purchaser is advised that the design, finishes, and specifications of the unit pursuant to the unit may vary from the design and/or finishes shown on the marketing drawing, depending on the location of the unit being purchased within the key plan and the building, and the purchaser expressly acknowledges and consents to such variation. The layout of the suite may be reversed depending on the location of the unit within the project. Any furniture depicted is for illustration purposes only and does not necessarily reflect the fixtures, finishes, appliances, and/or electrical plan of the unit and is not included in the purchase price. The view from or through the windows to the exterior may be partially obstructed by materials affixed to the exterior cladding of the building as part of an overall design element and/or interior structural columns that may be required pursuant to the recommendations of the project's engineers. Ceiling heights are subject to bulkheads, exposed ducts, dropped ceilings and structural beams, as applicable pursuant to the plans. All features and finishes are subject to change without notice. E.&O.E. November 2023.

Call us: 647-215-2315 | Email: Business@newlifelhomes.ca

NICE

2 BEDROOMS, 2 BATHROOMS

SOUTHWEST FACING

INTERIOR 725 SQ.FT. | EXTERIOR 218 SQ.FT.

TOTAL 943 SQ.FT.

ALLURE

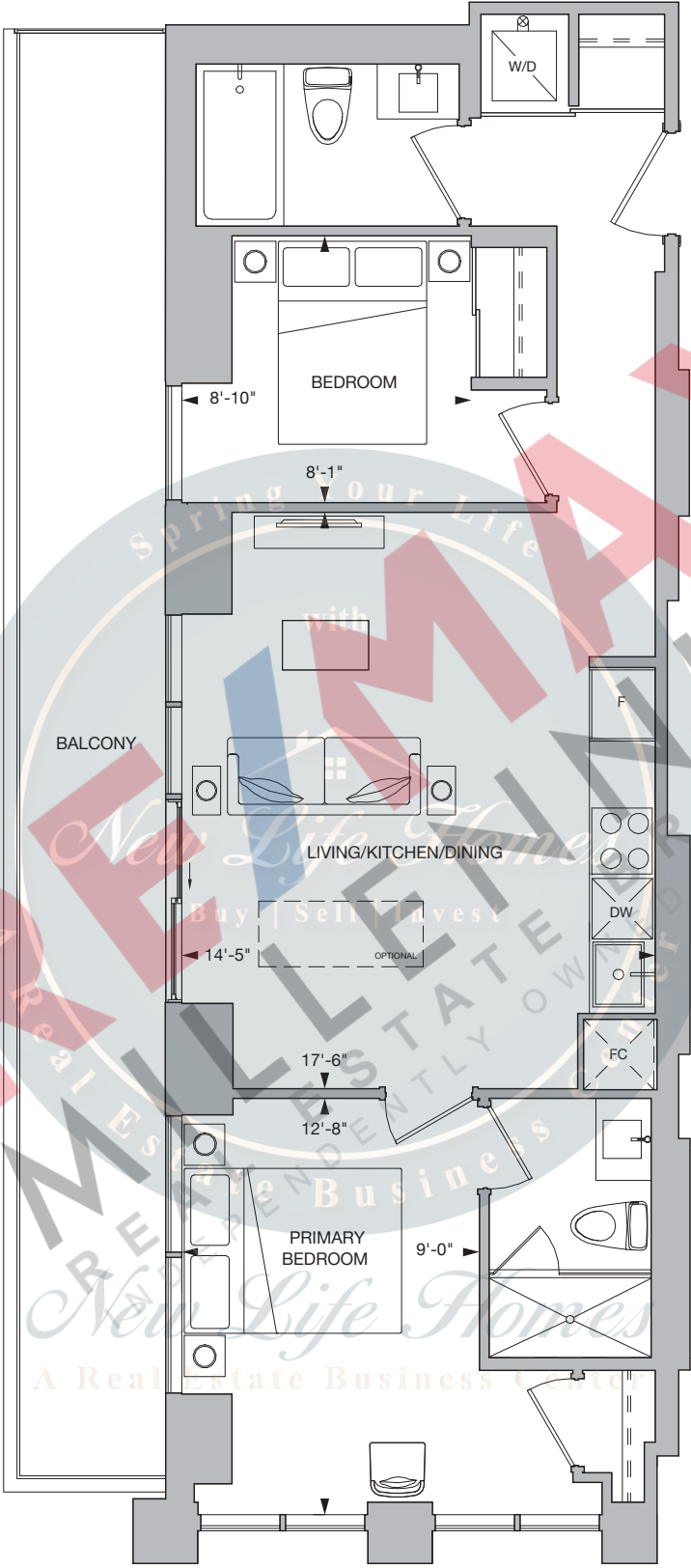

FLOORS

9, 11-19, 21-29, 31-39, 41, 42



FLOORS

10, 20, 30, 40



FLOOR 43



All drawings, illustrations, renderings, and views from (or of) proposed buildings shown on any brochures, advertisements, scale models, and/or marketing materials are conceptual artist's renderings only and the vendor makes no representation or warranty relating to same. Any stated areas and/or dimensions shown are approximate only and subject to normal construction variances. Actual usable floor space may vary from any stated or depicted floor area and the unit shall be measured in accordance with the provisions set out in HCRA Directive - Floor Area Calculations. Any and all measurements and/or specifications are subject to change without notice. Without limiting the foregoing, the purchaser is advised that the design, finishes, and specifications of the balcony appurtenant to the unit may vary from the design and/or finishes shown on the marketing drawing, depending on the location of the unit being purchased within the key plan and the building, and the purchaser expressly acknowledges and consents to such variation. The layout of the suite may be reversed depending on the location of the unit within the project. Any furniture depicted is for illustration purposes only and does not necessarily reflect the fixtures, finishes, appliances, and/or electrical plan of the unit and is not included in the purchase price. The view from or through the windows to the exterior may be partially obstructed by materials affixed to the exterior cladding of the building as part of an overall design element and/or interior structural columns that may be required pursuant to the recommendations of the project's engineers. Ceiling heights are subject to bulkheads, exposed ducts, dropped ceilings and structural beams, as applicable pursuant to the plans. All features and finishes are subject to change without notice. E.&O.E. November 2023.

B O S T O N

3 B E D R O O M S , 2 B A T H R O O M S

N O R T H E A S T F A C I N G

I N T E R I O R 8 4 1 S Q . F T . | E X T E R I O R 1 2 3 S Q . F T .

T O T A L 9 6 4 S Q . F T .

A L L U R E

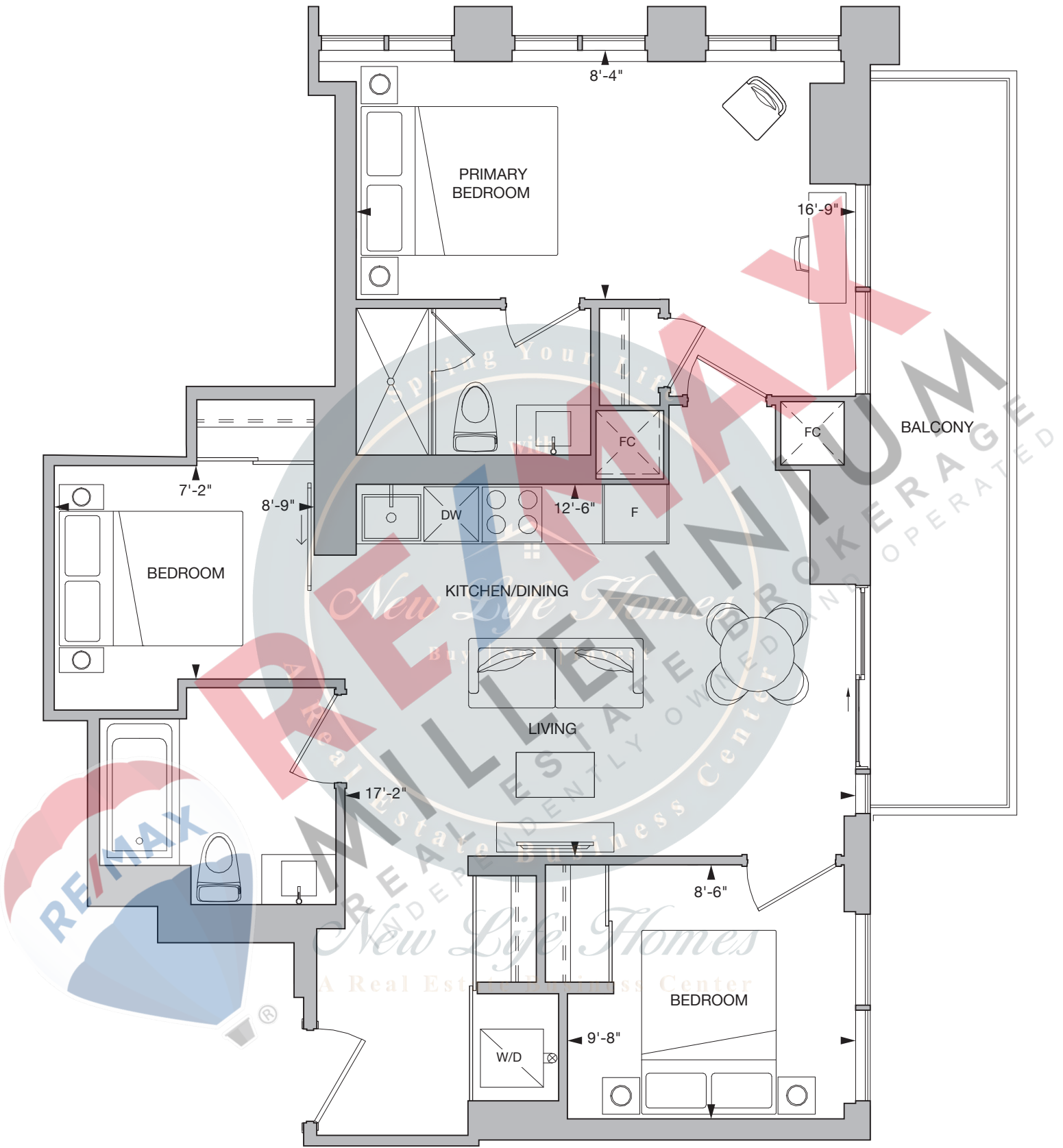

FLOOR 10

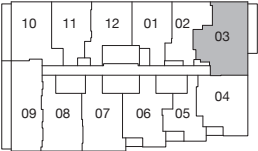

All drawings, illustrations, renderings, and views from (or of) proposed buildings shown on any brochures, advertisements, scale models, and/or marketing materials are conceptual artist's renderings only and the vendor makes no representation or warranty relating to same. Any stated areas and/or dimensions shown are approximate only and subject to normal construction variances. Actual usable floor space may vary from any stated or depicted floor area and the unit shall be measured in accordance with the provisions set out in HCRA Directive - Floor Area Calculations. Any and all measurements and/or specifications are subject to change without notice. Without limiting the foregoing, the purchaser is advised that the design, finishes, and specifications of the balcony appurtenant to the unit may vary from the design and/or finishes shown on the marketing drawing, depending on the location of the unit being purchased within the key plan and the building, and the purchaser expressly acknowledges and consents to such variation. The layout of the suite may be reversed depending on the location of the unit within the project. Any furniture depicted is for illustration purposes only and does not necessarily reflect the fixtures, finishes, appliances, and/or electrical plan of the unit and is not included in the purchase price. The view from or through the windows to the exterior may be partially obstructed by materials affixed to the exterior cladding of the building as part of an overall design element and/or interior structural columns that may be required pursuant to the recommendations of the project's engineers. Ceiling heights are subject to bulkheads, exposed ducts, dropped ceilings and structural beams, as applicable pursuant to the plans. All features and finishes are subject to change without notice. E.&O.E. November 2023.

BUCHAREST

3 BEDROOMS, 2 BATHROOMS

NORTHEAST FACING

INTERIOR 841 SQ.FT. | EXTERIOR 123 SQ.FT.

TOTAL 964 SQ.FT.

ALLURE

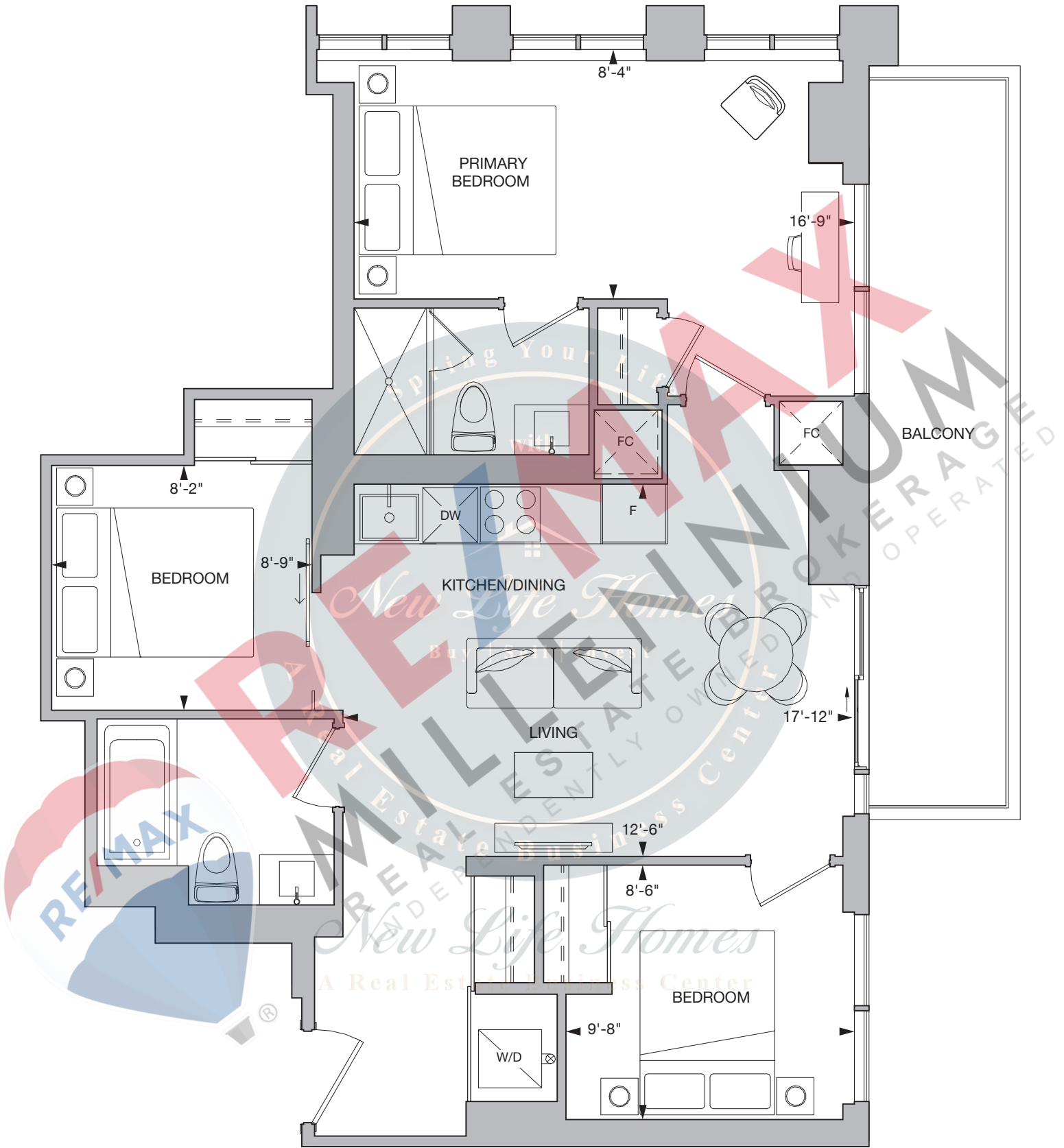

FLOORS 20, 30, 40



All drawings, illustrations, renderings, and views from (or of) proposed buildings shown on any brochures, advertisements, scale models, and/or marketing materials are conceptual artist's renderings only and the vendor makes no representation or warranty relating to same. Any stated areas and/or dimensions shown are approximate only and subject to normal construction variances. Actual usable floor space may vary from any stated or depicted floor area and the unit shall be measured in accordance with the provisions set out in HCRA Directive - Floor Area Calculations. Any and all measurements and/or specifications are subject to change without notice. Without limiting the foregoing, the purchaser is advised that the design, finishes, and specifications of the balcony appurtenant to the unit may vary from the design and/or finishes shown on the marketing drawing, depending on the location of the unit being purchased within the key plan and the building, and the purchaser expressly acknowledges and consents to such variation. The layout of the suite may be reversed depending on the location of the unit within the project. Any furniture depicted is for illustration purposes only and does not necessarily reflect the fixtures, finishes, appliances, and/or electrical plan of the unit and is not included in the purchase price. The view from or through the windows to the exterior may be partially obstructed by materials affixed to the exterior cladding of the building as part of an overall design element and/or interior structural columns that may be required pursuant to the recommendations of the project's engineers. Ceiling heights are subject to bulkheads, exposed ducts, dropped ceilings and structural beams, as applicable pursuant to the plans. All features and finishes are subject to change without notice. E.&O.E. November 2023.

B U D A P E S T

3 B E D R O O M S , 2 B A T H R O O M S

N O R T H E A S T F A C I N G

I N T E R I O R 8 4 6 S Q . F T . | E X T E R I O R 1 2 3 S Q . F T .

T O T A L 9 6 9 S Q . F T .

A L L U R E

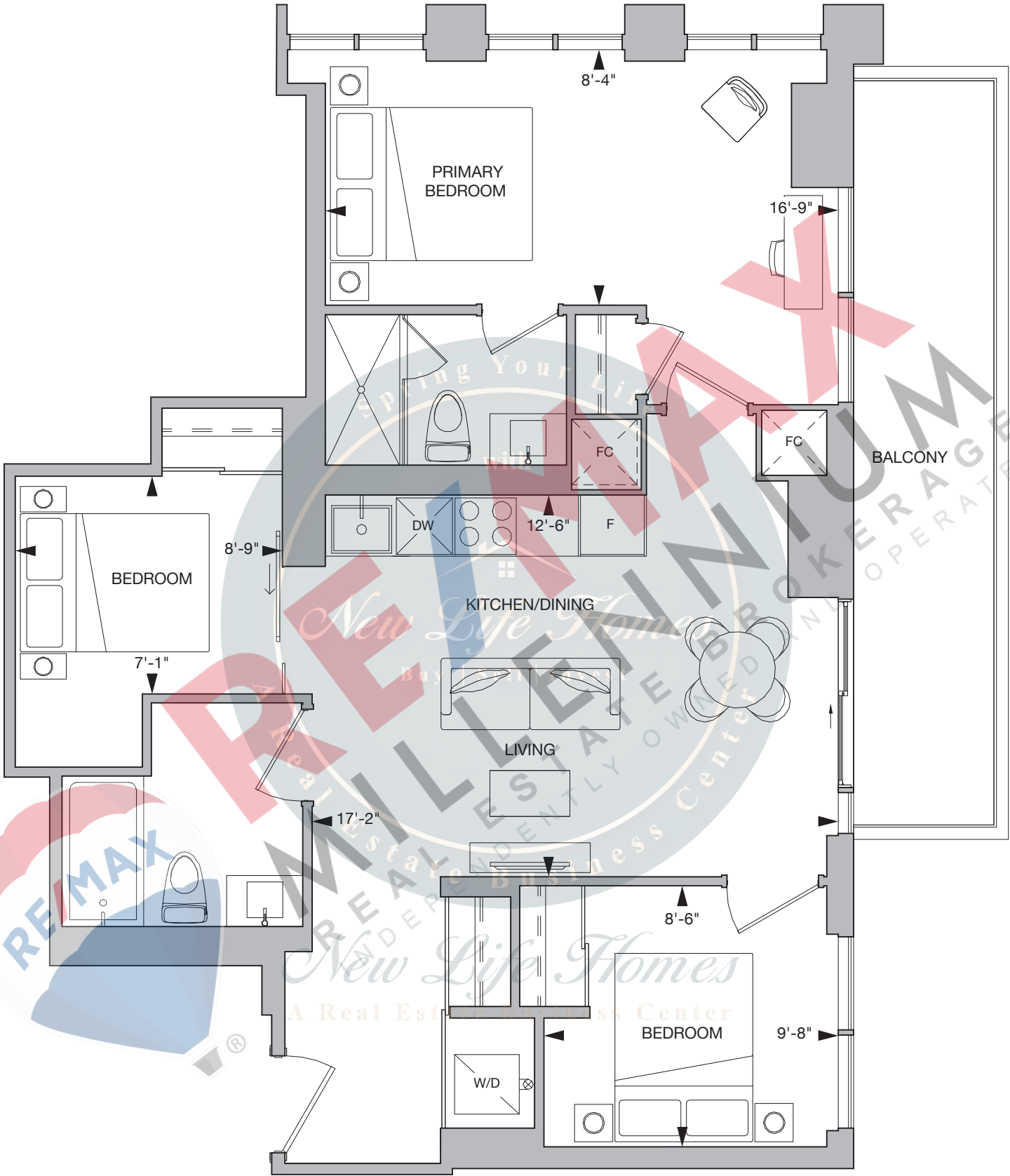

FLOOR 7

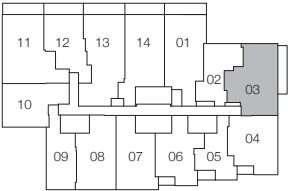

FLOOR 8

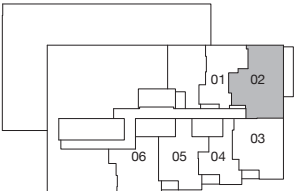

FLOOR 9



All drawings, illustrations, renderings, and views from (or of) proposed buildings shown on any brochures, advertisements, scale models, and/or marketing materials are conceptual artist's renderings only and the vendor makes no representation or warranty relating to same. Any stated areas and/or dimensions shown are approximate only and subject to normal construction variances. Actual usable floor space may vary from any stated or depicted floor area and the unit shall be measured in accordance with the provisions set out in HCRA Directive - Floor Area Calculations. Any and all measurements and/or specifications are subject to change without notice. Without limiting the foregoing, the purchaser is advised that the design, finishes, and specifications of the balcony appurtenant to the unit may vary from the design and/or finishes shown on the marketing drawing, depending on the location of the unit being purchased within the key plan and the building, and the purchaser expressly acknowledges and consents to such variation. The layout of the suite may be reversed depending on the location of the unit within the project. Any furniture depicted is for illustration purposes only and does not necessarily reflect the fixtures, finishes, appliances, and/or electrical plan of the unit and is not included in the purchase price. The view from or through the windows to the exterior may be partially obstructed by materials affixed to the exterior cladding of the building as part of an overall design element and/or interior structural columns that may be required pursuant to the recommendations of the project's engineers. Ceiling heights are subject to bulkheads, exposed ducts, dropped ceilings and structural beams, as applicable pursuant to the plans. All features and finishes are subject to change without notice. E.&O.E. November 2023.

CHICAGO

3 BEDROOMS, 2 BATHROOMS

NORTHEAST FACING

INTERIOR 846 SQ.FT. | EXTERIOR 123 SQ.FT.

TOTAL 969 SQ.FT.

ALLURE

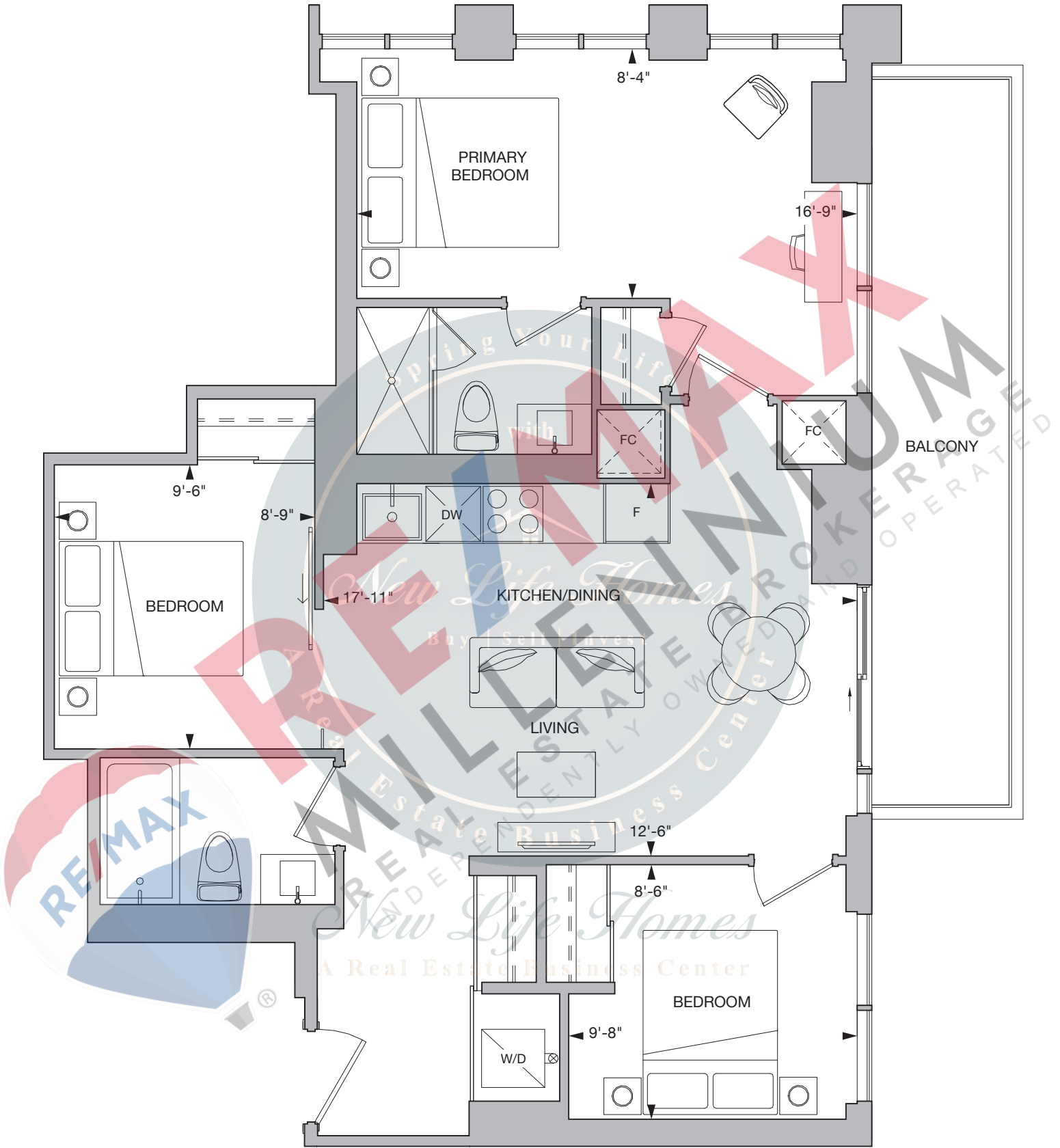

FLOORS

11-19, 21-29, 31-39, 41, 42

FLOOR 43



All drawings, illustrations, renderings, and views from (or of) proposed buildings shown on any brochures, advertisements, scale models, and/or marketing materials are conceptual artist's renderings only and the vendor makes no representation or warranty relating to same. Any stated areas and/or dimensions shown are approximate only and subject to normal construction variances. Actual usable floor space may vary from any stated or depicted floor area and the unit shall be measured in accordance with the provisions set out in HCRA Directive - Floor Area Calculations. Any and all measurements and/or specifications are subject to change without notice. Without limiting the foregoing, the purchaser is advised that the design, finishes, and specifications of the balcony appurtenant to the unit may vary from the design and/or finishes shown on the marketing drawing, depending on the location of the unit being purchased within the key plan and the building, and the purchaser expressly acknowledges and consents to such variation. The layout of the suite may be reversed depending on the location of the unit within the project. Any furniture depicted is for illustration purposes only and does not necessarily reflect the fixtures, finishes, appliances, and/or electrical plan of the unit and is not included in the purchase price. The view from or through the windows to the exterior may be partially obstructed by materials affixed to the exterior cladding of the building as part of an overall design element and/or interior structural columns that may be required pursuant to the recommendations of the project's engineers. Ceiling heights are subject to bulkheads, exposed ducts, dropped ceilings and structural beams, as applicable pursuant to the plans. All features and finishes are subject to change without notice. E.&O.E. November 2023.